

TORO®

Low-Pressure Tap Timer Model 53453 • Installation Instructions

This newly designed battery-powered tap timer is easy to program with simple dial settings. The ball valve mechanism provides reliable and consistent performance for home, garden hose and drip irrigation systems.

Key Features

- Connects to 3/4" hose bib or Y ball valve
- Inlet: 3/4" FHT (female hose thread)
- Outlet: 3/4" MHT (male hose thread)
- Powered by two AA alkaline batteries (not included)
- 11 frequency and duration settings provide customized combinations
- Both programmed and manual watering options are available
- Durable and consistent watering control utilizing ball valve design
- Low battery indicator
- Time delay function up to 12 hours per day
- Max. & Min. Operating Pressure: 125/5 PSI

Safety Guidelines

- This timer is designed for residential outdoor watering use only.
- Detach the timer from the faucet tap at the end of the watering season.
- Do not use with water exceeding 100°F (38°C) or with pressure exceeding 125 PSI.
- Drain all water and remove batteries before storage.

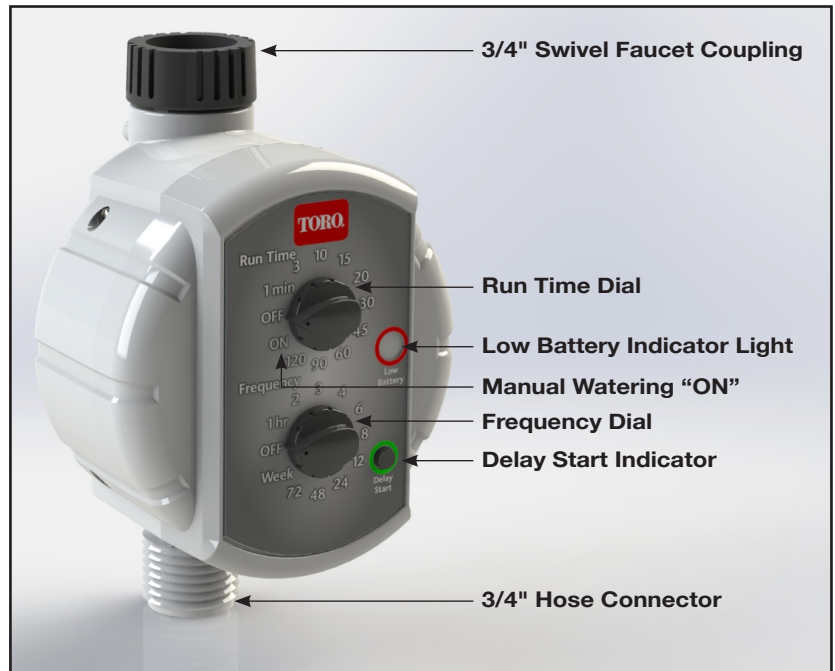

Installation

1. Hold the controller with the battery compartment facing you (**Figure 1**).
2. Unscrew the battery cover and insert two AA alkaline batteries. Replace the cover and fasten the screws. Ensure that the battery compartment stays dry while installing the batteries.
3. Before attaching the timer onto the outdoor faucet, manually check the timer operation by turning the "Run Time" knob to the "ON" position. The indicator light will flash once in "green". This indicates that the batteries have been installed correctly and the timer is ready for use. If the battery power is low, the indicator will continuously flash in "red" until the power runs out.
4. Proceed with programming the timer prior to connecting to the tap (see "Set Watering Run Time" and "Set Watering Frequency").
5. Once the timer has been programmed, hold the unit steady and hand-tighten the collar onto the faucet/tap until it is secured. Be sure all connections are secure before turning on the water. Do not use a wrench or pliers, and avoid over-tightening. Turn on the faucet/tap and the timer is ready to use.

Figure 1

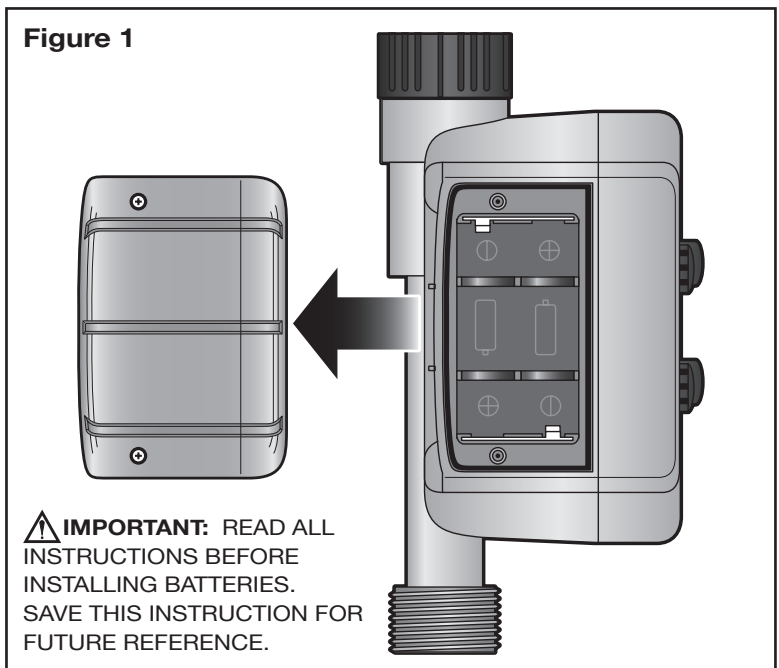

Set Watering Frequency

Turn the knob to the desired frequency. It will begin after the frequency has been set for 2 seconds. When the knob is turned to the new setting for 2 seconds, the frequency resets to the new one. There are 11 frequency options:

- (1) By hour(s): 1, 2, 3, 4, 6, 8, 12, 24, 48, or 72 hours
- (2) By week: Weekly (1-start per week)

***Frequency setting must be longer than duration setting.**

Set Watering Run Time

Turn the knob to the desired run time. Watering will be controlled by the frequency and run time settings, then it will close automatically. The run time dial has 10 options:

- (1) OFF: the valve will always be close when the knob is in this setting.
- (2) ON: the valve will always be open when the knob is in this setting.
- (3) By min(s): 1, 3, 10, 15, 20, 30, 45, 60, 90, or 120 minutes
- (4) Manual watering: To manually open the valve, turn the knob to "ON". Water will continuously flow until the knob is turned to "OFF" (always closed) or other desired setting.

Start Time Delay Function

You can easily delay the start time of the current watering program by pushing the "Delay Start" button. After the watering program is set, push the "Delay Start" button until the indicator is "red". Once the red indicator appears, push the button once for each hour you want to delay the start, up to 12 hours max. Every time the button is pushed, the indicator will flash in "green" and delay the start by one hour. For example, if you want to delay the program for 5 hours, push the button 5 times (the indicator will flash in green 5 times as well). Once the red indicator is off, the start time setting is complete.

***Be sure to complete the programming process within ONE minute.**

***Every time the "Delay Start" button is pushed and the indicator turns red, the start time program has been reset.**

TROUBLESHOOTING

No watering operation	<ul style="list-style-type: none">• Make sure the faucet tap is turned on (open position)• Check "Run Time" knob is not at the "OFF" position• Check the condition of the battery power
No manual operation	<ul style="list-style-type: none">• Check "Run Time" knob is at the "ON" position• Check the condition of the battery power
Faucet or hose is leaking	<ul style="list-style-type: none">• Check if the washer in the swivel coupling is included or missing• Tighten the hose swivel couplings
Low Battery Power	<ul style="list-style-type: none">• Check if the low battery indicator is red• If red indicator is lit, change the batteries and reset the program

⚠ Warning: Do not use a wrench to tighten the swivel faucet coupling. It might cause damage to the swivel coupling of the timer.