

TORO®

TORO®

**PROCORE®
648s**

2025-2026 TORO® TITAN® TINES CATALOG



**Aerate with less mess
and get back to play faster.**

Whether you're coring to remove thatch or solid-tining to reduce surface disruption, TITAN® tines are engineered to improve playability and speed up recovery. With over 150 options, TITAN tines last up to 4x longer than standard tines — so you can keep pace with the demands of your turf and your players.

Always *solving*. Always *evolving*.



TABLE OF CONTENTS

INTRODUCTION	1-2
SELECTION & MEASUREMENT GUIDE	3
TINE HEAD IDENTIFICATION GUIDE	4
AERATION EVALUATION GUIDE	5-8
PROCORE® 648/648s/864/1298	9-13
TURF AERATOR 686/687	14
PROCORE SR SERIES	15-23
TITAN TINES FOR COMPETITIVE MODELS	24-28
QUICK REFERENCE	31-34



EXACT STANDARDS



AERATION IMPROVES TURF CONDITIONS

Aeration keeps your turf looking great. It's important to aerate often, especially when it comes to high traffic areas, and with TITAN® TINES on your team you'll know you have the best equipment to meet all of your aeration needs successfully.

TORO'S FAMILY OF TINES ARE DESIGNED TO MEET YOUR EXACT AERATION NEED

TINE	TIP	LONGEVITY	APPLICATION	WALL THICKNESS
Toro Classic	Standard durable heat treated tip	Good	Good quality in most turf conditions	Thin wall delivers durability and exceptional performance
TITAN	Sharp heat treated tip for improved hole quality and life	Better	Provides superior performance and long lasting wear in most turf conditions	Thin wall delivers durability and exceptional performance
TITAN Max	Sharp carbide tip for excellent hole quality and life	Best	Provides superior performance and long lasting wear in most conditions	Thin wall delivers durability and exceptional performance
TITAN Fairway	Standard heat treated fairway tip for consistent core removal	Better	Provides quality performance in natural soil conditions	Thicker wall provides good hole quality and maximum strength
TITAN HD Fairway	Enhanced hardened tip for 75% longer life than TITAN Fairway	Best	Provides excellent performance and wear in extreme conditions	Thicker wall provides good hole quality and maximum strength

A TINE TO FIT EVERY APPLICATION

Toro® has about every possible tine you can imagine for the changing seasons and your most demanding turf conditions. TITAN® Tines offer superior quality to provide your grounds the best possible care.

Jump-start your productivity with the TITAN QuickChange™ tine head. The patent-pending taper-lock design makes changing tines a snap. In fact, many users have reduced set-up time by up to 75%. TITAN QuickChange will help you get your aeration done FAST!



TORO TITAN TINES OFFER

- Over 150 tines, providing multiple aeration choices
- A wide variety of types meeting your exact aeration requirements
- Higher Productivity: TITAN Max designed with long lasting tungsten carbide blend tip
- Better Performance: TITAN tines last approximately 3-4 times longer than standard tines
- An optimized core, removing more thatch for maximum topdressing
- A superior hole, improving recovery time and maintaining playability

CORING TINES

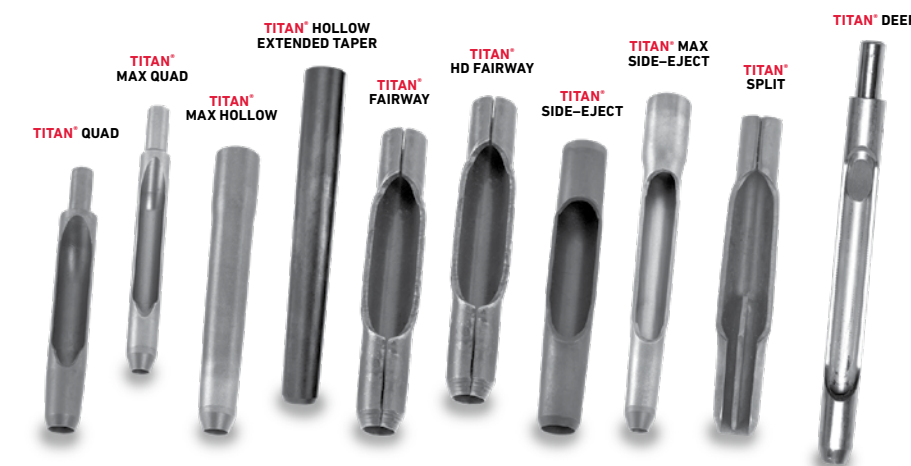

SOLID TINES

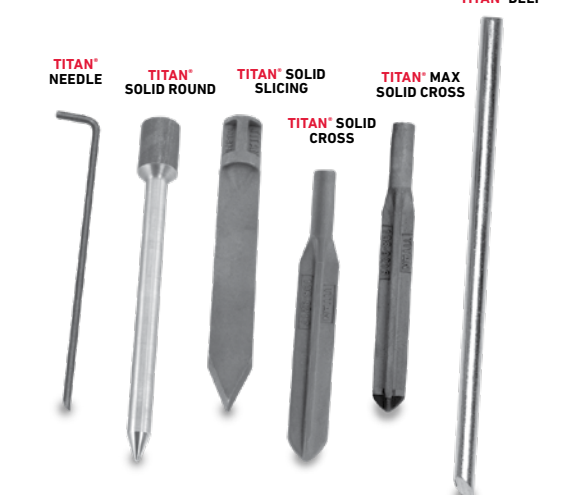

SELECTION & MEASUREMENT

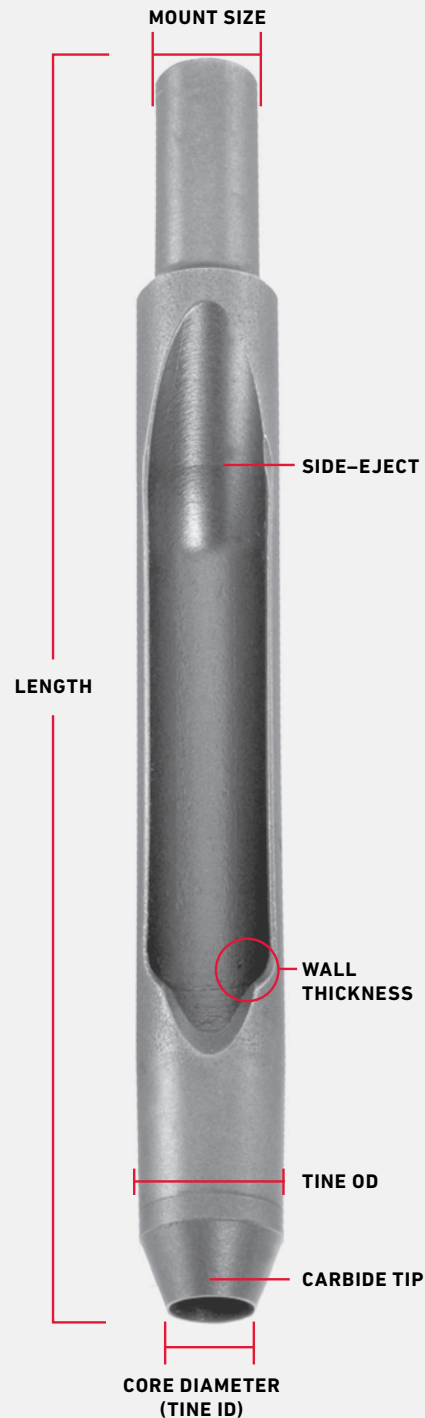

STANDARD SIZES

1/4 in (6.3 mm)	
3/8 in (9.5 mm)	
1/2 in (12.7 mm)	
5/8 in (15.9 mm)	
3/4 in (19 mm)	
7/8 in (22.2 mm)	

TITAN™ TINES fit all current and late model Toro® aerators. Standard mount size fits most competitor equipment. Check mounting size to ensure compatibility. Prices subject to change without notice.

PROCORE 648/648s/864/1298 (See pages 9–18)

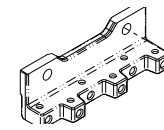

QUAD TINE HEAD (1x6)

Tine Mount	3/8" (9.5 mm)
Qty. of Tines	6

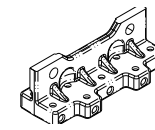

QUAD TINE HEAD (2x5)

Tine Mount	3/8" (9.5 mm)
Qty. of Tines	10

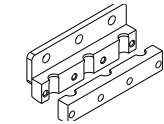

3/4" 3-TINE HEAD

Tine Mount	3/4" (19 mm)
Qty. of Tines	3

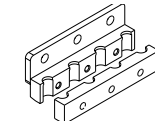

3/4" 4-TINE HEAD

Tine Mount	3/4" (19 mm)
Qty. of Tines	4

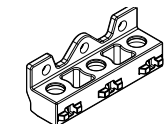

QUICKCHANGE 3-TINE HEAD

Tine Mount	3/4" (19 mm) or 7/8" (22.2 mm)
Qty. of Tines	3

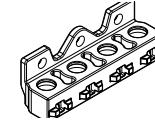

QUICKCHANGE 4-TINE HEAD

Tine Mount	3/4" (19 mm) or 7/8" (22.2 mm)
Qty. of Tines	4

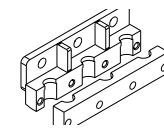

7/8" 3-TINE HD HEAD

Tine Mount	7/8" (22.2 mm)
Qty. of Tines	3

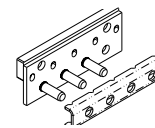

NEEDLE TINE HEAD

Tine Mount	Needle
Qty. of Tines	5

PROCORE 440/660/880 (See pages 19–22)

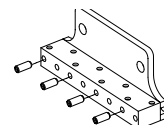

QUAD TINE HEAD (1x6)

Tine Mount	3/8" (9.5 mm)
Qty. of Tines	8

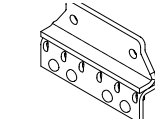

NEEDLE TINE HEAD

Tine Mount	Needle
Qty. of Tines	6

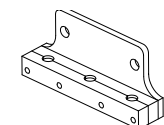

3/4" 3-TINE HEAD

Tine Mount	3/4" (19 mm)
Qty. of Tines	3

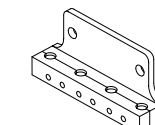

3/4" 4-TINE HEAD

Tine Mount	3/4" (19 mm)
Qty. of Tines	4

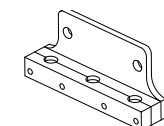

7/8" 3-TINE HEAD

Tine Mount	7/8" (22.2 mm)
Qty. of Tines	3

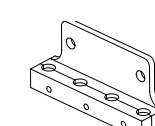

7/8" 4-TINE HEAD

Tine Mount	7/8" (22.2 mm)
Qty. of Tines	4

PROCORE SR SERIES (See pages 31–39)

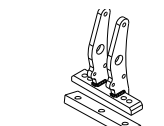

SR54-S / SR70-S

Tine Mount	5/16" (7.9 mm) or 12.0 mm
Qty. of Tines	3 or 4

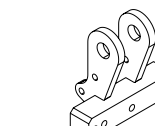

SR54 / SR70

Tine Mount	5/16" (7.9 mm) or 12.0 mm
Qty. of Tines	2 or 3

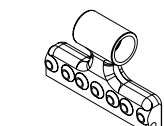

SR48 / SR72

Tine Mount	5/16" (7.9 mm) or 12.0 mm
Qty. of Tines	3 or 4

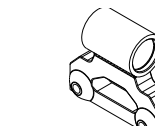

SR75

Tine Mount	5/16" (7.9 mm) or 12.0 mm
Qty. of Tines	2 or 3



TINE SELECTION CHART:

- Speed and ease of use
- Selection of proper turf guard based on aerator and tine configuration needs.
- Quickly identify the amount of soil removed and the percentage of surface area affected.

AERATION EVALUATION GUIDE WITH TINE SELECTION CHART

When you're looking to keep your golf course and grounds in top shape, you need a system that helps you quickly choose the right treatment for your turf needs.

Aeration is the key and the tine selection chart offers you fast answers that convey exactly what you need to do to keep your turf looking great.

The tine selection guide makes it easy to choose and understand the right solution for your golf course and ground needs!



Preparing for Step One: Find Your Model Number

MODEL CONFIGURATION					
Product	Description No.	No.	Lateral Spacing Options	Forward Spacing Options	
ProCore 648/648s Model 09960	Needle Tine Head	09739	1.60" (4,1 cm)	09960 has hole spacing in .25" increments from 1" – 4.5" 1.5, 2, 2.5" (3,8; 5,1; 6,4 cm) 2.5" (6,4 cm) 1.5, 2, 2.5, 3" (3,8; 5,1; 6,4; 7,6 cm) 1.5, 2, 2.5, 3" (3,8; 5,1; 6,4; 7,6 cm) 1.5, 2, 2.5, 3" (3,8; 5,1; 6,4; 7,6 cm) 1.5, 2, 2.5, 3" (3,8; 5,1; 6,4; 7,6 cm) 1.5, 2, 2.5, 3" (3,8; 5,1; 6,4; 7,6 cm)	
	Quad Tine Head, 2 rows of 5	09736	1.60" (4,1 cm)		
	Quad Tine Head, 1 rows of 6	09737	1.30" (3,3 cm)		
	3 Tine, 3/4 in (19 mm) Mount Head	09794	2.60" (6,6 cm)		
	4 Tine, 3/4 in (19 mm) Mount Head	09796	2.0" (5,1 cm)		
	3 Tine HD, 7/8 in (22,2 mm) Mount Head	09797	2.60" (6,6 cm)		
	4 Tine Titan QuickChange	09719	2.0" (5,1 cm)		
	3 Tine Titan QuickChange	09711	2.60" (6,6 cm)		
	ProCore 440/660/880 Models 09701, 09702	Needle Tine Head 660/880	09720		1.20" (3,0 cm)
		Needle Tine Head 660/880	09720		1.20" (3,0 cm)
Quad Tine Head		09721	1.20" (3,0 cm)		
3 Tine, 3/4" (19,0 mm) Mount Head		09722	3.20" (8,1 cm)		
4 Tine, 3/4" (19,0 mm) Mount Head		09723	2.40" (6,1 cm)		
3 Tine, 7/8" (22,2 mm) Mount Head		09733	3.20" (8,1 cm)		
4 Tine, 7/8" (22,2 mm) Mount Head		09734	2.40" (6,1 cm)		
Toro Greens Aerator Models 09110, 09120		3/4" (19,0 mm) Head	59-2500	2.25" (5,7 cm)	2.5" (6,4 cm)
	7/8" (22,2 mm) Head	62-4610			
	Needle Head	94-3421			
Toro Fairway Aerator Models 09500, 09501, 09502	—	—	3.5" (8,9 cm) 5.25" (13,3 cm)	3.0, 6.0" (7,6; 15,2 cm) 3.0, 6.0" (7,6; 15,2 cm)	

* Tine depth can vary based on machine set-up.

DETERMINE THE TOTAL SURFACE AREA AFFECTED & AMOUNT OF MATERIAL REMOVED

STEP ONE FIND HOLES PER SQUARE METRE

If you know your lateral and forward spacing — See the Holes Per Square Metre table.

If you are not sure of your forward and lateral spacing, but know your aerator model number use the Preparing for Step One chart on the previous page and pick your spacing options. This table will also help you determine the proper turf holder based on your tine configuration.

ALL MODELS	FORWARD SPACING IN INCHES (CENTIMETERS)								
	1 (2.5)	1.5 (3.8)	2 (5.1)	2.5 (6.4)	3 (7.6)	3.5 (8.9)	4 (10.2)	4.5 (11.4)	6 (15.2)
LATERAL SPACING	HOLES PER SQUARE METRE								
1.2 (3.0)	120 (1333.3)	80 (877.2)	60 (653.6)	48 (520.8)	40 (438.6)	34.3 (374.5)	30 (326.8)	26.7 (292.4)	-
1.33 (3.3)	-	72 (797.4)	54 (594.2)	43.3 (473.5)	36 (398.7)	-	-	-	-
1.6 (4.1)	-	-	-	72 (381.1)	-	-	-	-	-
2 (5.1)	72 (784.3)	48 (516.0)	36 (384.5)	28.8 (306.4)	24 (258.0)	-	-	-	-
2.25 (5.7)	-	-	-	25.6 (274.1)	-	-	-	-	-
2.4 (6.1)	60 (655.7)	40 (431.4)	30 (321.4)	24 (256.1)	20 (215.7)	17.1 (184.2)	15 (160.7)	13.3 (143.8)	-
2.5 (6.4)	57.6 (625.0)	38.4 (411.2)	28.8 (306.4)	23 (244.1)	19.2 (205.6)	-	-	-	-
3.2 (8.1)	45 (493.8)	30 (324.9)	22.5 (242.1)	18 (192.9)	15 (162.4)	12.9 (138.7)	11.3 (121.0)	10 (108.3)	-
3.5 (8.9)	-	-	-	-	-	13.7 (147.8)	-	-	-
5.25 (13.3)	-	-	-	-	-	-	-	-	4.6 (49.5)

Step One Example:

- Lateral Spacing = 2" (5,1 cm)
- Forward Spacing = 2" (5,1 cm)
- Holes Per Square Feet = 36" (384,5 cm)

STEP TWO DETERMINE THE TOTAL SURFACE AREA AFFECTED AND VOLUME OF SOIL REMOVED

To determine the total surface area affected and volume of soil removed when aerating, reference the **Percent Surface Area Affected/Volume Removed** table. All you need to know is holes per square metre, core diameter (ID), and the depth* at which you are aerating.

Step Two Example:

- Holes Per Square Feet = 36" (232,3 cm)
- Core Diameter = .300" (0,8 cm)
- Depth = 3.0" (7,6 cm)
- Percent Surface Area Affected = 1.77%
- Volume Removed = 4.42 cu-feet per 1,000 sq/ft (0,133 cubic metres per 100 square metres)

- Volume Removed, Cubic Foot Per 1000 Sq. Ft. (Cubic Metres Per 100 Square Metre)
- Risk Of Turf Damage
- Higher Risk Of Turf Damage
- Percent Of Surface Area Affected

Percent Of Surface Area Affected And Amount Of Volume Removed

Core Diameter Depth*	Holes Per Square Foot (Metre) in Inches (Centimeters)																															
	4.6 (49.5)	10 (108.3)	11.3 (121.0)	12.9 (138.7)	13.3 (143.8)	13.7 (147.8)	15 (162.4)	17.1 (184.2)	18 (192.9)	19.2 (205.6)	20 (215.7)	22.5 (242.1)	23 (244.1)	24 (256.1)	25.6 (274.1)	26.7 (292.4)	28.8 (306.4)	30 (321.4)	34.3 (374.5)	36 (384.5)	38.4 (411.2)	40 (431.4)	43.3 (473.5)	45 (493.8)	48 (516.0)	54.1 (594.2)	57.6 (625.0)	60 (655.7)	72 (784.3)	80 (877.2)	120 (1333.3)	
2 (0.5)	0.10%	0.22%	0.25%	0.28%	0.29%	0.30%	0.33%	0.37%	0.39%	0.42%	0.44%	0.49%	0.50%	0.52%	0.56%	0.63%	0.65%	0.75%	0.79%	0.84%	0.87%	0.94%	0.98%	1.05%	1.18%	1.26%	1.31%	1.57%	1.75%	2.62%		
1.5 (3.8)	.12 (0.004)	.27 (0.008)	.31 (0.009)	.35 (0.011)	.36 (0.011)	.37 (0.011)	.41 (0.013)	.47 (0.014)	.49 (0.015)	.52 (0.016)	.55 (0.017)	.61 (0.019)	.63 (0.019)	.65 (0.020)	.7 (0.021)	.73 (0.022)	.79 (0.024)	.82 (0.025)	.93 (0.029)	.98 (0.030)	1.05 (0.032)	1.09 (0.033)	1.18 (0.036)	1.23 (0.038)	1.26 (0.038)	1.48 (0.046)	1.57 (0.048)	1.64 (0.051)	1.96 (0.060)	2.18 (0.068)	3.27 (0.103)	
2 (5.1)	.17 (0.005)	.36 (0.011)	.41 (0.014)	.47 (0.014)	.48 (0.015)	.5 (0.015)	.55 (0.017)	.62 (0.019)	.65 (0.020)	.7 (0.021)	.73 (0.022)	.82 (0.025)	.84 (0.025)	.87 (0.026)	.93 (0.028)	.97 (0.030)	1.05 (0.032)	1.09 (0.033)	1.25 (0.039)	1.31 (0.040)	1.36 (0.042)	1.56 (0.049)	1.64 (0.050)	1.75 (0.053)	1.82 (0.056)	1.97 (0.061)	2.05 (0.064)	3.05 (0.067)	2.48 (0.077)	2.62 (0.081)	2.73 (0.085)	3.27 (0.102)
2.5 (6.4)	.21 (0.006)	.45 (0.014)	.51 (0.013)	.58 (0.018)	.61 (0.019)	.62 (0.019)	.68 (0.021)	.78 (0.024)	.82 (0.025)	.87 (0.027)	.91 (0.028)	1.02 (0.031)	1.05 (0.032)	1.16 (0.036)	1.21 (0.038)	1.31 (0.040)	1.36 (0.042)	1.56 (0.049)	1.64 (0.050)	1.75 (0.053)	1.82 (0.056)	1.97 (0.061)	2.05 (0.064)	3.05 (0.067)	2.48 (0.077)	2.62 (0.081)	2.73 (0.085)	3.27 (0.102)	3.64 (0.114)	5.45 (0.173)		
3 (7.6)	.25 (0.008)	.55 (0.017)	.61 (0.015)	.7 (0.021)	.73 (0.022)	.75 (0.023)	.82 (0.025)	.93 (0.028)	.98 (0.030)	1.05 (0.032)	1.09 (0.033)	1.23 (0.037)	1.26 (0.038)	1.31 (0.039)	1.4 (0.042)	1.45 (0.045)	1.57 (0.047)	1.64 (0.050)	1.87 (0.058)	1.96 (0.059)	2.09 (0.063)	2.18 (0.066)	2.38 (0.073)	2.45 (0.076)	3.49 (0.079)	2.95 (0.092)	3.14 (0.096)	3.27 (0.101)	3.93 (0.121)	4.36 (0.135)	6.54 (0.205)	
3.5 (8.9)	.29 (0.009)	.64 (0.020)	.72 (0.022)	.82 (0.025)	.85 (0.026)	.87 (0.027)	.95 (0.029)	1.09 (0.033)	1.15 (0.035)	1.22 (0.037)	1.27 (0.039)	1.43 (0.044)	1.47 (0.044)	1.53 (0.046)	1.63 (0.049)	1.7 (0.053)	1.83 (0.055)	1.91 (0.058)	2.18 (0.068)	2.29 (0.069)	2.44 (0.074)	2.55 (0.078)	2.78 (0.085)	2.86 (0.089)	3.44 (0.107)	3.67 (0.113)	3.82 (0.118)	4.58 (0.141)	5.09 (0.158)	7.64 (0.241)		
4 (10.2)	.33 (0.010)	.73 (0.022)	.82 (0.029)	.93 (0.029)	.97 (0.030)	1 (0.031)	1.09 (0.034)	1.25 (0.038)	1.31 (0.040)	1.4 (0.043)	1.45 (0.045)	1.64 (0.050)	1.68 (0.050)	1.75 (0.053)	1.94 (0.060)	2.09 (0.063)	2.18 (0.066)	2.49 (0.077)	2.62 (0.079)	2.79 (0.085)	2.91 (0.089)	3.15 (0.098)	3.27 (0.102)	3.49 (0.107)	3.94 (0.123)	4.19 (0.129)	4.36 (0.136)	5.24 (0.162)	5.82 (0.181)	8.73 (0.276)		
3 (0.8)	0.22%	0.49%	0.55%	0.63%	0.65%	0.67%	0.74%	0.84%	0.88%	0.94%	0.98%	1.10%	1.13%	1.18%	1.26%	1.31%	1.41%	1.47%	1.68%	1.77%	1.88%	1.96%	2.13%	2.21%	2.36%	2.66%	2.83%	2.95%	3.53%	3.93%	5.89%	
1.5 (3.8)	.28 (0.009)	.61 (0.019)	.69 (0.021)	.79 (0.024)	.82 (0.025)	.84 (0.026)	.92 (0.028)	1.05 (0.032)	1.1 (0.033)	1.18 (0.036)	1.23 (0.037)	1.38 (0.042)	1.41 (0.042)	1.47 (0.044)	1.57 (0.048)	1.64 (0.051)	1.77 (0.053)	1.84 (0.056)	2.21 (0.065)	2.21 (0.067)	2.36 (0.071)	2.45 (0.075)	2.66 (0.082)	2.76 (0.086)	2.95 (0.089)	3.32 (0.103)	3.33 (0.103)	3.68 (0.114)	4.42 (0.136)	4.91 (0.152)	7.36 (0.231)	
2 (5.1)	.37 (0.012)	.82 (0.025)	.92 (0.028)	1.05 (0.032)	1.09 (0.033)	1.12 (0.034)	1.23 (0.038)	1.4 (0.043)	1.47 (0.045)	1.57 (0.048)	1.64 (0.050)	1.84 (0.056)	1.88 (0.057)	1.96 (0.060)	2.05 (0.063)	2.3 (0.071)	2.36 (0.071)	2.45 (0.075)	2.62 (0.080)	2.95 (0.089)	3.07 (0.094)	3.51 (0.109)	3.68 (0.112)	3.93 (0.120)	4.09 (0.126)	4.43 (0.138)	4.6 (0.144)	4.91 (0.151)	5.54 (0.173)	5.89 (0.182)	6.14 (0.191)	7.36 (0.229)
2.5 (6.4)	.47 (0.014)	1.02 (0.032)	1.15 (0.035)	1.31 (0.040)	1.36 (0.042)	1.4 (0.043)	1.53 (0.047)	1.75 (0.054)	1.84 (0.056)	1.96 (0.060)	2.05 (0.063)	2.3 (0.071)	2.36 (0.071)	2.45 (0.075)	2.62 (0.080)	2.95 (0.089)	3.07 (0.094)	3.51 (0.109)	3.68 (0.112)	3.93 (0.120)	4.09 (0.126)	4.43 (0.138)	4.6 (0.144)	4.91 (0.151)	5.54 (0.173)	5.89 (0.182)	6.14 (0.191)	7.36 (0.229)	8.18 (0.256)	12.27 (0.389)		
3 (7.6)	.56 (0.017)	1.23 (0.038)	1.38 (0.042)	1.58 (0.048)	1.64 (0.050)	1.68 (0.051)	1.84 (0.056)	2.1 (0.064)	2.21 (0.067)	2.36 (0.071)	2.45 (0.075)	2.76 (0.084)	2.83 (0.085)	2.95 (0.089)	3.14 (0.095)	3.27 (0.101)	3.53 (0.106)	3.68 (0.111)	4.21 (0.130)	4.42 (0.133)	4.71 (0.143)	4.91 (0.150)	5.31 (0.164)	5.52 (0.171)	5.89 (0.179)	6.64 (0.206)	7.07 (0.217)	7.36 (0.227)	8.84 (0.272)	9.82 (0.304)	14.73 (0.462)	
3.5 (8.9)	.65 (0.020)	1.43 (0.044)	1.61 (0.049)	1.84 (0.056)	1.91 (0.058)	1.96 (0.060)	2.15 (0.066)	2.45 (0.075)	2.58 (0.078)	2.75 (0.083)	2.86 (0.088)	3.22 (0.098)	3.3 (0.099)	3.44 (0.104)	3.67 (0.111)	3.82 (0.119)	4.12 (0.124)	4.3 (0.130)	4.91 (0.152)	5.15 (0.156)	5.5 (0.167)	5.73 (0.175)	6.2 (0.192)	6.44 (0.200)	6.87 (0.209)	7.75 (0.241)	8.25 (0.254)	8.59 (0.266)	10.31 (0.318)	11.45 (0.356)	17.18 (0.541)	
4 (10.2)	.75 (0.023)	1.64 (0.050)	1.84 (0.056)	2.1 (0.065)	2.18 (0.067)	2.24 (0.069)	2.45 (0.076)	2.8 (0.086)	2.95 (0.090)	3.14 (0.096)	3.27 (0.100)	3.68 (0.113)	3.77 (0.114)	3.93 (0.119)	4.19 (0.128)	4.36 (0.136)	4.71 (0.143)	4.91 (0.150)	5.61 (0.174)	5.89 (0.179)	6.28 (0.191)	6.54 (0.201)	7.09 (0.220)	7.36 (0.230)	7.85 (0.240)	8.86 (0.276)	9.42 (0.291)	9.82 (0.305)	11.78 (0.365)	13.09 (0.408)	19.63 (0.620)	
4 (1.0)	0.40%	0.87%	0.98%	1.12%	1.16%	1.20%	1.31%	1.50%	1.57%	1.68%	1.75%	1.96%	2.01%	2.09%	2.23%	2.33%	2.51%	2.62%	2.99%	3.14%	3.35%	3.49%	3.78%	3.93%	4.19%	4.72%	5.03%	5.24%	6.28%	6.98%	10.47%	
1.5 (3.8)	.5 (0.015)	1.09 (0.033)	1.23 (0.037)	1.4 (0.043)	1.45 (0.044)	1.5 (0.046)	1.64 (0.050)	1.87 (0.057)	1.96 (0.059)	2.09 (0.063)	2.18 (0.066)	2.45 (0.075)	2.51 (0.075)	2.62 (0.079)	2.79 (0.084)	2.91 (0.090)	3.14 (0.094)	3.27 (0.099)	3.74 (0.115)	3.93 (0.118)	4.19 (0.127)	4.36 (0.133)	4.72 (0.146)	4.91 (0.152)	5.24 (0.159)	5.91 (0.183)	6.28 (0.193)	6.54 (0.202)	7.85 (0.242)	8.73 (0.270)	13.09 (0.411)	
2 (5.1)	.66 (0.020)	1.45 (0.045)	1.64 (0.050)	1.87 (0.057)	1.94 (0.059)	1.99 (0.061)	2.18 (0.067)	2.49 (0.076)	2.62 (0.080)	2.79 (0.085)	2.91 (0.089)	3.27 (0.100)	3.35 (0.101)	3.49 (0.106)	3.72 (0.113)	3.88 (0.121)	4.19 (0.127)	4.36 (0.133)	4.99 (0.155)	5.24 (0.159)	5.59 (0.170)	5.82 (0.178)	6.3 (0.196)	6.54 (0.204)	6.98 (0.213)	7.87 (0.246)	8.38 (0.258)	8.73 (0.271)	10.47 (0.324)	11.64 (0.363)	17.45 (0.551)	
2.5 (6.4)	.83 (0.026)	1.82 (0.056)	2.05 (0.063)	2.34 (0.072)	2.42 (0.075)	2.49 (0.077)	2.73 (0.084)	3.12 (0.096)	3.27 (0.100)	3.49 (0.107)	3.64 (0.112)	4.09 (0.126)	4.19 (0.127)	4.36 (0.133)	4.65 (0.142)	4.85 (0.152)	5.24 (0.159)	5.45 (0.167)	6.23 (0.194)	6.54 (0.199)	6.98 (0.213)	7.27 (0.224)	7.87 (0.246)	8.18 (0.256)	8.73 (0.268)	9.84 (0.308)	10.47 (0.324)	10.91 (0.340)	13.09 (0.407)	14.54 (0.455)	21.82 (0.692)	
3 (7.6)	1 (0.030)	2.18 (0.067)	2.45 (0.075)	2.8 (0.085)	2.91 (0.089)	2.99 (0.091)	3.27 (0.100)	3.74 (0.113)	3.93 (0.119)	4.19 (0.127)	4.36 (0.133)	4.91 (0.149)	5.03 (0.150)	5.24 (0.158)	5.59 (0.169)	5.82 (0.180)	6.28 (0.189)	6.54 (0.198)	7.48 (0.231)	7.85 (0.237)	8.38 (0.253)	8.73 (0.266)	9.45 (0.292)	9.82 (0.304)	10.47 (0.318)	11.81 (0.366)	12.57 (0.385)	13.09 (0.404)	15.71 (0.483)	17.45 (0.540)	26.18 (0.822)	
3.5 (8.9)	1.16 (0.036)	2.55 (0.078)	2.86 (0.087)	3.27 (0.100)	3.39 (0.104)	3.49 (0.107)	3.82 (0.117)	4.36 (0.133)	4.58 (0.139)	4.89 (0.148)	5.09 (0.156)	5.73 (0.175)	5.86 (0.176)	6.11 (0.185)	6.52 (0.198)	6.79 (0.211)	7.33 (0.221)	7.64 (0.232)	8.73 (0.270)	9.16 (0.277)	9.77 (0.297)	10.18 (0.311)	11.02 (0.342)	11.45 (0.356)	12.22 (0.372)	13.78 (0.429)	14.66 (0.451)	15.27 (0.473)	18.33 (0.566)	20.36 (0.633)	30.5	

PROCORE® SR SERIES

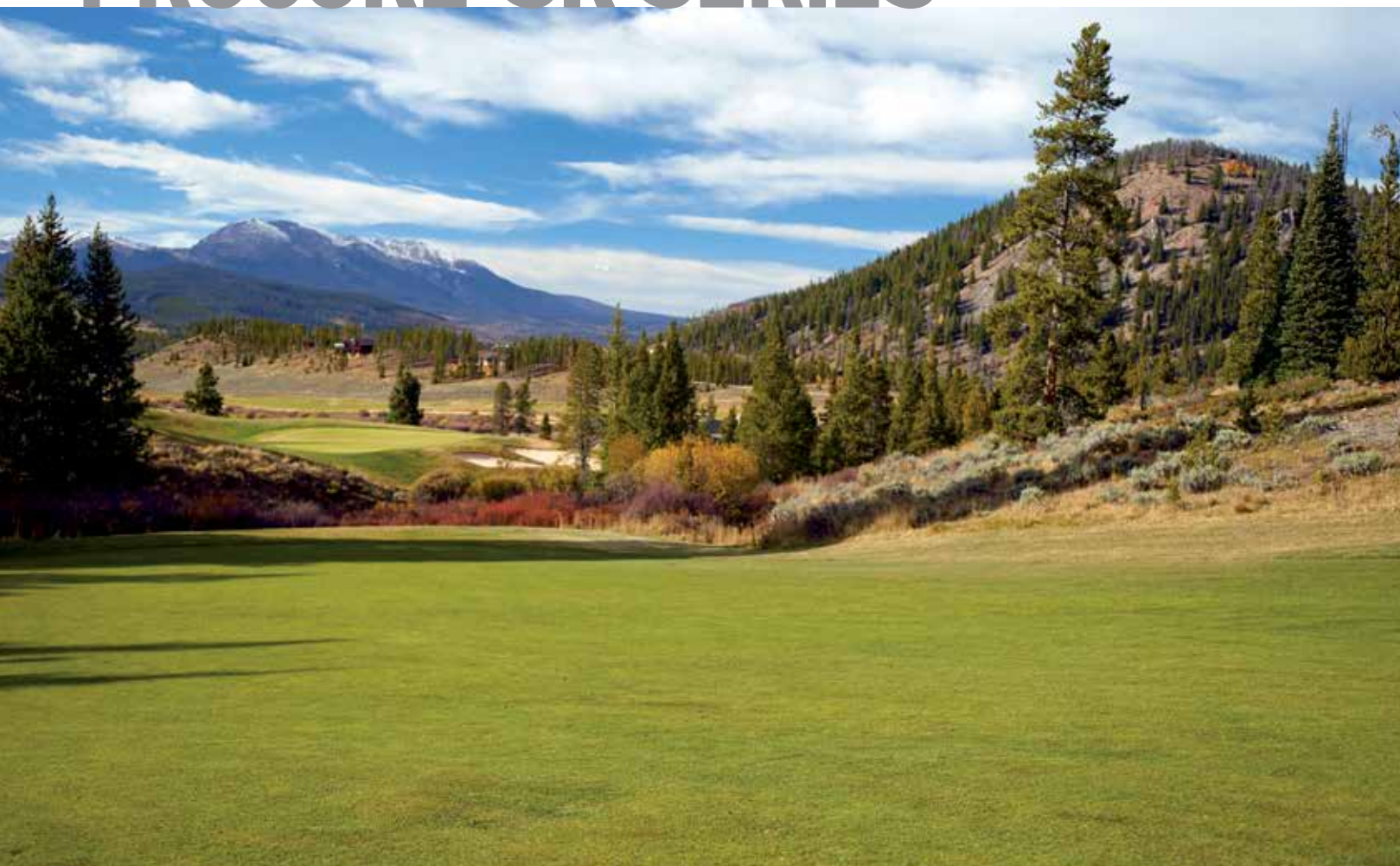

The ProCore SR Series provide working widths of 48" – 75" (122 – 190 cm), working depths up to 16" (40.6 cm) and hole spacing from 2.5"– 6" (6,3 – 15,2 cm).

5/16" (12 MM) OR 11/16" (18 MM) MOUNT

Mount	Length	Core Dia. (ID)	OD	Part	Adapter Sleeve	Replacement Tube
CORING TINES						
12,0 mm	7.00" (177,8 mm)	.52" (13,2 mm)	.69" (17,4 mm)	139-8614	–	SGT07625
12,0 mm	7.00" (177,8 mm)	.56" (14,2 mm)	.81" (20,7 mm)	139-8615	–	SGT07750
12,0 mm	10.00" (254,0 mm)	.56" (14,2 mm)	.75" (19,0 mm)	139-8624	–	SGT10750
12,0 mm	10.00" (254,0 mm)	.56" (14,2 mm)	.81" (20,6 mm)	139-8613	–	SGT10813H
18,0 mm	8.00" (203,2 mm)	.94" (23,9 mm)	1.31" (33,3 mm)	139-8622	–	SGT08125
18,0 mm	8.00" (203,2 mm)	.74" (18,8 mm)	1.06" (26,9 mm)	139-8628	–	SGT08100H
18,0 mm	10.00" (254,0 mm)	.56" (14,2 mm)	.75" (19,0 mm)	139-8623	–	SGT10750
18,0 mm	10.00" (254,0 mm)	.74" (18,8 mm)	1.06" (26,9 mm)	139-8617	–	139-8617
18,0 mm	10.00" (254,0 mm)	.76" (19,3 mm)	1.00" (25,4 mm)	139-8619	–	SGT10100S
18,0 mm	12.00" (304,8 mm)	.94" (23,9 mm)	1.31" (33,3 mm)	139-8623	–	SGT12125
SOLID TINES						
5/16" (7,9 mm)	8.50" (215,9 mm)	–	.31" (7,9 mm)	SGS07313*	SGA08313	–
5/16" (7,9 mm)	10.00" (254,0 mm)	–	.31" (7,9 mm)	SGS08313*	SGA08313	–
3/8" (9,5 mm)	9.00" (228,6 mm)	–	.38" (9,5 mm)	SGS08375*	SGA12375	–
3/8" (9,5 mm)	10.75" (273,1 mm)	–	.38" (9,5 mm)	SGS10374*	SGA12375	–
3/8" (9,5 mm)	12.25" (311,2 mm)	–	.38" (9,5 mm)	SGS10375*	SGA12375	–
12,0 mm	8.00" (203,2 mm)	–	12,0 mm	SGS08500	–	–
12,0 mm	10.75" (273,1 mm)	–	12,0 mm	SGS10504	–	–
12,0 mm	12.25" (311,2 mm)	–	12,0 mm	SGS10500	–	–
12,0 mm	14.25" (361,9 mm)	–	12,0 mm	SGS12500	–	–
12,0 mm	16.25" (412,8 mm)	–	12,0 mm	SGS14500	–	–
18,0 mm	12.25" (311,2 mm)	–	18,0 mm	SGS10750	–	–
18,0 mm	12.50" (317,5 mm)	–	18,0 mm	SGS10875	–	–
18,0 mm	14.00" (355,6 mm)	–	18,0 mm	SGS12875	–	–
18,0 mm	14.25" (361,9 mm)	–	18,0 mm	SGS12750	–	–
18,0 mm	16.00" (406,4 mm)	–	18,0 mm	SGS14875	–	–
18,0 mm	16.25" (412,8 mm)	–	18,0 mm	SGS14750	–	–

SR48 ADAPTER HEAD KIT 117-7190

SOLID TINES						
5/16" (7,9 mm)	8.50" (215,9 mm)	–	.31" (7,9 mm)	SGS07313	–	–
5/16" (7,9 mm)	10.00" (254,0 mm)	–	.31" (7,9 mm)	SGS08313	–	–

SR48 ADAPTER HEAD KIT 117-7191

CORING TINES						
12,0 mm	7.00" (177,8 mm)	.52" (13,2 mm)	.69" (17,4 mm)	139-8616	–	SGT07625
12,0 mm	7.00" (177,8 mm)	.56" (14,2 mm)	.81" (20,7 mm)	139-8625	–	SGT07750
12,0 mm	10.00" (254,0 mm)	.56" (14,2 mm)	.75" (19,0 mm)	139-8620	–	SGT10750
SOLID TINES						
12,0 mm	8.00" (203,2 mm)	–	12,0 mm	SGS08500	–	–
12,0 mm	12.25" (311,2 mm)	–	12,0 mm	SGS10500	–	–
12,0 mm	14.25" (361,9 mm)	–	12,0 mm	SGS12500	–	–
12,0 mm	16.25" (412,8 mm)	–	12,0 mm	SGS14500	–	–

5/16" (12 MM) MOUNT

Mount	Length	Core Dia. (ID)	OD	Part	Adapter Sleeve	Replacement Tube
CORING TINES						
3/8" (9,5 mm)	5.50" (139,7 mm)	.38" (9,5 mm)	.50" (12,7 mm)	139-8618	SGA10375	-
12,0 mm	7.00" (177,8 mm)	.52" (13,2 mm)	.69" (17,4 mm)	139-8616	-	SGT07625
12,0 mm	7.00" (177,8 mm)	.56" (14,2 mm)	.81" (20,7 mm)	139-8625	-	SGT07750
12,0 mm	10.00" (254,0 mm)	.56" (14,2 mm)	.75" (19,0 mm)	139-8620	-	SGT10750
SOLID TINES						
5/16" (7,9 mm)	8.50" (215,9 mm)	-	.31" (7,9 mm)	SGS07313	-	-
5/16" (7,9 mm)	10.00" (254,0 mm)	-	.31" (7,9 mm)	SGS08313	-	-
3/8" (9,5 mm)	9.00" (228,6 mm)	-	.38" (9,5 mm)	SGS08375*	SGA10375	-
3/8" (9,5 mm)	10.75" (273,1 mm)	-	.38" (9,5 mm)	SGS10374*	SGA10375	-
12,0 mm	8.00" (203,2 mm)	-	12,0 mm	SGS08500	-	-
12,0 mm	10.75" (273,1 mm)	-	12,0 mm	SGS10504	-	-

SR 54 ADAPTER HEAD KIT 117-7193 (36 TINES)

CORING TINES						
3/8" (9,5 mm)	5.50" (139,7 mm)	.38" (9,5 mm)	.50" (12,7 mm)	139-8618	-	SGT05550
SOLID TINES						
5/16" (7,9 mm)	8.50" (215,9 mm)	-	.31" (7,9 mm)	SGS07313	-	-
5/16" (7,9 mm)	10.00" (254,0 mm)	-	.31" (7,9 mm)	SGS08313	-	-
3/8" (9,5 mm)	9.00" (228,6 mm)	-	.38" (9,5 mm)	SGS08375*	SGA10375	-
3/8" (9,5 mm)	10.75" (273,1 mm)	-	.38" (9,5 mm)	SGS10374*	SGA10375	-
3/8" (9,5 mm)	12.25" (311,2 mm)	-	.38" (9,5 mm)	SGS10375*	SGA10375	-

*Longer shank tine.

SR 54 ADAPTER HEAD KIT 117-7193 (36 TINES) – CONTINUED

Mount	Length	Core Dia. (ID)	OD	Part	Adapter Sleeve	Replacement Tube
CORING TINES						
12,0 mm	7.00" (177,8 mm)	.52" (13,2 mm)	.69" (17,4 mm)	139-8616	-	SGT07625
12,0 mm	7.00" (177,8 mm)	.56" (14,2 mm)	.81" (20,7 mm)	139-8625	-	SGT07750
12,0 mm	10.00" (254,0 mm)	.56" (14,2 mm)	.75" (19,0 mm)	139-8620	-	SGT10750
SOLID TINES						
5/16" (7,9 mm)	8.50" (215,9 mm)	-	.31" (7,9 mm)	SGS07313	-	-
5/16" (7,9 mm)	10.00" (254,0 mm)	-	.31" (7,9 mm)	SGS08313	-	-
12,0 mm	8.00" (203,2 mm)	-	12,0 mm	SGS08500	-	-
12,0 mm	10.75" (273,1 mm)	-	12,0 mm	SGS10504	-	-

SR 54-S ADAPTER HEAD KIT 117-7194 (12 TINES)

SOLID TINES						
18,0 mm	12.25" (311,2 mm)	-	18,0 mm	SGS10750	-	-

SR 54-S ADAPTER HEAD KIT 117-7195 (12 TINES)

CORING TINES						
12,0 mm	7.00" (177,8 mm)	.52" (13,2 mm)	.69" (17,4 mm)	139-8616	-	SGT07625
12,0 mm	7.00" (177,8 mm)	.56" (14,2 mm)	.81" (20,7 mm)	139-8625	-	SGT07750
12,0 mm	10.00" (254,0 mm)	.56" (14,2 mm)	.75" (19,0 mm)	139-8620	-	SGT10750
SOLID TINES						
5/16" (7,9 mm)	8.50" (215,9 mm)	-	.31" (7,9 mm)	SGS07313	-	-
5/16" (7,9 mm)	10.00" (254,0 mm)	-	.31" (7,9 mm)	SGS08313	-	-
12,0 mm	8.00" (203,2 mm)	-	12,0 mm	SGS08500	-	-
12,0 mm	10.75" (273,1 mm)	-	12,0 mm	SGS10504	-	-

SR 54-S ADAPTER HEAD KIT 117-7196 (24 TINES)

CORING TINES						
3/8" (9,5 mm)	5.50" (139,7 mm)	.38" (9,5 mm)	.50" (12,7 mm)	139-8618	-	SGT05550
SOLID TINES						
5/16" (7,9 mm)	8.50" (215,9 mm)	-	.31" (7,9 mm)	SGS07313	-	-
5/16" (7,9 mm)	10.00" (254,0 mm)	-	.31" (7,9 mm)	SGS08313	-	-
3/8" (9,5 mm)	9.00" (228,6 mm)	-	.38" (9,5 mm)	SGS08375	-	-
3/8" (9,5 mm)	10.75" (273,1 mm)	-	.38" (9,5 mm)	SGS10374	-	-

SR 54-S ADAPTER HEAD KIT 117-7199 (48 TINES)

CORING TINES						
3/8" (9,5 mm)	5.50" (139,7 mm)	.38" (9,5 mm)	.50" (12,7 mm)	139-8618	-	SGT05550
SOLID TINES						
3/8" (9,5 mm)	9.00" (228,6 mm)	-	.38" (9,5 mm)	SGS08375	-	-
3/8" (9,5 mm)	10.75" (273,1 mm)	-	.38" (9,5 mm)	SGS10374	-	-

5/16" (12 MM) MOUNT

Mount	Length	Core Dia. (ID)	OD	Part	Adapter Sleeve	Replacement Tube
<i>CORING TINES</i>						
3/8" (9,5 mm)	5.50" (139,7 mm)	.38" (9,5 mm)	.50" (12,7 mm)	139-8618	SGA10375	SGT05550
12,0 mm	7.00" (177,8 mm)	.52" (13,2 mm)	.69" (17,4 mm)	139-8616	-	SGT07625
12,0 mm	7.00" (177,8 mm)	.56" (14,2 mm)	.81" (20,7 mm)	139-8625	-	SGT07750
12,0 mm	10.00" (254,0 mm)	.56" (14,2 mm)	.75" (19,0 mm)	139-8620	-	SGT10750
<i>SOLID TINES</i>						
5/16" (7,9 mm)	8.50" (215,9 mm)	-	.31" (7,9 mm)	SGS07313	-	-
5/16" (7,9 mm)	10.00" (254,0 mm)	-	.31" (7,9 mm)	SGS08313	-	-
3/8" (9,5 mm)	9.00" (228,6 mm)	-	.38" (9,5 mm)	SGS08375	SGA10375	-
3/8" (9,5 mm)	10.75" (273,1 mm)	-	.38" (9,5 mm)	SGS10374	SGA10375	-
12,0 mm	8.00" (203,2 mm)	-	12,0 mm	SGS08500	-	-
12,0 mm	10.75" (273,1 mm)	-	12,0 mm	SGS10504	-	-

SR70 ADAPTER HEAD KIT 117-7193 (48 TINES)

<i>CORING TINES</i>						
3/8" (9,5 mm)	5.50" (139,7 mm)	-	.50" (12,7 mm)	139-8618	-	-
<i>SOLID TINES</i>						
5/16" (7,9 mm)	8.50" (215,9 mm)	-	.3125" (7,9 mm)	SGS07313	-	-
5/16" (7,9 mm)	10.00" (254,0 mm)	-	.3125" (7,9 mm)	SGS08313	-	-
3/8" (9,5 mm)	9.00" (228,6 mm)	-	.375" (9,5 mm)	SGS08375	-	-
3/8" (9,5 mm)	10.75" (273,1 mm)	-	.375" (9,5 mm)	SGS10374	-	-
3/8" (9,5 mm)	12.25" (311,2 mm)	-	.375" (9,5 mm)	SGS10375	-	-

SR70 ADAPTER HEAD KIT 117-7193 (48 TINES) – CONTINUED

Mount	Length	Core Dia. (ID)	OD	Part	Adapter Sleeve	Replacement Tube
<i>CORING TINES</i>						
12,0 mm	7.00" (177,8 mm)	.52" (13,2 mm)	.69" (17,4 mm)	139-8616	-	SGT07625
12,0 mm	7.00" (177,8 mm)	.56" (14,2 mm)	.81" (20,7 mm)	139-8625	-	SGT07750
12,0 mm	10.00" (254,0 mm)	.56" (14,2 mm)	.75" (19,0 mm)	139-8620	-	SGT10750
<i>SOLID TINES</i>						
5/16" (7,9 mm)	8.50" (215,9 mm)	-	.3125" (7,9 mm)	SGS07313	-	-
5/16" (7,9 mm)	10.00" (254,0 mm)	-	.3125" (7,9 mm)	SGS08313	-	-
12,0 mm	8.00" (203,2 mm)	-	12,0 mm	SGS08500	-	-
12,0 mm	10.75" (273,1 mm)	-	12,0 mm	SGS10504	-	-

SR70-S ADAPTER HEAD KIT 117-7194 (16 TINES)

<i>SOLID TINES</i>						
18,0 mm	12.25" (311,2 mm)	-	18,0 mm	SGS10750	-	-

SR70-S ADAPTER HEAD KIT 117-7195 (16 TINES)

<i>CORING TINES</i>						
12,0 mm	7.00" (177,8 mm)	.52" (13,2 mm)	.69" (17,4 mm)	139-8616	-	SGT07625
12,0 mm	7.00" (177,8 mm)	.56" (14,2 mm)	.81" (20,7 mm)	139-8625	-	SGT07750
12,0 mm	10.00" (254,0 mm)	.56" (14,2 mm)	.75" (19,0 mm)	139-8620	-	SGT10750
<i>SOLID TINES</i>						
5/16" (7,9 mm)	8.50" (215,9 mm)	-	.3125" (7,9 mm)	SGS07313	-	-
5/16" (7,9 mm)	10.00" (254,0 mm)	-	.3125" (7,9 mm)	SGS08313	-	-
12,0 mm	8.00" (203,2 mm)	-	12,0 mm	SGS08500	-	-
12,0 mm	10.75" (273,1 mm)	-	12,0 mm	SGS10504	-	-

SR70-S ADAPTER HEAD KIT 117-7196 (32 TINES)

<i>CORING TINES</i>						
3/8" (9,5 mm)	5.50" (139,7 mm)	.38" (9,5 mm)	.50" (12,7 mm)	139-8618	-	SGT05550
<i>SOLID TINES</i>						
5/16" (7,9 mm)	8.50" (215,9 mm)	-	.3125" (7,9 mm)	SGS07313	-	-
5/16" (7,9 mm)	10.00" (254,0 mm)	-	.3125" (7,9 mm)	SGS08313	-	-
3/8" (9,5 mm)	9.00" (228,6 mm)	-	.375" (9,5 mm)	SGS08375	-	-
3/8" (9,5 mm)	10.75" (273,1 mm)	-	.375" (9,5 mm)	SGS10374	-	-

SR70-S ADAPTER HEAD KIT 117-7199 (64 TINES)

<i>CORING TINES</i>						
3/8" (9,5 mm)	5.50" (139,7 mm)	.38" (9,5 mm)	.50" (12,7 mm)	139-8618	-	SGT05550
<i>SOLID TINES</i>						
3/8" (9,5 mm)	9.00" (228,6 mm)	-	.375" (9,5 mm)	SGS08375	-	-
3/8" (9,5 mm)	10.75" (273,1 mm)	-	.375" (9,5 mm)	SGS10374	-	-

5/16" (12 MM) OR 11/16" (18 MM) MOUNT

Mount	Length	Core Dia. (ID)	OD	Part	Adapter Sleeve	Replacement Tube
CORING TINES						
12,0 mm Long	7.00" (177,8 mm)	.52" (13,2 mm)	.69" (17,4 mm)	139-8614	-	SGT07625
12,0 mm Long	7.00" (177,8 mm)	.56" (14,2 mm)	.81" (20,7 mm)	139-8615	-	SGT07750
12,0 mm Long	10.00" (254,0 mm)	.56" (14,2 mm)	.75" (19,0 mm)	139-8624	-	SGT10750
12,0 mm Long	10.00" (254,0 mm)	.56" (14,2 mm)	.81" (20,6 mm)	139-8613	-	SGT10813H
18,0 mm Long	8.00" (203,2 mm)	.94" (23,9 mm)	1.31" (33,3 mm)	139-8622	-	SGT10750
18,0 mm Long	8.00" (203,2 mm)	.74" (18,8 mm)	1.06" (26,9 mm)	139-8628	-	SGT08100H
18,0 mm Long	10.00" (254,0 mm)	.56" (14,2 mm)	.75" (19,0 mm)	139-8623	-	SGT10100S
18,0 mm Long	10.00" (254,0 mm)	.74" (18,8 mm)	1.06" (26,9 mm)	139-8617	-	139-8617
18,0 mm Long	10.00" (254,0 mm)	.76" (19,3 mm)	1.00" (25,4 mm)	139-8619	-	SGT08125
18,0 mm Long	12.00" (304,8 mm)	.94" (23,9 mm)	1.31" (33,3 mm)	139-8627	-	SGT12125

Mount	Length	Core Dia. (ID)	OD	Part	Adapter Sleeve	Replacement Tube
SOLID TINES						
5/16" (7,9 mm)	8.50" (215,9 mm)	-	.31" (7,9 mm)	SGS07313	SGA08313	-
5/16" (7,9 mm)	10.00" (254,0 mm)	-	.31" (7,9 mm)	SGS08313	SGA08313	-
3/8" (9,5 mm)	9.00" (228,6 mm)	-	.375" (9,5 mm)	SGS08375	SGA12375	-
3/8" (9,5 mm)	10.75" (273,1 mm)	-	.375" (9,5 mm)	SGS10374	SGA12375	-
3/8" (9,5 mm)	12.25" (311,2 mm)	-	.375" (9,5 mm)	SGS10375	SGA12375	-
12,0 mm	8.00" (203,2 mm)	-	12,0 mm	SGS08500	-	-
12,0 mm	10.75" (273,1 mm)	-	12,0 mm	SGS10504	-	-
12,0 mm	12.25" (311,2 mm)	-	12,0 mm	SGS10500	-	-
12,0 mm	14.25" (361,9 mm)	-	12,0 mm	SGS12500	-	-
12,0 mm	16.25" (412,8 mm)	-	12,0 mm	SGS14500	-	-
18,0 mm	12.25" (311,2 mm)	-	18,0 mm	SGS10750	-	-
18,0 mm	12.50" (317,5 mm)	-	18,0 mm	SGS10875	-	-
18,0 mm	14.00" (355,6 mm)	-	18,0 mm	SGS12875	-	-
18,0 mm	14.25" (361,9 mm)	-	18,0 mm	SGS12750	-	-
18,0 mm	16.00" (406,4 mm)	-	18,0 mm	SGS14875	-	-
18,0 mm	16.25" (412,8 mm)	-	18,0 mm	SGS14750	-	-

SR72 ADAPTER HEAD KIT 117-7190 (60 TINES)

Mount	Length	Core Dia. (ID)	OD	Part	Adapter Sleeve	Replacement Tube
SOLID TINES						
5/16" (7,9 mm)	8.50" (215,9 mm)	-	.3125" (7,9 mm)	SGS07313	-	-
5/16" (7,9 mm)	10.00" (254,0 mm)	-	.3125" (7,9 mm)	SGS08313	-	-

SR72 ADAPTER HEAD KIT 117-7191 (60 TINES)

Mount	Length	Core Dia. (ID)	OD	Part	Adapter Sleeve	Replacement Tube
CORING TINES						
12,0 mm	7.00" (177,8 mm)	.52" (13,2 mm)	.69" (17,4 mm)	139-8616	-	SGT07625
12,0 mm	7.00" (177,8 mm)	.56" (14,2 mm)	.81" (20,7 mm)	139-8625	-	SGT07750
12,0 mm	10.00" (254,0 mm)	.56" (14,2 mm)	.75" (19,0 mm)	139-8620	-	SGT10750

Mount	Length	Core Dia. (ID)	OD	Part	Adapter Sleeve	Replacement Tube
SOLID TINES						
12,0 mm	8.00" (203,2 mm)	-	12,0 mm	SGS08500	-	-
12,0 mm	12.25" (311,2 mm)	-	12,0 mm	SGS10500	-	-
12,0 mm	14.25" (361,9 mm)	-	12,0 mm	SGS12500	-	-
12,0 mm	16.25" (412,8 mm)	-	12,0 mm	SGS14500	-	-

*Longer shank tine.

7/8" (22.2 MM) MOUNT

Mount	Length	Core Dia. (ID)	OD	Part	Adapter Sleeve	Replacement Tube
CORING TINES						
18,0 mm Long	8.00" (203,2 mm)	.94" (23,9 mm)	1.31" (33,3 mm)	139-8622	SG715802	SGT08125
18,0 mm Long	8.00" (203,2 mm)	.74" (18,8 mm)	1.06" (26,9 mm)	139-8628	SG715802	SGT08100H
18,0 mm Long	10.00" (254,0 mm)	.56" (14,2 mm)	.75" (19,0 mm)	139-8623	SG715802	SGT10750
18,0 mm Long	10.00" (254,0 mm)	.74" (18,8 mm)	1.06" (26,9 mm)	139-8617	SG715802	139-8617
18,0 mm Long	10.00" (254,0 mm)	.76" (19,3 mm)	1.00" (25,4 mm)	139-8619	SG715802	SGT10100S
18,0 mm Long	12.00" (304,8 mm)	.94" (23,9 mm)	1.31" (33,3 mm)	139-8627	SG715802	SGT12125
7/8" (22,2 mm) Long	8.00" (203,2 mm)	.94" (23,9 mm)	1.31" (33,3 mm)	139-8626	-	SGT08125
7/8" (22,2 mm) Long	12.00" (304,8 mm)	.94" (23,9 mm)	1.31" (33,3 mm)	139-8621	-	SGT12125

Mount	Length	Core Dia. (ID)	OD	Part	Adapter Sleeve	Replacement Tube
SOLID TINES						
18,0 mm	12.25" (311,2 mm)	-	18,0 mm	SGS10750	SG715802	-
18,0 mm	12.50" (317,5 mm)	-	.875" (22,2 mm)	SGS10875	SG715802	-
18,0 mm	14.00" (355,6 mm)	-	.875" (22,2 mm)	SGS12875	SG715802	-
18,0 mm	14.25" (361,9 mm)	-	18,0 mm	SGS12750	SG715802	-
18,0 mm	16.00" (406,4 mm)	-	.875" (22,2 mm)	SGS14875	SG715802	-
18,0 mm	16.25" (412,8 mm)	-	18,0 mm	SGS14750	SG715802	-
7/8" (22,2 mm)	12.50" (317,5 mm)	-	.875" (22,2 mm)	SGS10876	-	-
7/8" (22,2 mm)	14.00" (355,6 mm)	-	.875" (22,2 mm)	SGS12876	-	-
7/8" (22,2 mm)	17.88" (454,2 mm)	-	1.00" (25,4 mm)	SGS16100	-	-

SR75 ADAPTER HEAD KIT 117-7198 (5/32X15/32" [4X12 MM] = 24 TINES OR 1/8X11/16" [3X18MM] = 18 TINES)

Mount	Length	Core Dia. (ID)	OD	Part	Adapter Sleeve	Replacement Tube
CORING TINES						
12,0 mm Long	7.00" (177,8 mm)	.52" (13,2 mm)	.69" (17,4 mm)	139-8614	-	SGT07625
12,0 mm Long	7.00" (177,8 mm)	.56" (14,2 mm)	.81" (20,7 mm)	139-8615	-	SGT07750
12,0 mm Long	10.00" (254,0 mm)	.56" (14,2 mm)	.81" (20,6 mm)	139-8613	-	SGT10813H
12,0 mm Long	10.00" (254,0 mm)	.56" (14,2 mm)	.75" (19,0 mm)	139-8624	-	SGT10750
18,0 mm Long	8.00" (203,2 mm)	.74" (18,8 mm)	1.06" (26,9 mm)	139-8628	-	SGT08100H
18,0 mm Long	8.00" (203,2 mm)	.94" (23,9 mm)	1.31" (33,3 mm)	139-8622	-	SGT08125
18,0 mm Long	10.00" (254,0 mm)	.56" (14,2 mm)	.75" (19,0 mm)	139-8623	-	SGT07625
18,0 mm Long	10.00" (254,0 mm)	.76" (19,3 mm)	1.00" (25,4 mm)	139-8619	-	SGT10100S
18,0 mm Long	10.00" (254,0 mm)	.74" (18,8 mm)	1.06" (26,9 mm)	139-8617	-	139-8617
18,0 mm Long	12.00" (304,8 mm)	.94" (23,9 mm)	1.31" (33,3 mm)	139-8627	-	SGT12125

*Longer shank tine.

ADAPTER HEAD KIT 117-7198 – CONTINUED

Mount	Length	Core Dia. (ID)	OD	Part	Adapter Sleeve	Replacement Tube
<i>SOLID TINES</i>						
12,0 mm	8.00" (203,2 mm)	-	12,0 mm	SGS08500	-	-
12,0 mm	10.75" (273,1 mm)	-	12,0 mm	SGS10504	-	-
12,0 mm	12.25" (311,2 mm)	-	12,0 mm	SGS10500	-	-
12,0 mm	14.25" (361,9 mm)	-	12,0 mm	SGS12500	-	-
12,0 mm	16.25" (412,8 mm)	-	12,0 mm	SGS14500	-	-
18,0 mm	12.25" (311,2 mm)	-	18,0 mm	SGS10750	-	-
18,0 mm	12.50" (317,5 mm)	-	.875" (22,2 mm)	SGS10875	-	-
18,0 mm	14.00" (355,6 mm)	-	.875" (22,2 mm)	SGS12875	-	-
18,0 mm	14.25" (361,9 mm)	-	18,0 mm	SGS12750	-	-
18,0 mm	16.00" (406,4 mm)	-	.875" (22,2 mm)	SGS14875	-	-
18,0 mm	16.25" (412,8 mm)	-	18,0 mm	SGS14750	-	-

COMPETITIVE MODELS



TITAN® Conversion Sleeves

Part Number	Description	Mount
112-1300	Sleeve	1/2" (12,7 mm)
112-1301	Sleeve	5/8" (15,9 mm)

Easily Converts TITAN® Tines to 1/2" (12,7 mm) and 5/8" (15,9 mm) Mount. Toro® conversion sleeves allow the complete selection of Toro tines to fit on most competitive equipment. The conversion sleeve slides onto a 3/8" (9,5 mm) mount Toro tine to create a 1/2" (12,7 mm) mount or 5/8" (15,9 mm) mount.

TITAN® TINES COMPETITIVE MODELS

3/8" (99.5 MM) MOUNT					TITAN® Max		Competitive Model	
Length	Core Dia. (ID)	OD	Part Number	Wall	Part Number	Core Dia. (ID)	Ryan® GA 24/30/60	John Deere®
TITAN QUAD					TITAN MAX QUAD			
4.50" (114,3 mm)	.25" (6,3 mm)	.36" (9,1 mm)	108-9104	.052" (1,3 mm)	108-9112	.23" (5,8 mm)	X	X
4.50" (114,3 mm)	.32" (8,1 mm)	.46" (11,6 mm)	108-9105	.063" (1,6 mm)	108-9114	.28" (7,1 mm)	X	X
4.50" (114,3 mm)	.41" (10,3 mm)	.55" (13,9 mm)	108-9106	.063" (1,6 mm)	108-9116	.38" (9,7 mm)	X	X
4.50" (114,3 mm)	.48" (12,2 mm)	.58" (14,7 mm)	108-9293	.049" (1,2 mm)	-	-	X	X
5.00" (127,0 mm)	.25" (6,3 mm)	.36" (9,1 mm)	138-5937	.052" (1,3 mm)	108-9120	.23" (5,8 mm)	X	X
5.00" (127,0 mm)	.32" (8,1 mm)	.46" (11,6 mm)	137-6526	.063" (1,6 mm)	108-9122	.28" (7,1 mm)	X	X
5.00" (127,0 mm)	.41" (10,3 mm)	.55" (13,9 mm)	137-6527	.063" (1,6 mm)	108-9124	.38" (9,7 mm)	X	X
5.00" (127,0 mm)	.48" (12,2 mm)	.58" (14,7 mm)	137-6529	.049" (1,2 mm)	-	-	X	X
TITAN SOLID ROUND					TITAN MAX QUAD			
4.50" (114,3 mm)	-	.20" (5,1 mm)	108-9230	-	-	-	X	X
4.50" (114,3 mm)	-	.25" (6,3 mm)	108-9231	-	-	-	X	X
4.50" (114,3 mm)	-	.30" (7,6 mm)	108-9232	-	-	-	X	X
4.50" (114,3 mm)	-	.38" (9,7 mm)	108-9233	-	-	-	X	X
5.50" (139,7 mm)	-	.20" (5,1 mm)	108-9234	-	-	-	X	X
5.50" (139,7 mm)	-	.25" (6,3 mm)	108-9235	-	-	-	X	X
5.50" (139,7 mm)	-	.30" (7,6 mm)	108-9236	-	-	-	X	X
5.50" (139,7 mm)	-	.38" (9,7 mm)	108-9237	-	-	-	X	X
TITAN SOLID SLICING					TITAN MAX QUAD			
5.00" (127,0 mm)	-	.63" (15,9 mm)	108-9238	-	-	-	X	X
TITAN CROSS					TITAN MAX CROSS			
4.50" (114,3 mm)	-	.38" (9,5 mm)	108-9215	-	-	-	X	X
4.50" (114,3 mm)	-	.50" (12,7 mm)	108-9216	-	112-1310	-	X	X
4.50" (114,3 mm)	-	.63" (15,9 mm)	108-9217	-	-	-	X	X
5.50" (139,7 mm)	-	.38" (9,5 mm)	108-9218	-	-	-	X*	X
5.50" (139,7 mm)	-	.50" (12,7 mm)	108-9219	-	112-1311	-	X*	X
5.50" (139,7 mm)	-	.63" (15,9 mm)	108-9220	-	-	-	X*	X

*Only available on GA 30/60 models

TITAN® TINES COMPETITIVE MODELS

1/2" (12.7 MM) MOUNT					TITAN® Max		Competitive Model	
Length	Core Dia. (ID)	OD	Part Number	Wall	Part Number	Core Dia. (ID)	Ryan® GA 24/30/60	John Deere®
TITAN QUAD					TITAN MAX QUAD			
4.50" (114,3 mm)	.32" (8,3 mm)	.46" (11,6 mm)	112-1316	.063" (1,6 mm)	112-1322	.28" (7,1 mm)	X	-
TITAN SOLID ROUND					TITAN MAX QUAD			
4.50" (114,3 mm)	-	.50" (12,7 mm)	112-1347	-	-	-	X	-
5.50" (139,7 mm)	-	.25" (6,3 mm)	112-1329	-	-	-	X	-
TITAN SOLID SLICING					TITAN MAX QUAD			
5.00" (127,0 mm)	-	.63" (15,9 mm)	112-5102	-	-	-	X	-
5/8" (15.8 MM) MOUNT					TITAN® Max		Competitive Model	
TITAN SIDE EJECT					TITAN MAX QUAD			
4.50" (114,3 mm)	.43" (10,9 mm)	.56" (14,2 mm)	112-1303	.058" (1,5 mm)	112-1304	.38" (9,5 mm)	X	-
TITAN SOLID ROUND					TITAN MAX QUAD			
4.50" (114,3 mm)	-	.63" (15,9 mm)	112-1348	-	-	-	X	-
TITAN SOLID SLICING					TITAN MAX QUAD			
5.00" (127,0 mm)	-	.63" (15,9 mm)	112-5103	-	-	-	X	-

*Only available on GA 30/60 models

TITAN® TINES COMPETITIVE MODELS

3/4" (19.05 MM) MOUNT					TITAN® Max		Competitive Model	
Length	Core Dia. (ID)	OD	Part Number	Wall	Part Number	Core Dia. (ID)	Ryan® GA 24/30/60	John Deere®
TITAN HOLLOW					TITAN MAX HOLLOW			
4.75" (120,6 mm)	.28" (7,1 mm)	.46" (11,7 mm)	108-9128	.058" (1,5 mm)	108-9139	.28" (7,1 mm)	X	X
4.75" (120,6 mm)	.41" (10,3 mm)	.56" (14,2 mm)	108-9129	.058" (1,5 mm)	108-9141	.38" (9,7 mm)	X	X
4.75" (120,6 mm)	.53" (13,4 mm)	.66" (16,8 mm)	108-9130	.058" (1,5 mm)	108-9143	.48" (12,2 mm)	X	X
5.75" (146,0 mm)	.28" (7,1 mm)	.46" (11,7 mm)	108-9132	.058" (1,5 mm)	-	-	-	-
5.75" (146,0 mm)	.41" (10,3 mm)	.56" (14,2 mm)	108-9133	.058" (1,5 mm)	108-9147	.38" (9,7 mm)	X*	X
5.75" (146,0 mm)	.53" (13,4 mm)	.66" (16,8 mm)	108-9134	.058" (1,5 mm)	108-9149	.48" (12,2 mm)	X*	X
TITAN HOLLOW EXT. TAPER					TITAN MAX HOLLOW EXT. TAPER			
5.75" (146,0 mm)	.53" (13,4 mm)	.66" (16,8 mm)	114-0551	.058" (1,5 mm)	114-0553	.47" (12,0 mm)	X*	X
TITAN SIDE EJECT					TITAN MAX SIDE EJECT			
4.75" (120,6 mm)	.28" (7,1 mm)	.46" (11,7 mm)	108-9159	.058" (1,5 mm)	108-9170	.28" (7,1 mm)	X	-
4.75" (120,6 mm)	.41" (10,3 mm)	.56" (14,2 mm)	108-9160	.058" (1,5 mm)	108-9172	.38" (9,7 mm)	X	-
4.75" (120,6 mm)	.53" (13,4 mm)	.66" (16,8 mm)	108-9161	.058" (1,5 mm)	108-9174	.48" (12,2 mm)	X	-
5.75" (146,0 mm)	.28" (7,1 mm)	.46" (11,7 mm)	108-9163	.058" (1,5 mm)	108-9176	.28" (7,1 mm)	-	X
5.75" (146,0 mm)	.41" (10,3 mm)	.56" (14,2 mm)	108-9164	.058" (1,5 mm)	108-9178	.38" (9,7 mm)	-	X
5.75" (146,0 mm)	.53" (13,4 mm)	.66" (16,8 mm)	108-9165	.058" (1,5 mm)	108-9180	.47" (12,2 mm)	-	X
TITAN SIDE EJECT EXT. TAPER					TITAN MAX SIDE EJECT EXT. TAPER			
5.75" (146,0 mm)	.53" (13,4 mm)	.66" (16,8 mm)	114-0555	.058" (1,5 mm)	114-0557	.47" (12,0 mm)	-	X
TITAN FAIRWAY HD								
5.75" (146,0 mm)	.51" (12,95 mm)	.77" (19,6 mm)	108-9260	.120" (3,0 mm)	-	-	X*	X
5.75" (146,0 mm)	.51" (12,95 mm)	.88" (22,4 mm)	108-9261	.120" (3,0 mm)	-	-	X*	X
TITAN FAIRWAY								
5.75" (146,0 mm)	.51" (12,95 mm)	.77" (19,6 mm)	104-9876	.120" (3,0 mm)	-	-	-	X
5.75" (146,0 mm)	.51" (12,95 mm)	.88" (22,4 mm)	104-9875	.120" (3,0 mm)	-	-	-	X
CLASSIC								
4.75" (120,6 mm)	.40" (10,2 mm)	.50" (12,7 mm)	66-9140	.049" (1,2 mm)	-	-	X	X
4.75" (120,6 mm)	.50" (12,7 mm)	.63" (15,9 mm)	59-3670	.049" (1,2 mm)	-	-	X	X
5.75" (146,0 mm)	.51" (12,9 mm)	.63" (15,9 mm)	104-0984	.058" (1,5 mm)	-	-	X*	X
TITAN SOLID ROUND								
4.50" (114,3 mm)	-	.25" (6,3 mm)	108-9198	-	-	-	X	X
4.50" (114,3 mm)	-	.30" (7,6 mm)	108-9199	-	-	-	X	X
4.50" (114,3 mm)	-	.35" (8,9 mm)	108-9200	-	-	-	X	X
4.50" (114,3 mm)	-	.40" (10,2 mm)	108-9201	-	-	-	X	X
4.50" (114,3 mm)	-	.50" (12,7 mm)	108-9202	-	-	-	X	X
4.50" (114,3 mm)	-	.60" (15,2 mm)	108-9203	-	-	-	X	X
5.50" (139,7 mm)	-	.25" (6,3 mm)	108-9204	-	-	-	X*	X
5.50" (139,7 mm)	-	.30" (7,6 mm)	108-9205	-	-	-	X*	X
5.50" (139,7 mm)	-	.35" (8,9 mm)	108-9206	-	-	-	X*	X
5.50" (139,7 mm)	-	.40" (10,2 mm)	108-9207	-	-	-	X*	X
5.50" (139,7 mm)	-	.50" (12,7 mm)	108-9208	-	-	-	X*	X
5.50" (139,7 mm)	-	.60" (15,2 mm)	108-9209	-	-	-	X*	X
5.50" (139,7 mm)	-	.75" (19,0 mm)	108-9244	-	-	-	X*	X

*Only available on GA 30/60 models

TITAN® TINES COMPETITIVE MODELS

3/4" (19.05 MM) MOUNT – CONTINUED					TITAN® Max		Competitive Model	
Length	Core Dia. (ID)	OD	Part Number	Wall	Part Number	Core Dia. (ID)	Ryan® GA 24/30/60	John Deere®
TITAN SOLID SLICING								
4.50" (114,3 mm)	-	.75" (19,0 mm)	108-9239	-	-	-	X	X
5.50" (139,7 mm)	-	.75" (19,0 mm)	108-9240	-	-	-	X*	X
TITAN CROSS					TITAN MAX CROSS			
4.50" (114,3 mm)	-	.50" (12,7 mm)	108-9221	-	-	-	X	X
4.50" (114,3 mm)	-	.75" (19,0 mm)	108-9223	-	-	-	X	X
5.50" (139,7 mm)	-	.50" (12,7 mm)	108-9224	-	112-1313	-	X*	X
5.50" (139,7 mm)	-	.75" (19,0 mm)	108-9226	-	-	-	X*	X
TITAN HOLLOW					TITAN MAX HOLLOW			
4.75" (120,6 mm)	.51" (13,0 mm)	.66" (16,8 mm)	108-9190	.058" (1,5 mm)	-	-	X*	X
4.75" (120,6 mm)	.63" (16,0 mm)	.76" (19,3 mm)	108-9191	.058" (1,5 mm)	-	-	X*	X
5.75" (146,0 mm)	.51" (13,0 mm)	.66" (16,8 mm)	108-9192	.058" (1,5 mm)	108-9157	.48" (12,2 mm)	X*	X
5.75" (146,0 mm)	.63" (16,0 mm)	.76" (19,3 mm)	108-9193	.058" (1,5 mm)	-	-	X*	X
TITAN SIDE EJECT					TITAN MAX SIDE EJECT			
4.75" (120,6 mm)	.51" (13,0 mm)	.66" (16,8 mm)	108-9194	.058" (1,5 mm)	-	-	X*	X
4.75" (120,6 mm)	.63" (16,0 mm)	.76" (19,3 mm)	108-9195	.058" (1,5 mm)	-	-	X*	X
5.75" (146,0 mm)	.51" (13,0 mm)	.66" (16,8 mm)	108-9196	.058" (1,5 mm)	108-9188	.48" (12,2 mm)	X*	X
5.75" (146,0 mm)	.63" (16,0 mm)	.76" (19,3 mm)	108-9197	.058" (1,5 mm)	-	-	X*	X
TITAN FAIRWAY HD								
5.75" (146,0 mm)	.640" (16,3 mm)	.88" (22,2 mm)	108-9264	.122" (3,1 mm)	-	-	X*	X
5.75" (146,0 mm)	.640" (16,3 mm)	1.0" (25,4 mm)	108-9265	.122" (3,1 mm)	-	-	X*	X
TITAN FAIRWAY								
4.75" (120,6 mm)	16,3 mm (.640")	.88" (22,2 mm)	92-7941	.122" (3,1 mm)	-	-	X	X
5.75" (146,0 mm)	16,3 mm (.640")	.88" (22,2 mm)	92-7900	.122" (3,1 mm)	-	-	X*	X
5.75" (146,0 mm)	16,3 mm (.640")	1.0" (25,4 mm)	104-9877	.120" (3,0 mm)	-	-	X*	X
CLASSIC								
4.75" (120,6 mm)	.60" (15,2 mm)	.75" (19,0 mm)	62-4600	.065" (1,7 mm)	-	-	X*	X
5.75" (146,0 mm)	.60" (15,2 mm)	.75" (19,0 mm)	86-9720	.065" (1,7 mm)	-	-	X*	X
TITAN SOLID ROUND								
5.50" (139,7 mm)	-	.75" (19,0 mm)	108-9246	-	-	-	X*	X
5.50" (139,7 mm)	-	.88" (22,2 mm)	108-9247	-	-	-	X*	X
TITAN SOLID SLICING								
5.50" (139,7 mm)	-	.75" (19,0 mm)	108-9242	-	-	-	X*	X
TITAN CROSS								
5.50" (139,7 mm)	-	.88" (22,2 mm)	108-9259	-	-	-	X*	X

*Only available on GA 30/60 models

QUICK REFERENCE

Mount	Length	ID	OD	Wall Thickness	Part Number	Titan® Max Part Number
TITAN Quad and Max Quad						
1/2" (12,7 mm)	4.50" (114,3 mm)	.32" (8,3 mm)	.46" (11,6 mm)	.063" (1,6 mm)	112-1316	-
3/8" (9,5 mm)	4.50" (114,3 mm)	.25" (6,3 mm)	.36" (9,1 mm)	.052" (1,3 mm)	108-9104	108-9112
3/8" (9,5 mm)	4.50" (114,3 mm)	.32" (8,1 mm)	.46" (11,6 mm)	.063" (1,6 mm)	108-9105	108-9114
3/8" (9,5 mm)	4.50" (114,3 mm)	.41" (10,3 mm)	.55" (13,9 mm)	.063" (1,6 mm)	108-9106	108-9116
3/8" (9,5 mm)	4.50" (114,3 mm)	.48" (12,2 mm)	.58" (14,7 mm)	.049" (1,2 mm)	108-9293	-
3/8" (9,5 mm)	5.00" (127,0 mm)	.25" (6,3 mm)	.55" (14,0 mm)	.052" (1,3 mm)	138-5937	108-9120
3/8" (9,5 mm)	5.00" (127,0 mm)	.32" (8,1 mm)	.46" (11,6 mm)	.063" (1,6 mm)	137-6526	108-9122
3/8" (9,5 mm)	5.00" (127,0 mm)	.41" (10,3 mm)	.55" (13,9 mm)	.063" (1,6 mm)	137-6527	108-9124
3/8" (9,5 mm)	5.00" (127,0 mm)	.48" (12,2 mm)	.58" (14,7 mm)	.049" (1,2 mm)	137-6529	-
3/8" (9,5 mm)	5.50" (139,7 mm)	.41" (10,3 mm)	.58" (14,7 mm)	.063" (1,6 mm)	108-9290	-
5/8" (15,9 mm)	4.50" (114,3 mm)	.32" (8,1 mm)	.46" (11,6 mm)	.063" (1,6 mm)	112-1332	112-1338

TITAN Hollow and Max Hollow

3/4" (19,0 mm)	4.75" (120,6 mm)	.28" (7,1 mm)	.46" (11,7 mm)	.058" (1,5 mm)	108-9128	108-9139
3/4" (19,0 mm)	4.75" (120,6 mm)	.41" (10,3 mm)	.56" (14,2 mm)	.058" (1,5 mm)	108-9129	108-9141
3/4" (19,0 mm)	4.75" (120,6 mm)	.53" (13,4 mm)	.66" (16,8 mm)	.058" (1,5 mm)	108-9130	108-9143
3/4" (19,0 mm)	5.75" (146,0 mm)	.28" (7,1 mm)	.46" (11,7 mm)	.058" (1,5 mm)	108-9132	-
3/4" (19,0 mm)	5.75" (146,0 mm)	.41" (10,3 mm)	.56" (14,2 mm)	.058" (1,5 mm)	108-9133	108-9147
3/4" (19,0 mm)	5.75" (146,0 mm)	.53" (13,4 mm)	.66" (16,8 mm)	.058" (1,5 mm)	108-9134	108-9149
3/4" (19,0 mm)	6.50" (165,1 mm)	.28" (7,1 mm)	.46" (11,7 mm)	.058" (1,5 mm)	108-9138	108-9135
3/4" (19,0 mm)	6.50" (165,1 mm)	.41" (10,3 mm)	.56" (14,2 mm)	.058" (1,5 mm)	108-9136	108-9151
3/4" (19,0 mm)	6.50" (165,1 mm)	.53" (13,4 mm)	.66" (16,8 mm)	.058" (1,5 mm)	108-9137	108-9153
7/8" (22,2 mm)	4.75" (120,6 mm)	.51" (13,0 mm)	.66" (16,8 mm)	.058" (1,5 mm)	108-9190	-
7/8" (22,2 mm)	4.75" (120,6 mm)	.63" (16,0 mm)	.76" (19,3 mm)	.058" (1,5 mm)	108-9191	-
7/8" (22,2 mm)	5.75" (146,0 mm)	.51" (13,0 mm)	.66" (16,8 mm)	.058" (1,5 mm)	108-9192	-
7/8" (22,2 mm)	5.75" (146,0 mm)	.63" (16,0 mm)	.76" (19,3 mm)	.058" (1,5 mm)	108-9193	-

TITAN Hollow Extended Taper and Max Extended Taper

3/4" (19,0 mm)	5.75" (146,0 mm)	.47" (11,9 mm)	.68" (17,3 mm)	.058" (1,5 mm)	114-0553	-
3/4" (19,0 mm)	5.75" (146,0 mm)	.53" (13,4 mm)	.66" (16,8 mm)	.058" (1,5 mm)	114-0551	114-0553
3/4" (19,0 mm)	6.50" (165,1 mm)	.53" (13,4 mm)	.66" (16,8 mm)	.058" (1,5 mm)	114-0550	-

TITAN Side Eject and Max Side Eject

3/4" (19,0 mm)	4.75" (120,6 mm)	.28" (7,1 mm)	.46" (11,7 mm)	.058" (1,5 mm)	108-9159	108-9170
3/4" (19,0 mm)	4.75" (120,6 mm)	.41" (10,3 mm)	.56" (14,2 mm)	.058" (1,5 mm)	108-9160	108-9172
3/4" (19,0 mm)	4.75" (120,6 mm)	.53" (13,4 mm)	.66" (16,8 mm)	.058" (1,5 mm)	108-9161	108-9174
3/4" (19,0 mm)	5.75" (146,0 mm)	.28" (7,1 mm)	.46" (11,7 mm)	.058" (1,5 mm)	108-9163	108-9176
3/4" (19,0 mm)	5.75" (146,0 mm)	.41" (10,3 mm)	.56" (14,2 mm)	.058" (1,5 mm)	108-9164	108-9178
3/4" (19,0 mm)	5.75" (146,0 mm)	.53" (13,4 mm)	.66" (16,8 mm)	.058" (1,5 mm)	108-9165	108-9180
3/4" (19,0 mm)	6.50" (165,1 mm)	.28" (7,1 mm)	.46" (11,7 mm)	.058" (1,5 mm)	108-9162	108-9166
3/4" (19,0 mm)	6.50" (165,1 mm)	.41" (10,3 mm)	.56" (14,2 mm)	.058" (1,5 mm)	108-9167	108-9182
3/4" (19,0 mm)	6.50" (165,1 mm)	.53" (13,4 mm)	.66" (16,8 mm)	.058" (1,5 mm)	108-9168	108-9184
5/8" (15,9 mm)	4.50" (114,3 mm)	.43" (12,7 mm)	.56" (14,2 mm)	.058" (1,5 mm)	112-1303	-
7/8" (22,2 mm)	4.75" (120,6 mm)	.51" (13,0 mm)	.66" (16,8 mm)	.058" (1,5 mm)	108-9194	-
7/8" (22,2 mm)	4.75" (120,6 mm)	.63" (16,0 mm)	.76" (19,3 mm)	.058" (1,5 mm)	108-9195	-
7/8" (22,2 mm)	5.75" (146,0 mm)	.51" (13,0 mm)	.66" (16,8 mm)	.058" (1,5 mm)	108-9196	108-9188
7/8" (22,2 mm)	5.75" (146,0 mm)	.63" (16,0 mm)	.76" (19,3 mm)	.058" (1,5 mm)	108-9197	-

TITAN Side Eject Extended Taper and Extended Taper Max

3/4" (19,0 mm)	5.75" (146,0 mm)	.53" (13,4 mm)	.66" (16,8 mm)	.058" (1,5 mm)	114-0555	114-0557
3/4" (19,0 mm)	6.50" (165,1 mm)	.53" (13,4 mm)	.66" (16,8 mm)	.058" (1,5 mm)	114-0558	114-0560

QUICK REFERENCE

Mount	Length	ID	OD	Wall Thickness	Part Number	Titan® Max Part Number
Toro Classic Hollow						
3/4" (19,0 mm)	4.75" (120,6 mm)	.40" (10,2 mm)	.50" (12,7 mm)	.049" (1,2 mm)	66-9140	-
3/4" (19,0 mm)	4.75" (120,6 mm)	.50" (12,7 mm)	.63" (15,9 mm)	.049" (1,2 mm)	59-3670	-
3/4" (19,0 mm)	5.75" (146,0 mm)	.51" (12,9 mm)	.63" (15,9 mm)	.058" (1,5 mm)	104-0984	-
3/4" (19,0 mm)	6.50" (165,1 mm)	.39" (9,9 mm)	.66" (16,8 mm)	.058" (1,5 mm)	105-1180	-
7/8" (22,2 mm)	4.75" (120,6 mm)	.60" (15,2 mm)	.75" (19,0 mm)	.065" (1,7 mm)	62-4600	-
7/8" (22,2 mm)	5.75" (146,0 mm)	.60" (15,2 mm)	.75" (19,0 mm)	.065" (1,7 mm)	86-9720	-

TITAN Fairway

3/4" (19,0 mm)	5.75" (146,0 mm)	.51" (12,9 mm)	.77" (19,6 mm)	.120" (3,0 mm)	104-9876	-
3/4" (19,0 mm)	5.75" (146,0 mm)	.51" (12,9 mm)	.88" (22,4 mm)	.120" (3,0 mm)	104-9875	-
7/8" (22,2 mm)	4.75" (120,6 mm)	.64" (16,1 mm)	.88" (22,4 mm)	.122" (3,1 mm)	92-7941	-
7/8" (22,2 mm)	5.75" (146,0 mm)	.64" (16,1 mm)	.88" (22,4 mm)	.122" (3,1 mm)	92-7900	-
7/8" (22,2 mm)	5.75" (146,0 mm)	.64" (16,1 mm)	1.0" (25,4 mm)	.120" (3,0 mm)	104-9877	-

TITAN HD Fairway

3/4" (19,0 mm)	5.75" (146,0 mm)	.51" (12,95 mm)	.77" (19,6 mm)	.120" (3,0 mm)	108-9260	-
3/4" (19,0 mm)	5.75" (146,0 mm)	.51" (12,95 mm)	.88" (22,4 mm)	.120" (3,0 mm)	108-9261	-
7/8" (22,2 mm)	5.75" (146,0 mm)	.64" (16,1 mm)	.88" (22,4 mm)	.122" (3,1 mm)	108-9264	-
7/8" (22,2 mm)	5.75" (146,0 mm)	.64" (16,1 mm)	1.0" (25,4 mm)	.122" (3,1 mm)	108-9265	-

TITAN Split Tine

3/4" (19,0 mm)	5.75" (146,0 mm)	.51" (12,95 mm)	.88" (22,4 mm)	.120" (3,0 mm)	112-5121	-
7/8" (22,2 mm)	5.75" (146,0 mm)	.64" (16,1 mm)	.88" (22,4 mm)	.120" (3,0 mm)	112-5122	-
7/8" (22,2 mm)	5.75" (146,0 mm)	.64" (16,1 mm)	.92" (23,4 mm)	.120" (3,0 mm)	112-5123	-

TITAN Solid Round

1/2" (12,7 mm)	4.50" (114,3 mm)	-	.50" (12,7 mm)	-	112-1347	-
1/2" (12,7 mm)	5.00" (127,0 mm)	-	.25" (6,3 mm)	-	112-1329	-
3/4" (19,0 mm)	4.50" (114,3 mm)	-	.25" (6,3 mm)	-	108-9198	-
3/4" (19,0 mm)	4.50" (114,3 mm)	-	.30" (7,6 mm)	-	108-9199	-
3/4" (19,0 mm)	4.50" (114,3 mm)	-	.35" (8,9 mm)	-	108-9200	-
3/4" (19,0 mm)	4.50" (114,3 mm)	-	.40" (10,2 mm)	-	108-9201	-
3/4" (19,0 mm)	4.50" (114,3 mm)	-	.50" (12,7 mm)	-	108-9202	-
3/4" (19,0 mm)	4.50" (114,3 mm)	-	.60" (15,2 mm)	-	108-9203	-
3/4" (19,0 mm)	5.50" (139,7 mm)	-	.25" (6,3 mm)	-	108-9204	-
3/4" (19,0 mm)	5.50" (139,7 mm)	-	.30" (7,6 mm)	-	108-9205	-
3/4" (19,0 mm)	5.50" (139,7 mm)	-	.35" (8,9 mm)	-	108-9206	-
3/4" (19,0 mm)	5.50" (139,7 mm)	-	.40" (10,2 mm)	-	108-9207	-
3/4" (19,0 mm)	5.50" (139,7 mm)	-	.50" (12,7 mm)	-	108-9208	-
3/4" (19,0 mm)	5.50" (139,7 mm)	-	.60" (15,2 mm)	-	108-9209	-
3/4" (19,0 mm)	5.50" (139,7 mm)	-	.75" (19,0 mm)	-	108-9244	-
3/4" (19,0 mm)	6.50" (165,1 mm)	-	.30" (7,6 mm)	-	108-9210	-
3/4" (19,0 mm)	6.50" (165,1 mm)	-	.35" (8,9 mm)	-	108-9211	-
3/4" (19,0 mm)	6.50" (165,1 mm)	-	.40" (10,2 mm)	-	108-9212	-
3/4" (19,0 mm)	6.50" (165,1 mm)	-	.50" (12,7 mm)	-	108-9213	-
3/4" (19,0 mm)	6.50" (165,1 mm)	-	.60" (15,2 mm)	-	108-9214	-
3/4" (19,0 mm)	6.50" (165,1 mm)	-	.75" (19,0 mm)	-	108-9245	-
3/8" (9,5 mm)	4.50" (114,3 mm)	-	.20" (5,1 mm)	-	108-9230	-
3/8" (9,5 mm)	4.50" (114,3 mm)	-	.25" (6,3 mm)	-	108-9231	-
3/8" (9,5 mm)	4.50" (114,3 mm)	-	.30" (7,6 mm)	-	108-9232	-
3/8" (9,5 mm)	4.50" (114,3 mm)	-	.38" (9,7 mm)	-	108-9233	-
3/8" (9,5 mm)	5.50" (139,7 mm)	-	.20" (5,1 mm)	-	108-9234	-
3/8" (9,5 mm)	5.50" (139,7 mm)	-	.25" (6,3 mm)	-	108-9235	-
3/8" (9,5 mm)	5.50" (139,7 mm)	-	.30" (7,6 mm)	-	108-9236	-
3/8" (9,5 mm)	5.50" (139,7 mm)	-	.38" (9,7 mm)	-	108-9237	-
5/8" (15,9 mm)	4.50" (114,3 mm)	-	.63" (15,9 mm)	-	112-1348	-
7/8" (22,2 mm)	5.50" (139,7 mm)	-	.75" (19,0 mm)	-	108-9246	-
7/8" (22,2 mm)	5.50" (139,7 mm)	-	.88" (22,2 mm)	-	108-9247	-
7/8" (22,2 mm)	6.50" (165,1 mm)	-	.75" (19,0 mm)	-	108-9248	-
7/8" (22,2 mm)	6.50" (165,1 mm)	-	.88" (22,2 mm)	-	108-9249	-

QUICK REFERENCE

Mount	Length	ID	OD	Wall Thickness	Part Number	Titan® Max Part Number
<i>TITAN Solid Slicing</i>						
1/2" (12,7 mm)	5.00" (127,0 mm)	-	.63" (15,9 mm)	-	112-5102	-
3/4" (19,0 mm)	4.50" (114,3 mm)	-	.75" (19,0 mm)	-	108-9239	-
3/4" (19,0 mm)	5.50" (139,7 mm)	-	.75" (19,0 mm)	-	108-9240	-
3/4" (19,0 mm)	6.50" (165,1 mm)	-	.75" (19,0 mm)	-	108-9241	-
3/8" (9,5 mm)	5.00" (127,0 mm)	-	.63" (15,9 mm)	-	108-9238	-
5/8" (15,9 mm)	5.00" (127,0 mm)	-	.63" (15,9 mm)	-	112-5103	-
7/8" (22,2 mm)	5.50" (139,7 mm)	-	.75" (19,0 mm)	-	108-9242	-
7/8" (22,2 mm)	6.50" (165,1 mm)	-	.75" (19,0 mm)	-	108-9243	-

TITAN Cross and Max Cross

3/4" (19,0 mm)	4.50" (114,3 mm)	-	.50" (12,7 mm)	-	108-9221	-
3/4" (19,0 mm)	4.50" (114,3 mm)	-	.75" (19,0 mm)	-	108-9223	-
3/4" (19,0 mm)	5.50" (139,7 mm)	-	.50" (12,7 mm)	-	108-9224	112-1313
3/4" (19,0 mm)	5.50" (139,7 mm)	-	.75" (19,0 mm)	-	108-9226	-
3/4" (19,0 mm)	6.50" (165,1 mm)	-	.50" (12,7 mm)	-	108-9227	112-1314
3/4" (19,0 mm)	6.50" (165,1 mm)	-	.62" (15,7 mm)	-	108-9228	-
3/4" (19,0 mm)	6.50" (165,1 mm)	-	.75" (19,0 mm)	-	108-9229	-
3/8" (9,5 mm)	4.50" (114,3 mm)	-	.38" (9,5 mm)	-	108-9215	-
3/8" (9,5 mm)	4.50" (114,3 mm)	-	.50" (12,7 mm)	-	108-9216	112-1310
3/8" (9,5 mm)	4.50" (114,3 mm)	-	.62" (15,7 mm)	-	108-9217	-
3/8" (9,5 mm)	5.50" (139,7 mm)	-	.38" (9,5 mm)	-	108-9218	-
3/8" (9,5 mm)	5.50" (139,7 mm)	-	.50" (12,7 mm)	-	108-9219	112-1311
3/8" (9,5 mm)	5.50" (139,7 mm)	-	.62" (15,7 mm)	-	108-9220	-
7/8" (22,2 mm)	5.50" (139,7 mm)	-	.88" (22,2 mm)	-	108-9259	-

TITAN Needle

Needle	6.43" (163,3 mm)	-	.188" (4,8 mm)	-	100-3620	-
Needle	7.38" (187,45 mm)	-	.313" (7,9 mm)	-	100-3621	-
Needle	5.43" (137,9 mm)	-	5,0 mm	-	100-3319	-

QUICK REFERENCE

Mount	Length	ID	OD	Wall Thickness	Part Number	Titan® Max Part Number
<i>ProCore SR Series Deep Tine Aerators</i>						
5/16" (7,9 mm)	10.00" (254,0 mm)	-	.31" (7,9 mm)	-	SGS08313	-
5/16" (7,9 mm)	8.50" (215,9 mm)	-	.31" (7,9 mm)	-	SGS07313	-
12,0 mm	10.00" (254,0 mm)	.56" (14,2 mm)	.75" (19,0 mm)	-	139-8620	-
12,0 mm	10.00" (254,0 mm)	.56" (14,2 mm)	.75" (19,0 mm)	-	139-8624	-
12,0 mm	10.00" (254,0 mm)	.56" (14,2 mm)	.81" (20,6 mm)	-	139-8613	-
12,0 mm	10.75" (273,1 mm)	-	.47" (12,0 mm)	-	SGS10504	-
12,0 mm	12.25" (311,2 mm)	-	.47" (12,0 mm)	-	SGS10500	-
12,0 mm	14.25" (361,9 mm)	-	.47" (12,0 mm)	-	SGS12500	-
12,0 mm	16.25" (412,8 mm)	-	.47" (12,0 mm)	-	SGS14500	-
12,0 mm	7.00" (177,8 mm)	.52" (13,2 mm)	.69" (17,4 mm)	-	139-8623	-
12,0 mm	7.00" (177,8 mm)	.52" (13,2 mm)	.69" (17,4 mm)	-	139-8614	-
12,0 mm	7.00" (177,8 mm)	.56" (14,2 mm)	.81" (20,7 mm)	-	139-8625	-
12,0 mm	7.00" (177,8 mm)	.56" (14,2 mm)	.81" (20,7 mm)	-	139-8615	-
12,0 mm	8.00" (203,2 mm)	-	.47" (12,0 mm)	-	SGS08500	-
18,0 mm	10.00" (254,0 mm)	.56" (14,2 mm)	.75" (19,0 mm)	-	139-8623	-
18,0 mm	10.00" (254,0 mm)	.74" (18,8 mm)	1.06" (26,9 mm)	-	139-8617	-
18,0 mm	10.00" (254,0 mm)	.76" (19,3 mm)	1.00" (25,4 mm)	-	139-8619	-
18,0 mm	12.00" (304,8 mm)	.94" (23,9 mm)	1.31" (33,3 mm)	-	139-8627	-
18,0 mm	12.25" (311,2 mm)	-	.71" (18,0 mm)	-	SGS10750	-
18,0 mm	12.50" (317,5 mm)	-	.88" (22,2 mm)	-	SGS10875	-
18,0 mm	14.00" (355,6 mm)	-	.88" (22,2 mm)	-	SGS12875	-
18,0 mm	14.25" (361,9 mm)	-	.71" (18,0 mm)	-	SGS12750	-
18,0 mm	16.00" (406,4 mm)	-	.88" (22,2 mm)	-	SGS14875	-
18,0 mm	16.25" (412,8 mm)	-	.71" (18,0 mm)	-	SGS14750	-
18,0 mm	8.00" (203,2 mm)	.74" (18,8 mm)	1.06" (26,9 mm)	-	139-8628	-
18,0 mm	8.00" (203,2 mm)	.94" (23,9 mm)	1.31" (33,3 mm)	-	139-8622	--
3/8" (9,5 mm)	10.75" (273,1 mm)	-	.38" (9,5 mm)	-	SGS10374	-
3/8" (9,5 mm)	12.25" (311,2 mm)	-	.38" (9,5 mm)	-	SGS10375	-
3/8" (9,5 mm)	5.50" (139,7 mm)	.38" (9,5 mm)	.50" (12,7 mm)	-	139-8618	-
3/8" (9,5 mm)	9.00" (228,6 mm)	-	.38" (9,5 mm)	-	SGS08375	-
7/8" (22,2 mm)	12.00" (304,8 mm)	.94" (23,9 mm)	1.31" (33,3 mm)	-	139-8621	-
7/8" (22,2 mm)	12.50" (317,5 mm)	-	.88" (22,2 mm)	-	SGS10876	-
7/8" (22,2 mm)	14.00" (355,6 mm)	-	.88" (22,2 mm)	-	SGS12876	-
7/8" (22,2 mm)	17.88" (454,2 mm)	-	1.00" (25,4 mm)	-	SGS16100	-
7/8" (22,2 mm)	8.00" (203,2 mm)	.94" (23,9 mm)	1.31" (33,3 mm)	-	139-8626	-



TORO PROTECTION PLUS™

EXTENDED PROTECTION PLAN

Run Your Maintenance Budget at Peak Efficiency

The Toro Protection Plus™ (TPP) Extended Protection Plan eliminates the hit your maintenance budget can take when the unforeseen happens. Coverage is available for new equipment, pre-owned equipment, and most Toro attachments and accessories. Just choose the plan that fits your needs.

\$0 deductible for parts & labor on covered repairs | Remaining coverage is transferrable if ownership changes



Learn More: [toro.com/tpp](https://www.toro.com/tpp)



PROTECT YOUR INVESTMENT. KEEP IT 100% TORO®.

OUR PROMISE TO YOU

To best protect your investment and maintain optimal performance of your turf equipment, count on Toro genuine parts. When it comes to reliability, Toro delivers replacement parts designed to the exact engineering specifications of our equipment. For peace of mind, insist on Toro genuine parts.

TORO PROVIDES:

- **Industry Leading Fill Rates** – Your local channel partner, supported by Toro's parts network, offers the parts you need when you need them.
- **Part Availability** – Most local channel partners deliver parts within 24 hours. Toro backs this promise with 48-hour delivery support.
- **Competitive Pricing** – Toro parts are comparable to will-fit providers.
- **Quality** – Genuine Toro service parts are the same parts used on the original equipment, ensuring maximum performance with less downtime.
- **Unparalleled Customer Service** – Count on dedicated support for your Toro parts needs.
- **Peace of Mind** – With genuine Toro parts, you get the right part with the correct specifications. There's no need to wonder if the part will work.

www.toro.com



WHEN WE SAY COUNT ON IT, WE MEAN IT

Every product that carries the Toro brand is backed by over 100 years of history, innovation and timeless dependability. We never stop investing in research and development to give our customers the latest features. That's why Toro is one of the best-known, most trusted brands in the business. We also stand behind our products with a global network of knowledgeable dealers for parts and service support.

Real People. Real Support.

Smart Features. Proven Dependability.



Count on it.

LEARN MORE

CONTACT US AT: **800-803-8676**
OR VISIT US AT: **toro.com**

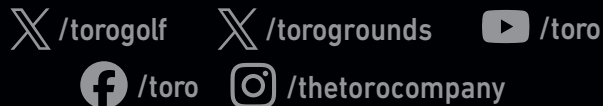

©2025 The Toro Company, Bloomington, MN 55420 All rights reserved.
All other trademarks are property of their respective owners. Printed in the USA.

Part Number 25-112-T

Products depicted in this literature are for demonstration purposes only. Actual products offered for sale may vary in use, design, required attachments and safety features. We reserve the right to improve our products and make changes in specifications, design and standard equipment without notice and without incurring obligation. See your distributor for details on all our warranties.