



25.4cc Blower Vac **25.4cc Blower only**

Model No 101PBV26

Model No 101PB26

Operator's Manual



WARNING:

To reduce the risk of injury, the user must read and understand the operator's manual.
Save this manual.

Contents

Introduction	4
Safety Rules	5
Symbols	6
Specifications	7
Applications	7
Features	8
Unpacking	9
Assembly	10
Operation	11
Starting the Product	12, 13
Stopping the Engine	14
Throttle Settings	14
Blower / Vacuum Functions	15
Maintenance	16, 17, 18, 19
Storing the Product	20
Troubleshooting	21, 22
Warranty	23

READ THIS INFORMATION



Before you use your new petrol blower/vac, read this manual carefully to learn how to operate and maintain your product correctly. Reading this manual will help you and others avoid personal injury and damage to the product. Although Pope designs safe state-of-the-art products, you are responsible for using the product properly and safely. You are also responsible for training persons you allow to use the product about safe operation.

Introduction

Thank you for purchasing this Pope® product.

These Pope products have been designed and built to deliver superior performance and reliability without compromise to quality, comfort, safety or durability.

The high performance engine represents the leading edge of 2 stroke engine technology, delivering exceptionally high power at remarkably low displacement and weight. As an owner/operator, you'll soon discover why these products are in a class by themselves.

The information contained in this manual describes machines available at the time of printing. While every attempt has been made to give you the very latest information about your blower/vac, there may be some differences between your machine and what is described here. Pope reserves the right to make changes to production without prior notice and without obligation to make alterations to machines previously manufactured.

Before using this product, consult local regulation concerning noise restrictions and hours of operation.

We would like you to be completely satisfied with your new product, so feel free to contact an authorized service dealer listed at the back of this manual, for help with service, genuine Pope parts or other information you may require. Or phone the Pope Customer Service Centre for details of your nearest dealer on 1300 134 880.

The Pope warning system in this manual identifies potential hazards and special safety messages that help you and others avoid personal injury, even death. DANGER, WARNING and CAUTION are signal words that identify the level of hazard. However, regardless of the hazard, be extremely careful. Two other words "Important" and "Note" highlight other valuable information.

Signal Word	Explanation
DANGER	Indicates an imminently hazardous situation which, if not avoided, will result in death or serious injury.
WARNING	Indicates a potentially hazardous situation which, if not avoided, could result in death or serious injury.
CAUTION	Indicates a potentially hazardous situation which if not avoided, could result in death or serious injury.
Important	Advises you of important information or instructions vital to the operation or maintenance of the equipment.
Note	Advises you of additional information concerning the operation or maintenance of the equipment.

Safety Rules



WARNING:

Read and understand all instructions. Failure to follow all instructions may result in serious personal injury as well as damage to product.

■ **Physical Condition of the Operator.**

Do not operate this product when tired, ill or under the influence of alcohol, drugs or medication.

■ **Clothing Requirements.** Always wear long heavy pants, boots and gloves. Do not wear loose clothing, jewellery, short pants, sandals or go barefoot. Secure hair so that it is above shoulder level to avoid entanglement in moving parts.

■ **Protective Accessories Requirements.**

Wear safety eye protection when operating this product. Wear hearing protection during extended periods of operation.

■ **Condition of Product Before Use.**

Inspect the product before each use. Replace damaged parts. Check for fuel leaks. Make sure all fasteners are in place and secure.

■ **Proper Stance.** Keep firm footings and balance. Do not overreach.

■ **Exhaust Gases.** Never start or run the product inside a closed room or building: breathing exhaust fumes can cause illness or death.

■ **Fuelling.** Mix and pour fuel outdoors where there are no sparks or flames. Slowly remove the fuel cap only after stopping the engine. Do not smoke while fuelling or mixing fuel. Wipe spilled fuel from the product. Move at least 9m from the fuelling source and site before starting the engine.

■ **Dangerous Environments.** To avoid falling, do not use the product in damp or wet locations.

■ **Use the Right Product.** Use the product for the intended purpose only.

■ **Condition of Product before use.** The tubes and, where appropriate, catching bag shall be mounted according to the manufacturer's instructions. Failure to use the proper parts may cause product failure or increase the risk of injury to the user.





■ **Stopping the Product.** Ensure that you cool the engine by allowing it to idle for 2 - 3 minutes, then stop the engine by firmly depressing the OFF switch.

■ **Ensure covers are securely fastened before each use.** The impeller will rotate whenever the machine is operated. Never operate the machine unless the intake cover and machine tubes are properly installed and in good working order.

Save These Instructions

Symbols

The following symbols are located on the product. Please study them and learn their meaning. Proper interpretation of these symbols allows you to operate the product better and safely.

Symbol	Name	Explanation
	Safety Alert	Indicates danger, warning or caution. Attention is required in order to avoid serious personal injury. May be used in conjunction with other symbols or pictographs.
	Read Operator's Manual	Read the Operator's Manual before starting or operating this product. Failure to follow operating instructions and safety precautions in the Operator's Manual can result in serious injury.
	Eye and Ear Protection	Thrown objects can cause severe eye injury. Wear eye protection when operating this product. Wear hearing protection during extended periods of operation.
	Keep Hands Away From Moving Impeller	Keep your hands away from the moving impeller as this can result in serious injury.

Specifications

SPECIFICATION		
Model:	101PBV26	101PB26
Engine Size:	25.4cc full crank	25.4cc full crank
Fuel Mix:	25:1	25:1
Weight (dry with vacuum tubes):	6.3kg	4.7kg
Fuel Tank Capacity:	0.5 litre	0.5 litre
Maximum blower speed:	250 km/hr	250 km/hr
Average air volume:	7.8m ³ / min	N/A

Applications

Use the blower or blower vac for the following applications:

- Blowing leaves, grasses, light debris and other garden refuse away from garden areas or surfaces

Use the blower vac for these additional applications:

- Vacuuming leaves, grasses, light debris and other garden refuse from garden areas or surfaces into the debris collection bag
- Mulching leaves, grasses, debris and other garden refuse at a 10:1 ratio for efficient refuse management or redistribution of mulch around the garden. Items such as bones, stones, twigs and sticks, wire or other dense debris should be removed or damage may be caused to the product.

Features

Before using the product, familiarize yourself with all operating features and safety requirements. However, do not let familiarity with the product make you careless.



WARNING:

Exercise caution when using the product. Careless actions, for even a fraction of a second, can result in serious personal injury.

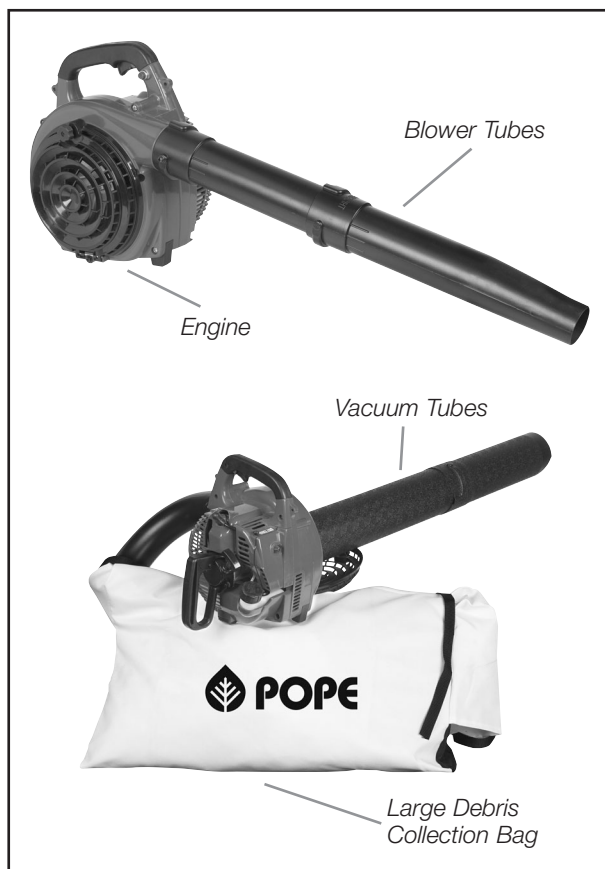

Your new Pope product is equipped with the following features.

Common Features

Engine

The engine is powerful and easy to start. It is effectively counterbalanced, which allows for less vibration and more durability.

Ergonomic Design

The design of the product provides for easy handling. It is designed for comfort and ease of grasp when operating in different positions and at different angles.

Blower Vac

Model No. 101PBV26

Blower and vacuum function

Equipped with specially designed tubes, the blower vac easily changes from blower to vacuum in only a few moments.

Mulching

The addition of a full metal impeller efficiently mulches garden waste and debris at a ratio of 10:1, which makes your garden waste easier to manage.

Large debris collection bag

Tough and sturdy, the debris collection bag can hold up to 55 litres of mulched garden debris.



WARNING:

Do not attempt to modify this product or create accessories not recommended for use with this product. Any such alteration or modification is misuse and could result in a hazardous condition leading to serious personal injury and will void your guarantee.

Blower

Model No. 101PB26

Adjustable speed blowing function

Vary the speed of your blower by depressing or easing off of the throttle. The blower can reach air speeds of up to 250 km/h.

Unpacking

Instructions

- Carefully remove the product from the box.
- Inspect the product carefully to make sure no breakage or damage occurred during shipping.
- Do not discard the packing material until you have carefully inspected and satisfactorily operated the product.
- If any parts are damaged or missing, please call 1300 134 880.



WARNING:

If any parts are missing, do not operate the product until the missing parts are replaced.
Failure to do so could result in serious personal injury.

Packing List for Petrol Blower Vac

Model No. 101PBV26 and

Petrol Blower

Model No. 101PB26

Engine

Blower Tubes (2)

Vacuum Elbow Tube (1) (101PBV26 only)

Vacuum Tubes (2) (101PBV26 only)

Fuel Mixing Bottle

Assembly Tools – 1 bag including:

- Spark plug wrench with Phillips Head screwdriver attachment (1)
- Allen Key (1)

Debris Collection Bag – 55 litre
(101PBV26 only)

Operator's Manual

Assembly

Assembling the vacuum function:

Model No. 101PBV26 only

Follow these steps to assemble the vacuum function.

1. Join the two vacuum tubes together.
2. Open the protective cover and install the tube, rotating the tube to lock in place.

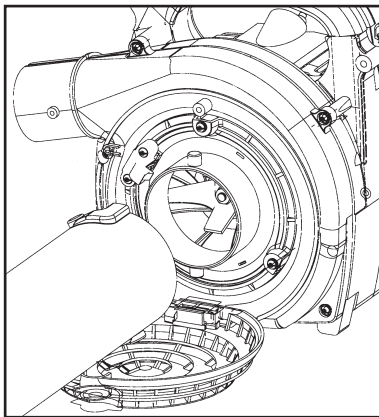

3. Push the vacuum elbow tube over the discharge port, rotating the tube clockwise to lock in place.

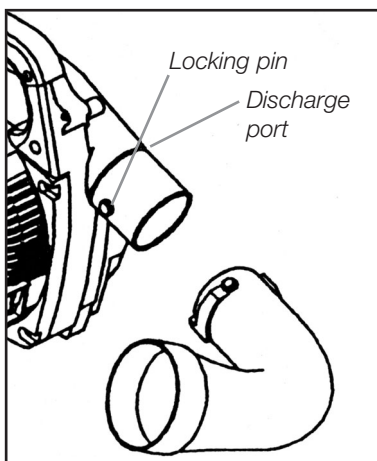

4. Use the screw to fix the vacuum elbow tube in place.
5. Fix the debris collection bag to the end of the elbow vacuum tube and tighten the velcro strap to secure bag.

Assembling the blower function:

1. Unscrew the locking screw from the blower port.
2. Push the straight tube over the discharge port and locking pin. Rotate clockwise to lock.
3. Ensure that the tube lines up with locking screw outlet on the blower port then re-affix the locking screw.
4. Push the nozzle tube over the straight tube and locking pin. Rotate clockwise to lock. The label "TOP" must face up.

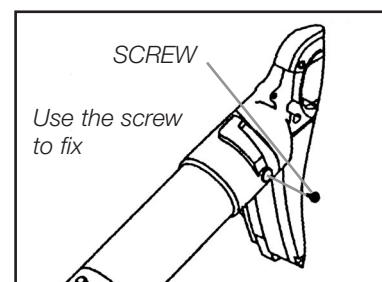
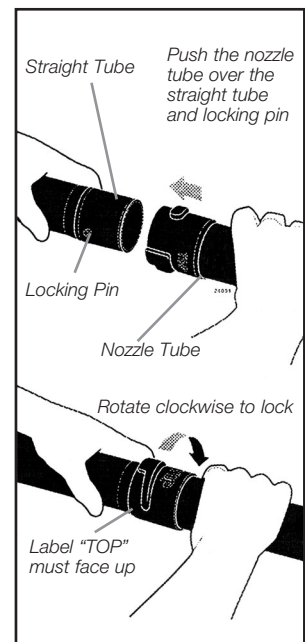
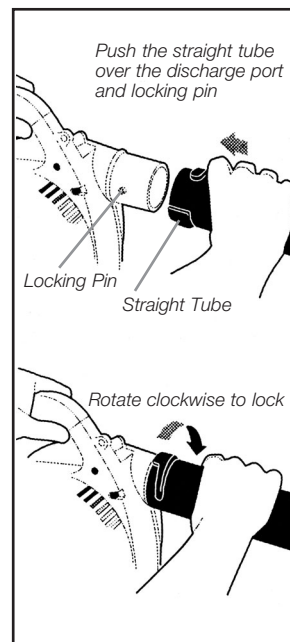

NOTE: Blower tube installation affects both blower balance and performance. The tube and nozzle are correctly installed when the label "TOP" is visible to the operator during use.

Operation

Mixing the fuel



DANGER:

Petrol is extremely flammable and explosive. A fire or explosion from petrol will burn you and others.

This product is powered by a 2 stroke engine and requires pre-mixing petrol and 2 stroke oil. The oil mix should be 25:1. Never mix petrol and oil directly in the engine tank.

Use unleaded petrol intended for motor vehicle use with an Octane rating of 87 ([R + M] / 2) or higher. Purchase fuel from a reputable fuel supplier.

Use the mixing container provided to mix the oil and petrol in the correct quantities.

Petrol	Oil
500 ml	20ml
1 litre	40ml
2 litres	80ml
3 litres	120ml
4 litres	160ml
5 litres	200ml

Mix only enough fuel for your immediate needs. Fuel should not be stored for more than 30 days.

Follow these steps to mix the fuel:

1. Use the container provided for mixing fuel.
2. Mix the 2 stroke engine oil with unleaded petrol in the container provided at the rate of 25 parts petrol to 1 part oil.
3. Mix the fuel thoroughly and also each time before re-fuelling.
4. Mix in small quantities. Do not mix more fuel than you expect to use within a 30 day period.
5. Store fuel only in a clean, safe, approved container for petrol – not the fuel mixing bottle provided.



+



=



25:1

Filling the Tank



WARNING:

Always stop the engine before filling the tank. Never add fuel to a machine with a running or hot engine. Move at least 9m away from the refuelling site before starting the engine. Do not smoke while filling the tank.

Follow these steps to fill the tank:

1. Clean the surface around the fuel tank to prevent contamination.
2. Loosen the fuel cap by turning it counter clockwise.
3. Pour the fuel mixture carefully into the tank.
4. Clean and inspect the gasket.
NOTE: Replace the fuel cap if the gasket is damaged.
5. Install the fuel cap and tighten it by turning it clockwise.



WARNING:

Check for fuel leaks. If you find any leaks, correct the problem before using the product.

6. Wipe spilled fuel from the product.
7. Move at least 9 metres away before starting the product.

NOTE: It is normal for the engine to emit smoke during use.

Starting the Product

Starting the product depends on whether the engine is cold or warm.



WARNING:

The recoil starter can be damaged by abuse.
Never pull the starter cord to its full length.
Always engage the starter before cranking the engine.
Always rewind the starter cord slowly.
Never operate the machine if the tubes are missing or damaged.



CAUTION:

Operating the machine with loose, missing or damaged components could allow the engine to over-speed, possibly causing serious engine damage.
Inspect the entire machine for damage, loose or missing components or fastenings and repair as necessary.

To Start a Cold Engine

Follow these steps to start a cold engine:

1. Lay the product on a flat bare surface.
2. Push the primer bulb repeatedly until fuel comes into the primer pump. For new engines or engines that have been refueled this may require numerous attempts.

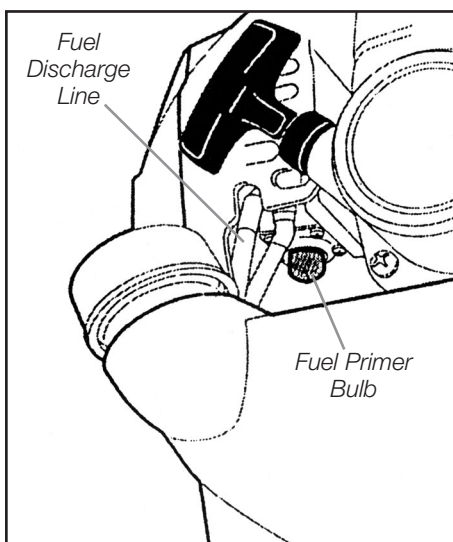

3. Pull the choke control to the fully extended position (choke is closed).

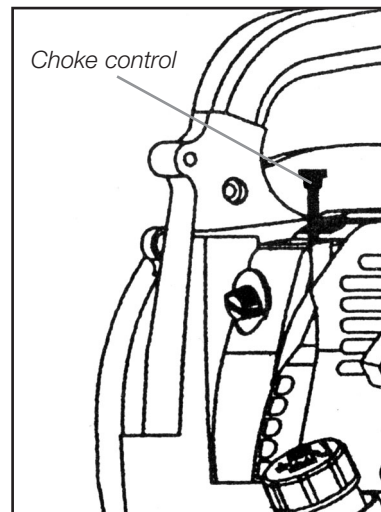

4. Holding the machine handle firmly with your right hand, pull the starter cord slowly until you feel the starter engage.
5. Start the machine by pulling the starter cord upward rapidly. If necessary, repeat Step 5 two or three times until the engine starts.

NOTE: When starting the engine for the first time, or after refueling, it may take longer for the fuel to reach the engine and become operational. You may need to repeat the steps several times in order to start the engine. If the engine will not start after repeated attempts, you should open the throttle and choke fully, and continue pulling the starter cord until the motor starts, making sure there is no danger of persons approaching the head while starting.

Starting the Product – *continued*

IMPORTANT: For maximum performance and operating life, allow the engine to warm before use.

1. Run the engine at idle speed until operating temperature is reached (2-3 minutes).
2. As the engine warms, open the choke gradually by slowly pushing the choke control in to the fully retracted position.
3. The machine should now be ready for use.

To start a warm engine:

Follow these instructions to start a warm engine.

1. Holding the machine handle firmly with your right hand, pull the starter cord slowly until you feel the starter engage.
2. Start the machine by pulling the starter cord upward rapidly.

If the engine does not start repeat the appropriate starting procedures for “warm” or “cold” engine. If the engine will not start, follow the “Starting a Flooded Engine” procedure below.

Starting a Flooded Engine

Follow these instructions to start a flooded engine.

1. Disconnect the spark plug lead and use the spark plug wrench supplied to remove the plug in a counter-clockwise direction.
2. If the spark plug is fouled or is soaked with fuel, clean or replace the plug as required.
3. Turn the product so that the spark plug hole is aimed at the ground.
4. Clear excess fuel from the combustion chamber by cranking the engine several times while the spark plug is removed.
5. Install the spark plug and firmly tighten it with the spark plug wrench supplied. **DO NOT OVERTIGHTEN.**
6. Reconnect the spark plug lead.



WARNING:

Incorrect spark plug installation can result in serious engine damage.

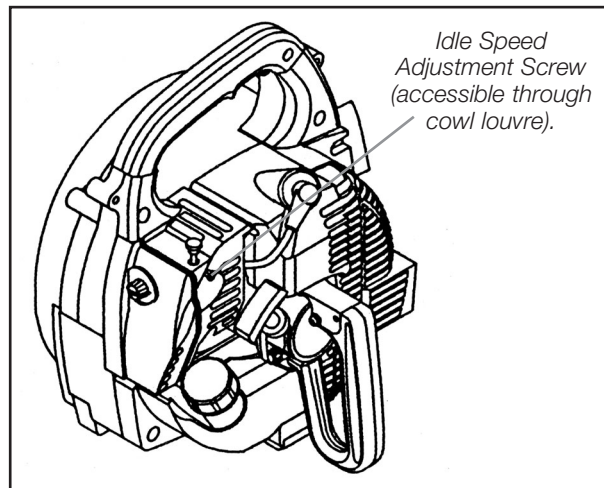

Adjusting Engine Idle Speed

Follow these instructions to adjust engine idle speed.

1. Start the engine by following the procedures described on the preceding pages.
2. Run the engine at idle speed until operating temperature is reached (2-3 minutes).
3. Use a screwdriver to adjust the engine idle speed to 2300-2500 rpm.
 - Turn the idle screw clockwise to increase engine idle speed.
 - Turn the idle screw counter-clockwise to decrease engine speed.



WARNING:

Machine tubes and intake cover must be installed while adjusting engine idle speed. Engine idle speed will also be affected if either the intake cover or machine tubes are blocked, damaged or incorrectly installed.

Stopping the Engine / Throttle Settings

Stopping the Engine

1. Cool the engine by allowing it to run at idle for 2-3 minutes.
2. Stop the engine by firmly pressing the OFF switch.



WARNING:

If the engine continues to run when the OFF switch has been depressed, stop the engine by pulling the choke control out to the fully closed position.

IMPORTANT: A clean and unrestricted airflow is essential to your machine's engine performance and durability. Before attempting any carburettor adjustments, inspect and clean the engine air filter as described on page 17 of this manual.

General Operating Instructions

Throttle Settings

Machine noise increases at higher throttle settings. In most instances, operate your machine at the lowest throttle setting necessary to complete the task.

1. Use low throttle settings when clearing lightweight materials from around lawns or shrubbery.
2. Use medium to higher throttle settings to move lightweight grass or leaves from hard surfaces, such as concrete.
3. Use full throttle when moving heavy loads such as dirt.

Blower / Vaccum Functions



DANGER:

The impeller will rotate whenever the machine is operated. Never operate this machine unless the intake cover and machine tubes are properly installed and in good working order.



WARNING:

Always wear eye protection when operating this machine and use a dust mask to reduce the risk of inhalation injuries. Never direct the machine stream toward people or animals.

Operating the Vacuum Function:

Model 101PBV26 only

Follow these steps to operate the vacuum function:



1. Ensure the correct tubes are connected and that the debris collection bag is firmly secured.
2. Start the engine.
3. Hold the blower vac using both handles.
4. Direct the vacuum tube towards the ground.

5. Ensure that the debris collection bag is behind you, and not impeding your movement.
6. Use the shoulder strap to support the weight of the debris collection bag as it fills.
7. Empty the debris collection bag regularly to ensure the weight of the collected debris is manageable.

Operating the Blower Function:

Follow these steps to operate the blower function:

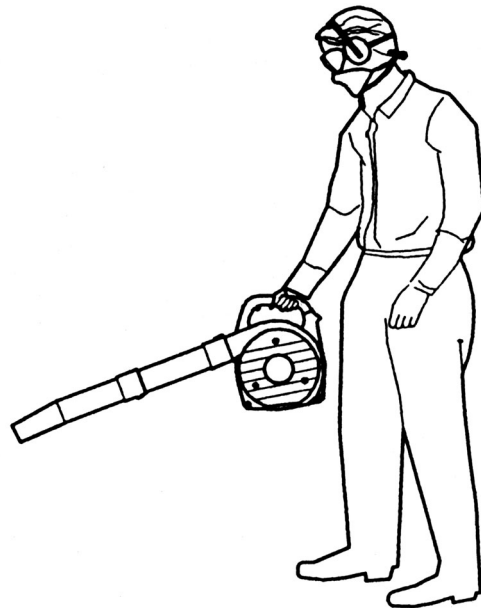

1. Ensure that the correct tubes are securely connected.
2. Start the engine.
3. Hold the blower using the top handle.
4. Using an arc approach, sweep the blower back and forward to direct the debris away from you.
5. Never direct the blower discharge stream toward people or animals.

Maintenance

Emissions Maintenance Schedule

Maintenance, replacement or repair of the emission control device and systems may be performed by any Authorised Toro or Pope Service Dealer.



WARNING:

Before performing any maintenance on this machine, stop the engine and disconnect the spark plug.

CLEANING THE PRODUCT:

- Stop the product before cleaning.
- Clean the exterior of the product with a damp cloth.
- Avoid using solvents when cleaning plastic parts. Most plastics are susceptible to damage from various types of commercial solvents and may be damaged by their use.

NOTE: Depending on the type of fuel used, the type and amount of oil used, and/or your operating conditions, the exhaust port and muffler may become blocked with carbon deposits. If you notice a power loss with your petrol powered tool, you may need to remove these deposits to restore performance. We highly recommend that only qualified service technicians perform this service.

Emission Part	Inspect before each use	Every 10 hours	Every 10 - 15 hours or yearly	Every 50 hours
Fuel Tank Assembly (includes Fuel Lines, Fuel Cap and Fuel Filter)	X			
Clean Air Filter		X	X	
Clean Spark Arrestor				X
Replace Spark Plug			X	

Maintenance – *continued*



WARNING:

When replacing parts other than engine or emissions parts, use only Pope replacement parts. Use of any other parts may create a hazard or cause product damage.

BEFORE EACH USE:

- Remove dirt and debris from the blower exterior.
- Inspect the engine, tank and hoses for possible fuel leaks and repair as necessary.
- Inspect the engine cooling fins for accumulations of debris and clean as necessary.
- Inspect the entire machine for damage, loose or missing components or fasteners and repair or replace as necessary.

Checking the Fuel Cap



WARNING:

A leaking fuel cap is a fire hazard and must be replaced immediately.

The fuel cap contains a non-serviceable filter and check valve. A clogged fuel filter causes poor engine performance. If performance improves when the fuel cap is loosened the check valve may be faulty or the filter may be clogged. Replace the fuel cap if necessary.

Cleaning the Air Filter

Clean the air filter as indicated by the maintenance schedule.

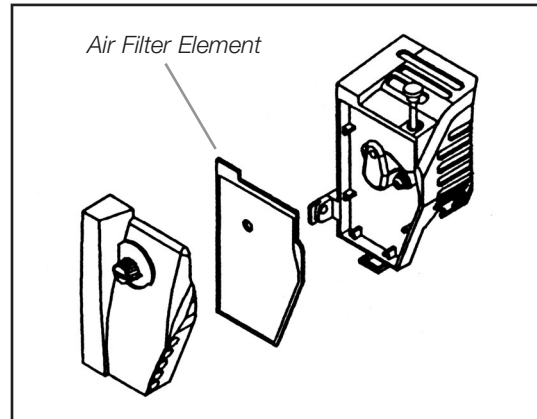

Follow these steps to clean the air filter.

1. Stop the engine.
2. Remove the spark plug boot.
3. Loosen the air cleaner cover retaining screw by turning the knob counter clockwise.
4. Remove the air filter cover.
5. Remove the air filter element.
6. Inspect the element. If the element is distorted or damaged, replace it with a new one.
7. Wash the element in clean fuel and squeeze or blow dry.
8. Wash the air cleaner cover in clean fuel and wipe or blow dry.
9. Install the element and cover and then tighten the cover retaining screw.
10. Replace the spark plug boot.

Maintenance – continued

Spark Plug Maintenance

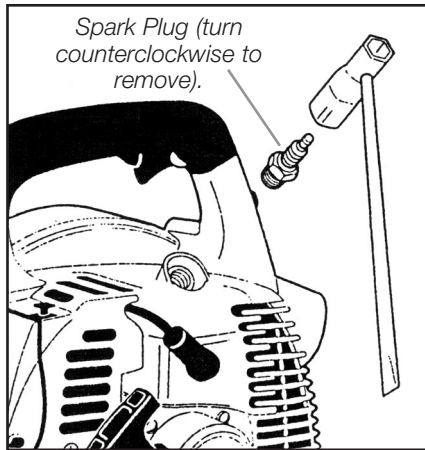

Follow these steps to replace the spark plug:

NOTE: Before removing the spark plug, thoroughly clean the spark plug and cylinder head area.

1. Ensure the engine is cool before servicing the spark plug.
2. Remove the spark plug boot.
3. Use the spark plug wrench to remove the spark plug by turning counter clockwise.
4. Clean and adjust the spark plug gap to 0.6 - 0.7mm.
5. Replace any damaged or visibly worn plug with a Champion RCJ7Y.
6. Hand tighten the spark plug in the cylinder and then tighten it firmly with the spark plug wrench. Do not overtighten.
7. Replace the spark plug boot.



CAUTION:

Be careful not to cross-thread the spark plug. Cross threading will seriously damage the product.



CAUTION:

Never allow dirt or debris to enter the cylinder.

Cleaning the Fuel Filter

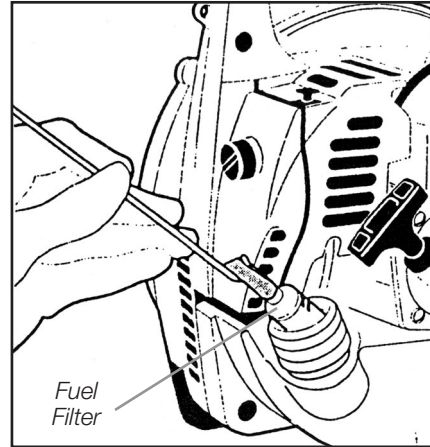

Follow these steps to clean the fuel filter:

1. Remove the spark plug boot.
2. Undo the fuel cap.
3. Use a wire hook to extract the fuel filter from inside the fuel tank.
4. Remove and wash the filter element in clean fuel.
5. Before reinstalling the filter, inspect the condition of the fuel line. If damage or deterioration is noted, the vacuum should be removed from service until it can be inspected by a trained service technician.
6. Replace the filter.
7. Replace the fuel cap.
8. Replace the spark plug boot.

Maintenance – continued

Cleaning the Cooling System



CAUTION:

Dirty or damaged cooling system components may allow the engine to overheat, possibly causing serious engine damage.

Follow these steps to clean the cooling system:

1. Remove the spark plug boot.
2. Use the spark plug wrench supplied to remove the spark plug.
3. Remove the three self tapping screws and two machine screws from the engine cover and then gently move the engine cover aside.
4. Remove the three-spark arrestor retaining screws and then remove the spark arrestor cover, screen, gasket and chamber.
5. Use a wood or plastic scraper and a soft brush to remove dirt and debris from the cylinder fins and crankcase.

Cleaning the Spark Arrestor

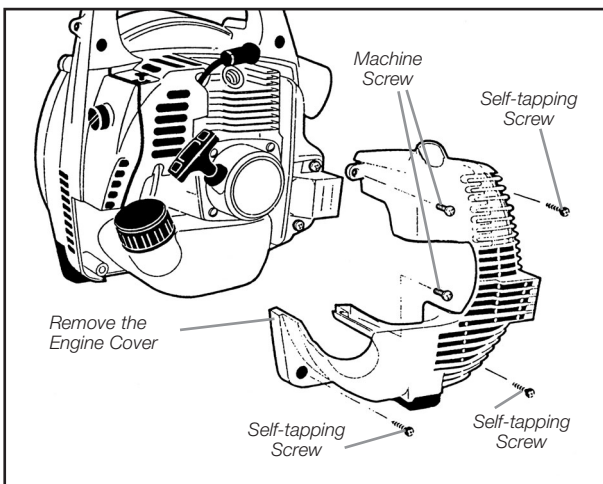

Hard starting or gradual loss of performance can be caused by carbon deposits lodged in the spark arrestor screen. For maximum performance, the spark arrestor screen should be periodically cleaned.

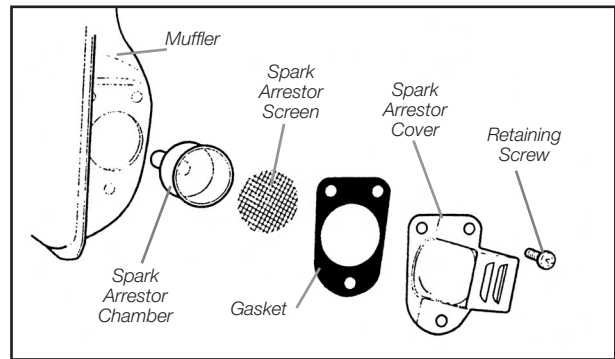

Follow these steps to clean the spark arrestor.

1. Remove the spark plug boot.
2. Remove the spark plug.
3. Remove three self-tapping screws and two machine screws from the engine cover and then gently move the engine cover aside.
4. Remove the three-spark arrestor retaining screws and then remove the spark arrestor cover, screen, gasket and chamber.
5. Use a plastic scraper or wire brush to remove carbon deposits from the arrestor screen, chamber and cover.
6. Inspect the screen carefully and replace any screen that has been perforated, distorted or is otherwise unserviceable.
7. Install the chamber, screen, gasket and cover in the reverse order of disassembly and then install and securely tighten the three cover retaining screws.
8. Install the engine cover retaining screws in the reverse order of removal and tighten securely.
9. Replace and tighten the spark plug. Follow the instructions for spark plug replacement to ensure correct tightness.
10. Reconnect the spark plug boot.



CAUTION:

Always replace cover screws in the same holes as removed substitution or incorrect assembly of engine cover screws can permanently damage aluminium castings and plastic components.

Storing the Product

Storing the product differs depending on the amount of time it will be in storage.

To Store the Product Short Term

Follow these steps to store the product short term.

1. Clean all foreign material from the product.
2. Store in a well-ventilated place that is inaccessible to children.

To Store the Product Long Term (more than 30 days)



CAUTION:

Never store this product with any fuel remaining in the tank, fuel lines or carburettor. Your warranty does not include coverage for damage caused by stale or contaminated fuels.

6. Pull the recoil starter 2 or 3 times to distribute the oil over the cylinder walls.
7. Reinstall the spark plug. Follow the instructions for spark plug replacement to ensure correct tightness.
8. Reconnect the spark plug boot.
9. Store the product in a well-ventilated place that is inaccessible to children.

NOTE: Keep the product away from corrosive agents such as garden chemicals.

IMPORTANT: Abide by all federal and local regulations for the safe storage, handling and disposal of petrol.

If you do not intend to use the product for more than one month, follow these steps to store the product long term.

1. Drain all of the fuel from the tank into a container approved for petrol.
2. Run the engine until it stops.
3. Clean all foreign materials from the product.
4. Remove the spark plug boot, and then the spark plug.
5. Pour approximately 5 ml oil into the cylinder through the spark plug hole.

Troubleshooting:

Problem	Possible Cause	Solution
Engine will not start	<ol style="list-style-type: none"> 1. No spark. 2. No fuel. 3. Flooded engine. 4. Starter cord pulls harder now than when new. 	<ol style="list-style-type: none"> 1. Remove the spark plug. Reattach the spark plug cap and lay the spark plug on the metal cylinder. Pull the starter cord and watch for a spark at the spark plug tip. If there is no spark, repeat the test with a new spark plug. 2. Push the primer bulb until the bulb is full of fuel. If the bulb does not fill, the primary fuel delivery system is blocked or the fuel lines may be bent. If the primer bulb fills, the engine may be flooded (see next item). 3. Remove the spark plug. Turn the product so that the spark plug hole is aimed at the ground. Make sure the choke lever is open and pull the starter cord 10 - 14 times. This clears excess fuel from the engine. Clean and reinstall the spark plug. Pull the starter cord 3 times. If the engine does not start, close the choke lever and follow normal starting instructions. If the engine still fails to start, repeat the procedure with a new spark plug. 4. Contact an authorised service dealer.
Poor acceleration	<ol style="list-style-type: none"> 1. Clogged air cleaner element. 2. Clogged fuel filter. 3. Carburettor mixture too lean. 4. Idle speed set too low. 	<ol style="list-style-type: none"> 1. Clean the element. 2. Clean or replace the fuel filter as per instructions. 3. Contact an authorised service dealer. 4. Adjust to 2300 - 2500 rpm.
Engine stops abruptly	<ol style="list-style-type: none"> 1. Fuel tank empty. 2. Clogged fuel filter. 3. Water in the fuel. 4. Shorted spark plug or loose terminal. 5. Ignition failure. 6. Piston seizure. 	<ol style="list-style-type: none"> 1. Refuel. 2. Clean or replace the fuel filter as per instructions. 3. Drain and replace with clean fuel. 4. Clean and replace spark plug. Tighten the terminal. 5. Contact an authorised service dealer. 6. Contact an authorised service dealer.
Engine difficult to shut off	<ol style="list-style-type: none"> 1. Ground(stop) wire is disconnected or switch is defective. 2. Overheating due to incorrect spark plug. 3. Overheated engine. 	<ol style="list-style-type: none"> 1. Test and replace as required. 2. Correct spark plug - Champion RCJ7Y. 3. Idle engine until cooled.

Troubleshooting:

Problem	Possible Cause	Solution
Excessive vibration	<ol style="list-style-type: none"> 1. Warped or damaged blower fan. 2. Loose bolt or fastener. 3. Internal engine damage. 	<ol style="list-style-type: none"> 1. Inspect and replace fan as required. 2. Locate and tighten as required. 3. Contact an authorised service dealer.
Engine overheating	<ol style="list-style-type: none"> 1. Machine being overworked. 2. Carburettor mixture is too lean. 3. Improper fuel ratio. 4. Fan, fan cover, cylinder fins dirty or damaged. 	<ol style="list-style-type: none"> 1. Use lower throttle setting. 2. Contact an authorised service dealer. 3. Re-fill with fresh fuel of the correct mixture petrol and 2 stroke oil in a 25:1 ratio. 4. Clean, repair or replace as necessary.
Engine is rough at all speeds. May also have black smoke and or unburned fuel at the exhaust.	<ol style="list-style-type: none"> 1. Clogged air cleaner element. 2. Loose or damaged spark plug. 3. Air leakage or clogged fuel line. 4. Water in the fuel. 5. Piston seizure. 6. Faulty carburettor and / or diaphragm. 	<ol style="list-style-type: none"> 1. Service the air cleaner. 2. Tighten or replace. 3. Repair or replace filter and/or fuel line. 4. Drain the fuel and replace with fuel of the correct mixture petrol and 2 stroke oil in a 25 : 1 ratio. 5. Contact an authorised service dealer 6. Contact an authorised service dealer
Engine is "knocking".	<ol style="list-style-type: none"> 1. Engine is overheating. 2. Improper fuel being used. 	<ol style="list-style-type: none"> 1. Refer to Troubleshooting section on Overheating for possible causes. 2. Check fuel octane rating and refuel.

Warranty

Petrol Operated Products Limited Warranty

Pope warrants to the original retail purchaser that this Petrol Powered Product is free from defects in material and workmanship and agrees to repair or replace, at our option, any defective Product free of charge within these time periods from the date of purchase:

- Two years for Petrol Powered Trimmer, Brushcutter and Blower Vacuum Products, if the Product is used for personal, family, or household use;
- 90 days if the Petrol Powered Trimmer, Brushcutter and Blower Vacuum Products are used for any other purpose, such as commercial or rental.

Instructions for Obtaining Warranty Service

Any part of the Pope Product found in the reasonable judgement of Toro Australia Pty Limited to be defective in material or workmanship will be repaired or replaced by an Authorised Service Dealer for this product without charge for parts or labour. To locate your nearest authorised service dealer, refer to the list in the back of this manual, check the website, or phone 1300 134 880.

The Product, including any defective part must be returned to an Authorised Service Dealer for this product within the warranty period. The expense of delivering the product to the Authorised Service Dealer for warranty work and the expense of returning it back to the owner after repair or replacement will be paid for by the owner.

Proof of purchase will be required by the dealer to substantiate any warranty claim. All warranty work must be performed by a Service Dealer authorised by Toro Australia Pty Limited to service this product.

The warranty does not cover any product that has been subject to misuse, neglect, negligence or accident or that has been operated in any way contrary to the operating instructions as specified in the Operator's Manual. This warranty does not apply to any damage to the Product that is the result of improper maintenance or to any Product that has been altered or modified so as to adversely affect the product's operation, performance or durability or that has been altered or modified so as to change its intended use. The warranty does not extend to repairs made necessary by normal wear, misuse or by the use of parts or accessories which are either incompatible with the product or adversely affect its operation, performance or durability.

Toro Australia Pty Limited reserves the right to change or improve the design of any Petrol Product without assuming any obligations to modify any product previously manufactured.

ALL IMPLIED WARRANTIES ARE LIMITED TO THE DURATION OF THE STATED WARRANTY PERIOD. ACCORDINGLY, ANY SUCH IMPLIED WARRANTIES INCLUDING MERCHANTABILITY, FITNESS FOR A PARTICULAR PURPOSE, OR OTHERWISE, ARE DISCLAIMED IN THEIR ENTIRETY AFTER THE EXPIRATION OF THE APPROPRIATE TWO-YEAR OR NINETY DAY WARRANTY PERIOD. TORO AUSTRALIA PTY LIMITED'S OBLIGATION UNDER THIS WARRANTY IS STRICTLY AND EXCLUSIVELY LIMITED TO THE REPAIR AND REPLACEMENT OF DEFECTIVE PARTS AND TORO AUSTRALIA PTY LIMITED DOES NOT ASSUME OR AUTHORISE ANYONE TO ASSUME FOR THEM ANY OTHER OBLIGATION. TORO AUSTRALIA PTY LIMITED ASSUMES NO RESPONSIBILITY FOR INCIDENTAL, CONSEQUENTIAL OR OTHER DAMAGES INCLUDING, BUT NOT LIMITED TO EXPENSE OF RETURNING THE PETROL POWERED PRODUCT TO AN AUTHORISED SERVICE DEALER AND EXPENSE OF DELIVERING IT BACK TO THE OWNER, MECHANIC'S TRAVEL TIME TELEPHONE OR TELEGRAM CHARGES, RENTAL OF A LIKE PRODUCT DURING THE TIME WARRANTY SERVICE IS BEING PERFORMED, TRAVEL, LOSS OR DAMAGE TO PERSONAL PROPERTY, LOSS OF REVENUE, LOSS OF USE OF THE PRODUCT, LOSS OF TIME OR INCONVENIENCE.

The above warranty does not exclude any condition or warranty implied by the Trade Practices Act 1974 or any other relevant legislation which implies any condition which cannot be excluded.

Authorised Pope Service Dealers

AUST. CAPITAL TERRITORY

Mitchell Lawnmower
Centre
MITCHELL
(02) 6241 4806

NEW SOUTH WALES

AgriFarm Implements
TAREE
(02) 6552 6888

AgriMow
COFFS HARBOUR
(02) 6652 9893

Barry Austin Mowers
FORSTER
(02) 6554 6935

Bega Farm Supplies
BEGA
(02) 6492 4466

Bike and Power
DURAL
(02) 9651 7170

Bill's Mudgee Chainsaw
Centre
MUDGEE
(02) 6372 4122

Bridge Mower &
Chainsaw Centre
EAST GOSFORD
(02) 4325 2107

Central West Mowers
& Chainsaws
ORANGE
(02) 6362 0681

Cooma Power
Equipment
COOMA
(02) 6452 2622

Dawmac Industries
BERRIGAN
(03) 5885 2382

Deni Bike & Boat
DENILIQUIN
(03) 5881 5255

Dubbo Mowers &
Chainsaws
DUBBO
(02) 6882 3122/
(02) 6882 9499

Farm Moto
LISMORE
(02) 6622 3999

Grafton Power Products
GRAFTON
(02) 6642 2880

Harvey's Mower Centre
WAGGA WAGGA
(02) 6925 2234

J & P Motorcycles
GRIFFITH
(02) 6964 2422

Keith Simmons
Engineering
YOUNG
(02) 6382 3999

Ken Mathews Mower
& Auto Centre
ULLADULLA
(02) 4455 1645

LW Burgess Pty Ltd
ARMIDALE
(02) 6772 2227

Lawnpower Pty Ltd
NOWRA
(02) 4421 4466

Macarthur Mowers
CAMDEN
(02) 4655 7793/ (02) 4655 6242

Moruya Mower &
Chainsaw Centre
MORUYA
(02) 4474 3322

Mower World
WAUCHOPE
(02) 6585 2053

Newcastle Chainsaws
ISLINGTON
(02) 4961 1332

Newcastle Chainsaws
RAYMOND TERRACE
(02) 4987 3837

Ranger Geale Enterprises
GOULBURN
(02) 4821 4266

S&T Haddad Mowers
MOREE
(02) 6752 4906

Scone Outdoors
SCONE
(02) 6545 3033

Small Engine Services
GLEN INNES
(02) 6732 1441

Tamworth Small Engines
TAMWORTH
(02) 6765 9737

The Irrigation Specialists
LEETON
(02) 6953 6700

The Mowers Warehouse
LITHGOW
(02) 6351 4008

Tinks
MACKSVILLE
(02) 6568 2344

Town & Country Water Shop
BATHURST
(02) 6331 9622

WH Ireland & Sons
MITTAGONG
(02) 4872 1999

Welvin Mower & Gas
NTH RICHMOND
(02) 4571 1662

NORTHERN TERRITORY

Winnellie Mower Repairs
WINNELLIE
(08) 8984 4529

QUEENSLAND

Aussie Mower Centre
HERVEY BAY
(07) 4125 3152

Boat or Mowers
GLADSTONE
(07) 4972 0135

Braschs Pty Ltd
CAIRNS
(07) 4051 1411

Casali's
MAREEBA
(07) 4092 3841

David Evans Group
GATTON
(07) 5462 1266

David Evans Group
BILOELA
(07) 4992 1099

Dover & Sons
BEAUDESERT
(07) 5541 1977

Dover & Sons
BOONAH
(07) 5463 1388

Downs Mower Centre
TOOWOOMBA
(07) 4632 4000

Mower World
OXENFORD
(07) 5573 4388

Jackson's Mower Centre
MACKAY
(07) 4957 5450

Kel's Chainsaws &
Small Motors
EMERALD
(07) 4982 4701

Keppel Outdoor Products
YEPPON
(07) 4925 0600

Mudgeeraba Mower
Centre
MUDGEERABA
(07) 5530 4477

Nanango Motors
NANANGO
(07) 4163 1108

Nowa Power Products
BUNDABERG
(07) 4153 1722

Rimrock Agencies
ROCKHAMPTON
(07) 4927 7033

Schilling Small Engines
MARYBOROUGH
(07) 4123 2833

Southside Small Engines
CAPALABA
(07) 3245 6011

Southwest Pumps,
Solar & Small Engines.
ROMA
(07) 4622 4528

Sunstate AG
DALBY
(07) 4672 3333

The Big Mower
BEERWAH
(07) 5494 6151

The Mower Place
BROWNS PLAINS
(07) 3800 4433

The Mower Supastore
BRENDALE
(07) 3205 1299

The Mower Warehouse
CABOOLTURE
(07) 5495 8822

The Watershed
INNISFAIL
(07) 4061 6177

Vic's Mowers &
Small Engines
MOSSMAN
(07) 4098 1600
Warwick Westside
Chainsaws & Mowers
WARWICK
(07) 4661 2032

SOUTH AUSTRALIA

Mower Plus
SALISBURY SOUTH
(08) 8250 5666

Oaklands Road Mower
Centre
SOMERTON PARK
(08) 8294 9799

Peter Jennings Pumps
MT GAMBIER
(08) 8725 0722

TASMANIA

Central Coast Mower
Market
WEST ULVERSTONE
(03) 6425 3318

Eastern Shore Mowers
& Cycles
LINDISFARINE
(03) 6243 7776

Pellows Saws & Mowers
INVERMAY
(03) 6326 5722

Pellows Saws & Mowers
DEVONPORT
(03) 6424 8364

VICTORIA

Alphine Mowers
MONBULK
(03) 9752 0488

Bendigo Mower Service
BENDIGO
(03) 5443 5242

Benalla Chainsaws
BENALLA
(03) 5762 6177

Black's Machinery
NAGAMBIE
(03) 5794 2534

Bob Crosby & Co.
WODONGA
(02) 6024 1333

Bolton Motorcycles &
Power Equipment
KYNETON
(03) 5422 2255

Central Gippsland
Mowers & Chainsaws
MORWELL
(03) 5134 8899

Dawn Mowers
SURREY HILLS
(03) 9830 5444

Drouin Mowers &
Chainsaws
DROUIN
(03) 5625 1079

Gendore Leongatha
LEONGATHA
(03) 5662 4044

Gendore
TOORADIN
(03) 5998 3216

Gisborne Power
Products
GISBORNE
(03) 5428 8844

Hastings Mowers
HASTINGS
(03) 5979 1382

Henderson Mowers
BALLARAT
(03) 5331 1618

JR's Mowers & Chainsaws
BAIRNSDALE
(03) 5152 3202

Magic Mowers
MILDURA
(03) 5022 7088

Mariot's Motor Cycles
& Equip P/L
LEONGATHA
(03) 5662 2028

Molin Motorcycles &
Marine
KOONDROOK
(03) 5451 1500

Mornington Mowers
MORNINGTON
(03) 5977 1488

Mortons Machinery
RINGWOOD
(03) 9870 7133

Mower Corner
COLAC
(03) 5231 5022

Mowers Galore
NORTH GEELONG
(03) 5272 1066

Mowers Galore
GROVEDALE
(03) 5244 0620

Philip Russell
Motorcycles
WARRNAMBOOL
(03) 5562 0222

Powerquip Mower &
Chainsaw Centre
DOVETON
(03) 9793 3177

Powerquip Mower &
Chainsaw Centre
HALLAM
(03) 9796 5045/

(03) 9796 3687
Roy Hill Motors
SHEPPARTON
(03) 5821 8877

Stihl Echuca Sales &
Service
ECHUCA
(03) 5480 9566

Stihl Shop Seymour
SEYMOUR
(03) 5799 1215

T&I Horticulture
SWAN HILL
(03) 5032 4555

Vin Rowe Farm Machinery
WARRAGUL
(03) 5623 1362

Yarra Glen Mower Centre
YARRA GLEN
(03) 9730 1988

WESTERN AUSTRALIA

Busselton Mower World
BUSSELTON
(08) 9754 1969

Cloverdale Hardware
CLOVERDALE
(08) 9479 4383

Eastern Hills Saws &
Mowers
MUNDARING
(08) 9295 2466

Geraldton Mower Repairs
GERALDTON
(08) 9964 4036

Star Sales & Service
ALBANY
(08) 9842 2455