



25.4cc Line Trimmer

25.4cc Ezy Load Line Trimmer

25.4cc Straight Shaft Brushcutter

33cc Brushcutter

33cc Brushcutter with Bull Handles

Model No 101PLT25

Model No 101PLT25D

Model No 101PLT25SS

Model No 101PBC33

Model No 101PBC33BH

Operator's Manual



WARNING:

To reduce the risk of injury, the user must read and understand the operator's manual. Save this manual.

READ THIS INFORMATION



Before you use your new trimmer/brushcutter, read this manual carefully to learn how to operate and maintain your product correctly. Reading this manual will help you and others avoid personal injury and damage to the product. Although Pope designs safe state-of-the-art products, you are responsible for using the product properly and safely. You are also responsible for training persons you allow to use the product about safe operation.

Introduction

Thank you for purchasing a Pope® product.

We would like you to be completely satisfied with your new product, so feel free to contact an authorized service dealer listed at the back of this manual, for help with service, genuine Pope parts or other information you may require. Or phone the Pope Customer Service Centre for details of your nearest dealer on 1300 134 880.

The Pope warning system in this manual identifies potential hazards and special safety messages that help you and others avoid personal injury, even death. DANGER, WARNING and CAUTION are signal words that identify the level of hazard. However, regardless of the hazard, be extremely careful. Two other words “Important” and “Note” highlight other valuable information.

Signal Word	Explanation
DANGER	Indicates an imminently hazardous situation which, if not avoided, will result in death or serious injury.
WARNING	Indicates a potentially hazardous situation which, if not avoided, could result in death or serious injury.
CAUTION	Indicates a potentially hazardous situation which if not avoided, could result in death or serious injury.
Important	Advises you of important information or instructions vital to the operation or maintenance of the equipment.
Note	Advises you of additional information concerning the operation or maintenance of the equipment.

Contents

Safety Rules	4
Symbols	5
Specifications	6
Applications	7
Features	8
Unpacking	9
Assembly	10
Attaching the Front Handle	10
Attaching the Bull-Bar Handles	10
Attaching the Shoulder Strap	10
Installing the Line Trimmer Head Assembly (Line Trimmer)	10
Installing the Line Trimmer Head Assembly (Brushcutter)	11
Installing the Blade	11
Installing the Ezy Load Line Trimmer Head	12
Adding Cutting Line to the Ezy Load Line Trimmer Head Assembly	12
Attaching the Grass Deflector Guard	13
Attaching the Curved Shaft Grass Deflector Guard	13
Attaching the Straight Shaft Grass Deflector Guard	13
Operation	14
Mixing the Fuel	14
Filling the Tank	14
Starting the Product – To Start a Cold Engine	15
– To Start a Warm Engine	16
Starting a Flooded Engine	16
Stopping the Engine	16
Operating the Line Trimmer	17
To Advance the Cutting Line on a Bump Feed Spool	17
Operating the Brushcutter	18
Installing the Blade Guard	19
Maintenance	20
Cleaning the Product	21
Replacing the Cutting Line	21
Cleaning the Air Filter	22
Replacing the Spark Plug	23
Storing the Product	23
Troubleshooting	24
Warranty	25

Safety Rules



WARNING:







Read and understand all instructions. Failure to follow all instructions may result in serious personal injury as well as damage to product.

- **Physical Condition of the Operator.** Do not operate this product when tired, ill or under the influence of alcohol, drugs or medication.
- **Clothing Requirements.** Always wear long heavy pants, boots and gloves. Do not wear loose clothing, jewellery, short pants, sandals or go barefoot. Secure hair so that it is above shoulder level to avoid entanglement in moving parts.
- **Protective Accessories Requirements.** Wear safety eye protection when operating this product. Wear hearing protection during extended periods of operation.
- **Condition of Product Before Use.** Inspect the product before each use. Replace damaged parts. Check for fuel leaks. Make sure all fasteners are in place and secure. Replace cutting attachment parts that are cracked, chipped or damaged in any way. Make sure the cutting attachment is properly installed and securely fastened. Be sure the cutting attachment guard is properly installed and in the position recommended by the manufacturer. Use only flexible, non-metallic line recommended by the manufacturer. For example, never use wire or wire rope which can break off and become a dangerous projectile.
- **Proper Stance.** Keep firm footings and balance. Do not overreach. Keep the cutting attachment below waist level. Keep all parts of your body away from the rotating cutting attachment and hot surfaces.
- **Exhaust Gases.** Never start or run the product inside a closed room or building: breathing exhaust fumes can cause illness or death.
- **Fuelling.** Mix and pour fuel outdoors where there are no sparks or flames. Slowly remove the fuel cap only after stopping the engine. Do not smoke while fuelling or mixing fuel. Wipe spilled fuel from the product. Move at least 9m from the fuelling source and site before starting the engine.
- **Work Area.** Clear the area to be cut before each use. Remove all objects such as rocks, broken glass, nails, wire, or string that can be thrown or become entangled in the cutting attachment. Clear the area of bystanders, pets and children. At a minimum, keep all bystanders, pets and children outside a 15m radius. Because there still may be a risk to bystanders from thrown objects, bystanders should be encouraged to wear eye protection. If you are approached while operating the product, stop the engine or for those products equipped with a clutch be sure the cutting attachment has stopped moving.
- **Dangerous Environments.** To avoid falling, do not use the product in damp or wet locations.
- **Controlling the Product.** During carburettor adjustments the cutting attachment may spin. Therefore you should wear protective equipment and observe all safety instructions when adjusting the carburettor. For products equipped with a clutch, be sure the cutting attachment has stopped before setting down the product.
- **Use the Right Product.** Use the product for the intended purpose only.
- **Condition of Brushcutter Before Use.** The handles shall be mounted according to the manufacturer's instructions. Do not attach any blade to a product without proper installation of all required parts. Failure to use the proper parts can cause the blade to fly off and seriously injure the operator and/or bystanders. Discard blades that are bent, warped, cracked, broken or damaged in any way.
- **Use the Right Equipment.** Always use the barrier bar on the front handle with the line trimmer and brushcutter, and use the shoulder strap with the brushcutter.
- **Blade Thrust.** Blade thrust may occur when the spinning blade contacts an object that it does not immediately cut. A blade thrust can be violent enough to cause the product and/or operator to be propelled in any direction and possibly lose control of the product. Blade thrust can occur without warning if the blade snags, stalls or binds. This is more likely to occur in areas where it is difficult to see the material being cut.
- **Stopping the Product.** A coasting blade can cause injury while it continues to spin after the engine is stopped or the throttle is released. Maintain proper control until the blade has completely stopped rotating.

Save These Instructions

Symbols

The following symbols are located on the product. Please study them and learn their meaning. Proper interpretation of these symbols allows you to operate the product better and safer.

Symbol	Name	Explanation
	Safety Alert	Indicates danger, warning or caution. Attention is required in order to avoid serious personal injury. May be used in conjunction with other symbols or pictographs.
	Thrown Objects	Thrown objects can cause severe injury. Wear protective clothing and boots.
	Keep Bystanders Away	Keep all bystanders, especially children and pets, at least 15 metres from the operating area.
	No Blade	Do not install any type of blade on Model Nos. 101PLT25 and 101PLT25D. Use only flexible, non-metallic line.
	Blade Thrust	Beware of blade thrust. Blade thrust is the sudden sideways, forward, or backward motion of the product that may occur when the blade jams or catches on an object such as a sapling or a tree stump.
	Read Operator's Manual	Read the Operator's Manual before starting or operating this product. Failure to follow operating instructions and safety precautions in the Operator's Manual can result in serious injury.
	Eye and Ear Protection	Thrown objects can cause severe eye injury. Wear eye protection when operating this product. Wear hearing protection during extended periods of operation.

Specifications

Model 101PLT25 Curved Shaft Line Trimmer

Engine:	25.4 cc Full Crank
Cutting Width:	35cm
Line Size:	1.6mm to 1.8mm
Weight (Dry):	4.7 kg
Fuel Tank Capacity:	1.2 litres

Model 101PLT25D Ezy Load Line Trimmer

Engine:	25.4 cc Full Crank
Cutting Width:	35cm
Line Size:	2.4mm to 2.5mm
Weight (Dry):	4.7 kg
Fuel Tank Capacity:	1.2 litres

Model 101PLT25SS Straight Shaft Brushcutter

Engine:	25.4 cc Full Crank
Cutting Width:	43cm
Line Size:	1.6mm to 1.8mm
Weight (Dry):	5.2 kg
Fuel Tank Capacity:	1.2 litres

Model 101PBC33 Straight Shaft Brushcutter

Engine:	33 cc Full Crank
Cutting Width:	43cm
Line Size:	2.0mm to 2.5mm
Weight (Dry):	6.4 kg
Fuel Tank Capacity:	0.75 litres

Model 101PBC33BH Straight Shaft Brushcutter with Bull-bar handles

Engine:	33 cc Full Crank
Cutting Width:	43cm
Line Size:	2.0mm to 2.5mm
Weight (Dry):	7.0 kg
Fuel Tank Capacity:	0.75 litres

Applications

Use this product for the following applications:

- Cutting grass, weeds and light undergrowth (all models)
- Edging along paths and driveways (all models)
- Cutting pulpy weeds, vines and light brush (Models 101PBC33, 101PBC33BH and 101PLT25SS).



Features

Before using the product, familiarize yourself with all operating features and safety requirements. However, do not let familiarity with the product make you careless.



WARNING:

Exercise caution when using the product. Careless actions, for even a fraction of a second, can result in serious personal injury.

Your new product is equipped with the following features.

Engine

The engine is powerful and easy to start. It is effectively counterbalanced, which allows for less vibration and more durability.

Safety Guard

The safety guard keeps grass from getting wrapped around the drive shaft and protects users from flying debris. The guard includes a cutting blade that automatically trims the line to the correct length.

Bump Feed Head (Model Nos. 101PLT25, 101PLT25SS, 101PBC33 and 101PBC33BH)

The bump feed head with dual line permits efficient cutting and easy tap-and-go action for restoring broken line.

Ergonomic Loop Handle (Model Nos. 101PLT25, 101PLT25D, 101PLT25SS and 101PBC33)

The design of the product provides for easy handling. It is designed for comfort and ease of grasp when operating in different positions and at different angles. The barrier bar restrains the operator in position and maintains a proper distance between the operator and the line head.

Ezy Load Cutting Head (Model No. 101PLT25D only)

The Ezy Load Cutting Head is the simple alternative to a traditional bump feed head, that allows replacement of new line in just seconds.

Blade (Model Nos. 101PBC33, 101PBC33BH and 101PLT25SS)

The blade allows you to brush cut weeds, vines and light brush.

Shoulder Strap (Model Nos. 101PBC33, 101PBC33BH and 101PLT25SS)

The brushcutter includes a shoulder strap with anti-vibration pad that helps support the product and reduce wearer fatigue.

Bull-bar Handles (Model No. 101PBC33BH only)

For greater control or extended use, bull-bar handles provide optimum comfort and manageability. The handle mounted throttle and on-off switch means that engine power is at your finger-tips.



WARNING:

Do not attempt to modify this product or create accessories not recommended for use with this product. Any such alteration or modification is misuse and could result in a hazardous condition leading to serious personal injury and will void your guarantee.

Unpacking

Instructions

- Carefully remove the product from the box.
- Inspect the product carefully to make sure no breakage or damage occurred during shipping.
- Do not discard the packing material until you have carefully inspected and satisfactorily operated the product.
- If any parts are damaged or missing, please call 1300 134 880.



WARNING:

If any parts are missing, do not operate the product until the missing parts are replaced. Failure to do so could result in serious personal injury.

Packing List

Model No. 101PLT25SS

Straight Shaft Line Trimmer

25.4cc engine and straight shaft

Grass Deflector Guard

Fuel Mixing Bottle

Assembly Tools – 1 bag including:

- Spark plug wrench with PH Screwdriver attachment (1)
- Allen Key (2)
- Spanner (1)
- Backing Plates (2)
- Screws with washers and locking washers (4)

Loop Handle with barrier bar

Bump Feed Spool

Brush Cutter Blade

Shoulder Strap

Operator's Manual

Model Nos. 101PBC33 and 101PBC33BH

Straight Shaft Brush Cutter

33cc engine and straight shaft

Grass Deflector Guard

Fuel Mixing Bottle

Assembly Tools – 1 bag including:

- Spark plug wrench with PH Screwdriver attachment (1)
- Allen Key (2)
- Spanner (1)
- Backing Plates (2)
- Screws with washers and locking washers (4)

Bull-bar Handles (Left and Right side) (101PBC33BH only)

Loop Handle with barrier bar (101PBC33 only)

Bump Feed Spool

Brushcutter blade

Shoulder Strap

Operator's Manual

Model No. 101PLT25 and 101PLT25D

Curved Shaft Line Trimmer and Ezy Load Line Trimmer

25.4 cc engine and bent shaft

Grass Deflector Guard

Fuel Mixing Bottle

Assembly Tools – 1 bag including:

- Spark plug wrench with PH Screwdriver attachment (1)
- Allen Key (1)
- Spanner (1 silver)
- Spanner (1 black – 101PLT25D only)

Loop Handle with barrier bar

Bump Feed Spool (101PLT25 only)

Operator's Manual

Ezy Load Cutting disc (101PLT25D only)

Assembly

Attaching the Front Handle

(Model Nos. 101PLT25, 101PLT25SS, 101PLT25D, 101PBC33)

See Fig. 2

Follow these steps to attach the front handle.

1. Remove the slotted screws provided to separate the handle from the handle support.
2. Place the handle along the upper shaft to a position that allows for comfortable operation.
3. Place the handle support on the bottom of the tube on the opposite side of the front handle.
4. Secure the handle with the slotted screws provided.

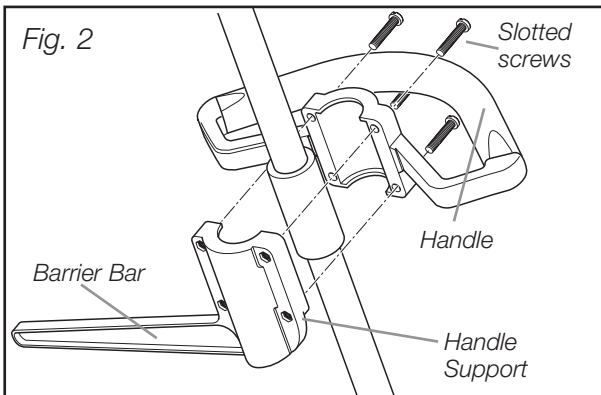

Attaching the Bull-Bar Handles

(Model No. 101PBC33BH only)

See Fig. 3

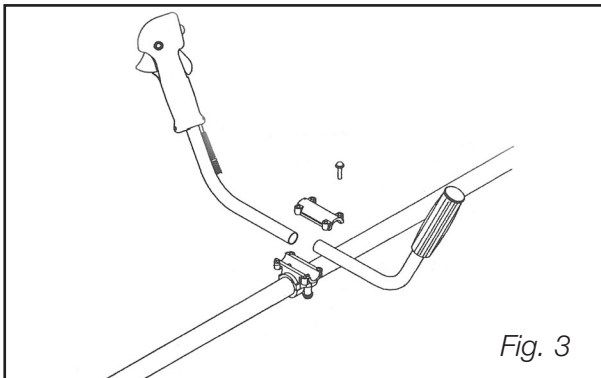

Follow these steps to attach the bull-bar handles.

1. Loosen the nuts on the handle brace attached to the shaft.
2. Slide the right handle with the throttle control into the right side of the handle brace.
3. Slide the left handle into the left side of the handle brace.
4. Retighten nuts so that bull-bar handles are secure.

Attaching the Shoulder Strap

Brushcutter – Model Nos. 101PBC33 and 101PBC33BH

Follow these steps to attach the shoulder strap.

1. Connect the latch on the strap to the hanger bracket.
2. Adjust the shoulder strap so that the product hangs a few centimetres above ground level. The cutting head and the deflector guard should be level in all directions.
3. Ensure the waist strap fits firmly around the body and that the anti-vibration pad rests on the hip.

NOTE: To release the product from the shoulder strap, depress the lever and slide off the hanger bracket.

Installing the Line Trimmer Head Assembly

Line Trimmer – Model No. 101PLT25

See Fig. 4

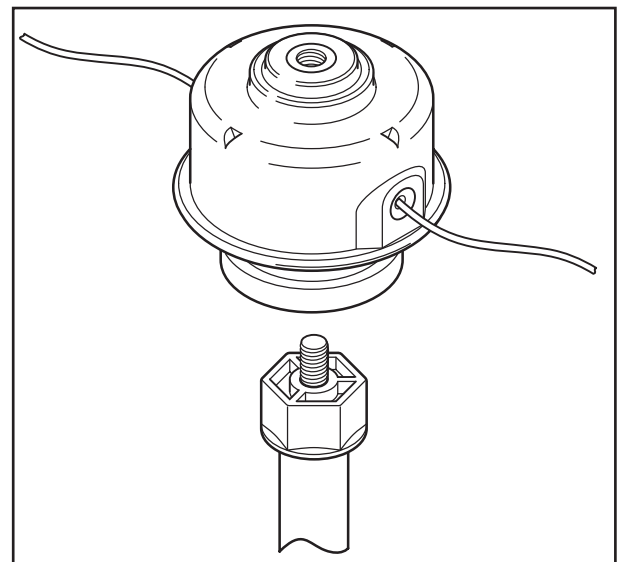

Fig. 4

Follow these steps to attach the Line Trimmer Head Assembly.

1. Install the Line Trimmer Spool by screwing onto the threaded drive shaft.
2. Turn in a clockwise direction to tighten.
3. The Line Trimmer is ready to use.

Assembly – continued

Installing the Line Trimmer Head Assembly

Brushcutter – Model Nos. 101PBC33, 101PLT25SS and 101PBC33BH

See Fig. 5

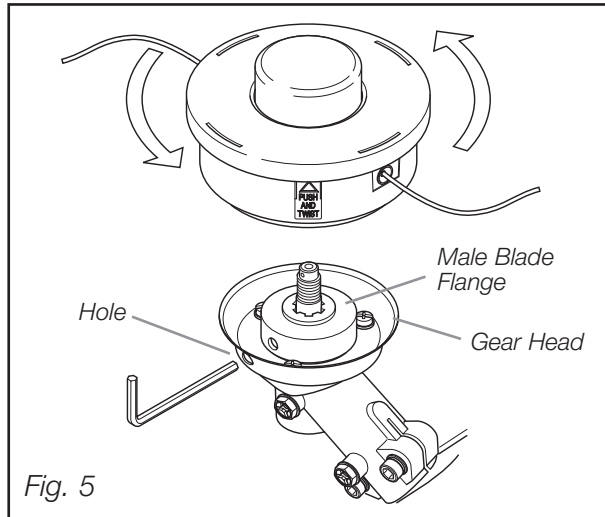

Follow these steps to attach the Line Trimmer Head Assembly.

1. Align the hole in the gear head with the slot in the male blade flange and insert the 4mm Allen key to prevent the gear head from rotating.
2. If the blade is assembled, remove split pin, blade nut, spring washer and female blade flange from the gear head assembly.
3. Store safely for future use with the brushcutting blade.
4. Thread the line trimmer spool onto the threaded drive shaft, turning counter clockwise until it is tight.
5. Remove Allen key.

Installing the Blade

Brushcutter – Model Nos. 101PBC33, 101PBC33BH and 101PLT25SS

See Fig. 6

Follow these steps to install the Brushcutter blade.



WARNING:

Be careful when handling the blade. It is sharp. Failure to heed this warning can result in serious personal injury.

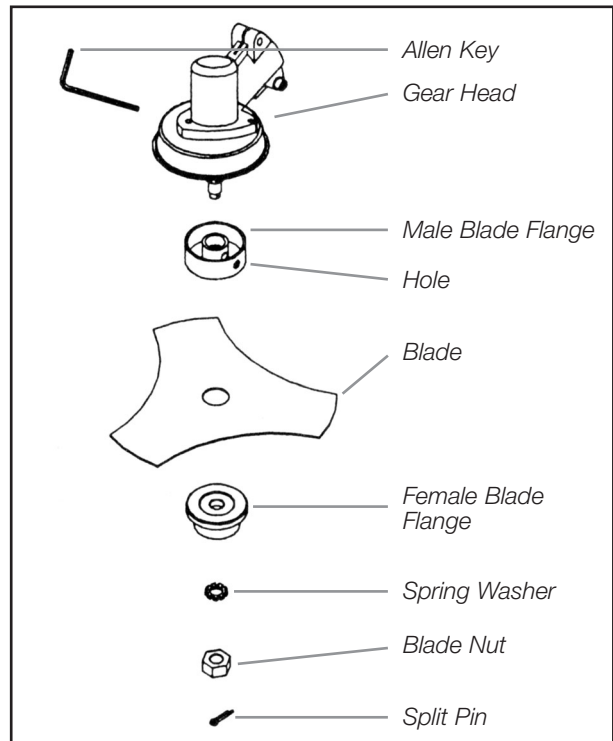

Fig. 6

1. Align the hole in the gear head with the slot in the male blade flange and insert the 4mm Allen key to prevent the gear head from rotating.
2. Unscrew the female blade flange completely, also removing the spring washer, blade nut, and split pin.
3. Install the brushcutting blade, then reassemble the female blade flange and spring washer in this order onto the gear shaft.
4. Attach the blade nut with the spark plug wrench in a counter clockwise direction until securely tightened.
5. Insert the split pin through the locking hole and once through pull the pins apart to lock in place.
6. Remove Allen key.



WARNING:

If there is excessive vibration after installing the blade, stop the engine immediately. Excessive vibration of blade means that it is not properly installed. Check the blade, retighten or reinstall as required.

Assembly – continued

Installing the Ezy Load Line Trimmer Head

Line Trimmer – Model No. 101PLT25D
See Fig. 7

Follow these steps to attach the Ezy Load Line Trimmer Head Assembly.

1. Place the Ezy Load Line Trimmer Head onto the threaded drive shaft.
2. Ensure that the recessed side of the disc will be facing the ground when in use.
3. Attach nut and tighten securely with the spanner provided.

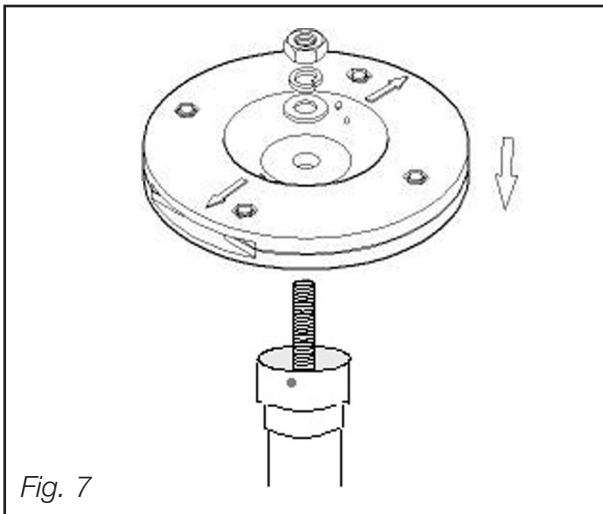

Adding Cutting Line to the Ezy Load Line Trimmer Head Assembly

Line Trimmer – Model No. 101PLT25D
See Fig. 8

NOTE: Only use line trimmer string between 2.4mm and 2.5mm thick.

Follow these steps to add cutting line to the Ezy Load Line Trimmer Head.

1. Cut a length of cutting line measuring approximately 44cm long.
2. Tie a knot in the middle of the line and thread one side from the inside of the Ezy Load Cutting Head to the outside.
3. Repeat for the other side that the knot is in the middle of the Ezy Load Line Trimmer Head.
4. If the line is too long for the cutting width of the trimmer, the blade cutter on the safety guard will automatically cut it down to the correct size.

NOTE: The Ezy Load Line Trimmer Head can be easily rethreaded while still attached to the Line Trimmer. However, ensure that the engine is switched off before rethreading. Failure to switch off engine could result in serious injury if the trimmer head starts to rotate.

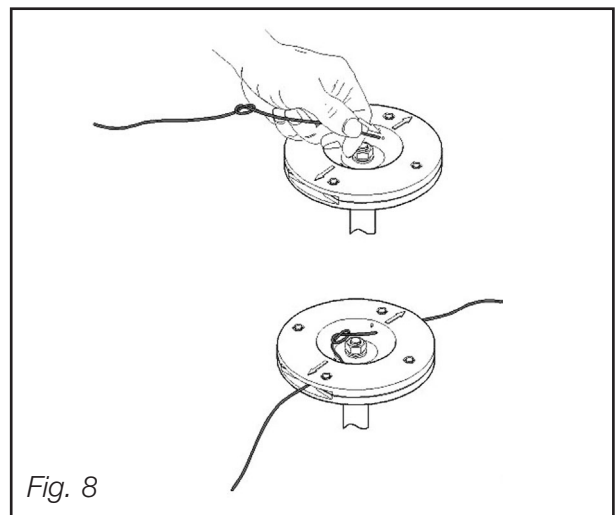

Assembly – continued

Attaching the Grass Deflector Guard



WARNING:

The line cutting blade on the grass deflector guard is sharp. Avoid contact with the blade. Failure to avoid contact can result in serious personal injury.

NOTE: To protect the operator, always be sure to attach the grass deflector.

To attach the Curved Shaft Grass Deflector Guard to the Line Trimmer

Model Nos. 101PLT25 and 101PLT25D

See Fig. 9

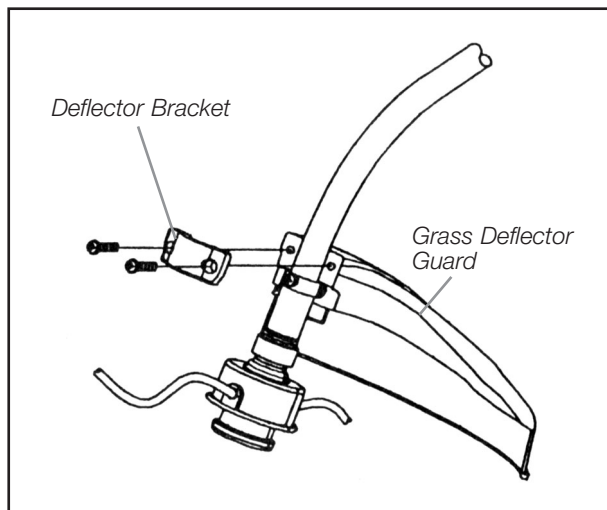

Fig. 9

Follow these steps to attach the curved shaft grass deflector guard:

1. Position the grass deflector guard onto the bottom of the curved shaft as shown.
2. Place the deflector bracket on the top of the shaft.
3. Place the flat washer and locking washer on the fixing screw.
4. Insert the fixing screw into the deflector bracket and tighten. Repeat for other side.

To attach the Straight Shaft Grass Deflector Guard

Model Nos. 101PBC33, 101PBC33BH and 101PLT25SS

See Fig. 10

Follow these steps to attach the straight shaft grass deflector guard.

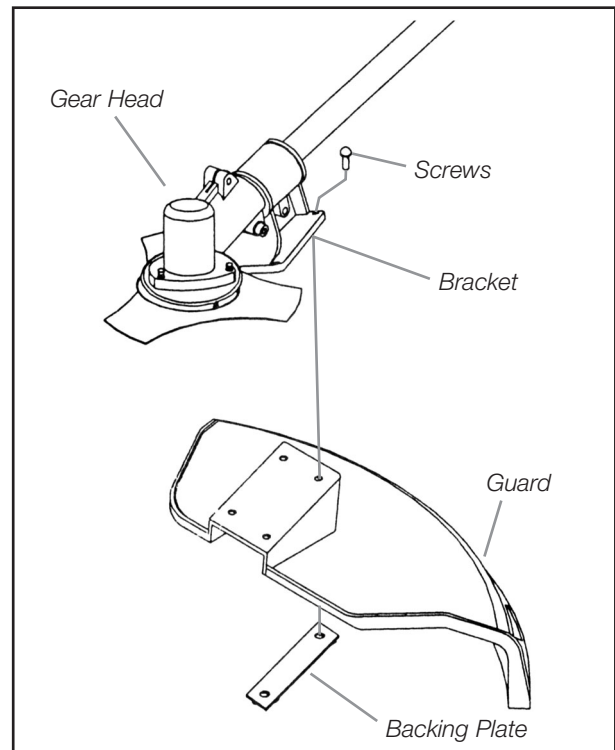

Fig. 10

1. Unscrew the screws from the backing plates on the grass deflector guard.
2. Position the grass deflector onto the bracket at the base of the shaft as shown.
3. Insert the washers, locking washers and the screws through the bracket, then through the grass deflector.
4. Align the backing plate on the under side of the deflector guard and use the screwdriver to securely tighten together.
5. Repeat for the other side of the grass deflector.
6. Ensure the grass deflector guard is securely attached.

Operation

Mixing the fuel



DANGER:

Petrol is extremely flammable and explosive. A fire or explosion from petrol will burn you and others.

This product is powered by a 2 stroke engine and requires pre-mixing petrol and 2 stroke oil. The oil mix should be 25:1. Never mix petrol and oil directly in the engine tank.

Use unleaded petrol intended for motor vehicle use with an Octane rating of 87 ([R + M] / 2) or higher. Purchase fuel from a reputable fuel supplier.

Use the mixing container provided to mix the oil and petrol in the correct quantities.

Petrol	Oil
1 litre	40ml
2 litres	80ml
3 litres	120ml
4 litres	160ml
5 litres	200ml

Mix only enough fuel for your immediate needs. Fuel should not be stored for more than 30 days.

Follow these steps to mix the fuel:

1. Use the container provided for mixing fuel.
2. Mix the 2 stroke engine oil with unleaded petrol in the container provided at the rate of 25 parts petrol to 1 part oil.
3. Mix the fuel thoroughly and also each time before re-fuelling.
4. Mix in small quantities. Do not mix more fuel than you expect to use within a 30 day period.
5. Store fuel only in a clean, safe, approved container for petrol – not the fuel mixing bottle provided.



Filling the Tank



WARNING:

Always stop the engine before filling the tank. Never add fuel to a machine with a running or hot engine. Move at least 9m away from the refuelling site before starting the engine. Do not smoke while filling the tank. Do not add fuel to the tank close to an open fire or sparks. Never add fuel to the tank in a closed or non-ventilated area.

Follow these steps to fill the tank:

1. Clean the surface around the fuel tank to prevent contamination.
2. Loosen the fuel cap by turning it counter clockwise.
3. Pour the fuel mixture carefully into the tank.
4. Clean and inspect the gasket.
NOTE: Replace the fuel cap if the gasket is damaged.
5. Install the fuel cap and tighten it by turning it clockwise.



WARNING:

Check for fuel leaks. If you find any leaks, correct the problem before using the product.

6. Wipe spilled fuel from the product.
7. Move at least 9 metres away before starting the product.

NOTE: It is normal for the engine to emit smoke during use.

Operation – continued

Starting the Product

Starting the product depends on whether the engine is cold or warm.



WARNING:

The recoil starter can be damaged by abuse.

Never pull the starter cord to its full length.

Always engage the starter before cranking the engine.

Always rewind the starter cord slowly.



CAUTION:

Operating the machine with loose, missing or damaged components could allow the engine to over-speed, possibly causing serious engine damage.

Inspect the entire machine for damaged, loose or missing components or fastenings and repair as necessary.

To Start a Cold Engine

See Fig. 11

Follow these steps to start a cold engine:

1. Lay the product on a flat bare surface.
2. Slide the switch to ON, by pushing the switch toward the end of the shaft (away from the STOP position).

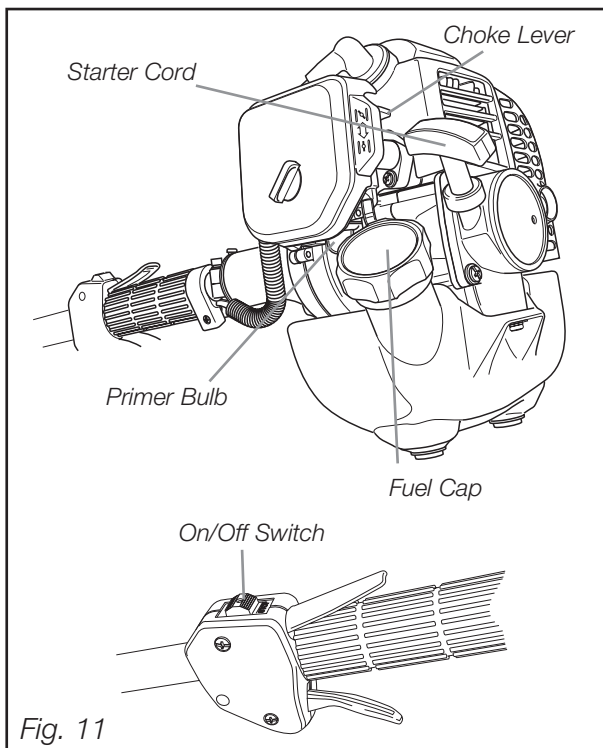



Fig. 11

3. Push the primer bulb repeatedly until fuel comes into the primer pump. For new engines or engines that have been refueled this may require numerous attempts.
4. Slide the choke lever up to the position marked  (choke is closed).
5. Holding the machine handle firmly with your right hand, pull the starter cord slowly until you feel the starter engage.
6. Start the machine by pulling the starter cord upward rapidly. If necessary, repeat step 5 two or three times until the engine starts.
7. Push choke lever down. Excessive cranking of the choke lever will cause the engine to flood making it difficult to start.
8. If the engine starts but does not run, open choke and continue to crank engine.

NOTE: When starting the engine for the first time, or after refueling, it may take longer for the fuel to reach the engine and become operational. You may need to repeat the steps several times in order to start the engine. If the engine will not start after repeated attempts, you should open the throttle and choke fully, and continue pulling the starter cord until the motor starts, making sure there is no danger of persons approaching the head while starting.

NOTE: If the product starts, let it run for 30 seconds before using it. If the product does not start, repeat the previous steps.

Operation – *continued*

IMPORTANT: For maximum performance and operating life, allow engine to warm before use.

1. Run the engine at idle speed until operating temperature is reached (2-3 minutes).
2. As the engine warms, open choke gradually by slowly sliding the choke control down.
3. The machine should now be ready for use.

To start a warm engine:

Follow these steps to start a warm engine.

1. Lay the product on a flat, bare surface.
2. Slide the switch to the ON position.
3. Push the primer bulb up to eight times.
4. Pull the starter cord.

NOTE: If the product does not start, repeat the previous steps. Check that the fuel tank has sufficient fuel for the engine to start.

Starting a Flooded Engine

1. Disconnect the spark plug boot and use the spark plug wrench supplied to remove the plug in a counter-clockwise direction.
2. If the spark plug is fouled or is soaked with fuel, clean or replace the plug as required.
3. Turn the product so that the spark plug hole is aimed at the ground.
4. Clear excess fuel from the combustion chamber by cranking the engine several times while the spark plug is removed.
5. Install the spark plug and firmly tighten it with the spark plug wrench supplied. **DO NOT OVERTIGHTEN.**
6. Reconnect the spark plug boot.



WARNING:

Incorrect spark plug installation can result in serious engine damage.

Stopping the Engine

1. Cool the engine by allowing it to run at idle for 2-3 minutes.
2. Slide the ON/OFF switch to the Off position.

Operation – continued

Operating the Line Trimmer

See Fig. 12

Follow these steps to operate the line trimmer:



Fig. 12

1. Start the trimmer.
2. Hold the trimmer at waist level with your right hand on the trigger handle and your left hand on the front handle.
3. Place the product on the right side of your body with the engine behind and away from your body.
4. Depress the throttle to engage the line trimmer head.
5. Trim grass and weeds in a right-to-left motion with the line parallel to the ground.

To Advance the Cutting Line on a Bump Feed Spool

See Fig. 13

Follow these steps to advance the cutting line:

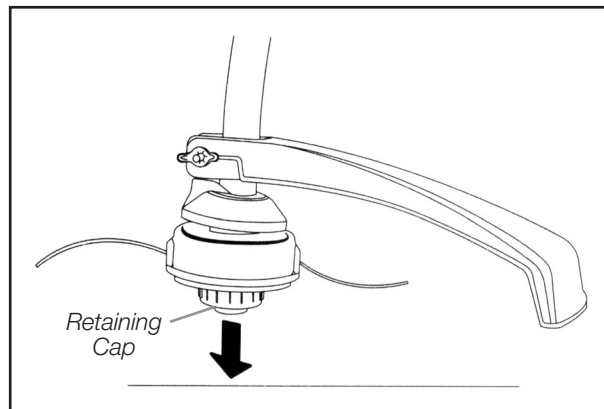

Fig. 13

1. Start the trimmer.
2. Depress the throttle to engage the line trimmer head.
3. Tap the retaining cap lightly on the ground while the motor is running. The line will only advance with the engine at full throttle.
Do not hold the retaining cap on the ground.

NOTE: The line cutting blade on the grass deflector will cut the line to the proper length.

NOTE: To help prevent line tangle, tap only once to lengthen the line. If additional line is required, wait a few seconds before re-tapping the retaining cap. Do not allow the line to wear too short. Keep the cutting line at full length.

Operation – continued

Operating the Brushcutter

Model Nos. 101PBC33, 101PBC33BH
and 101PLT25SS

See Fig. 14

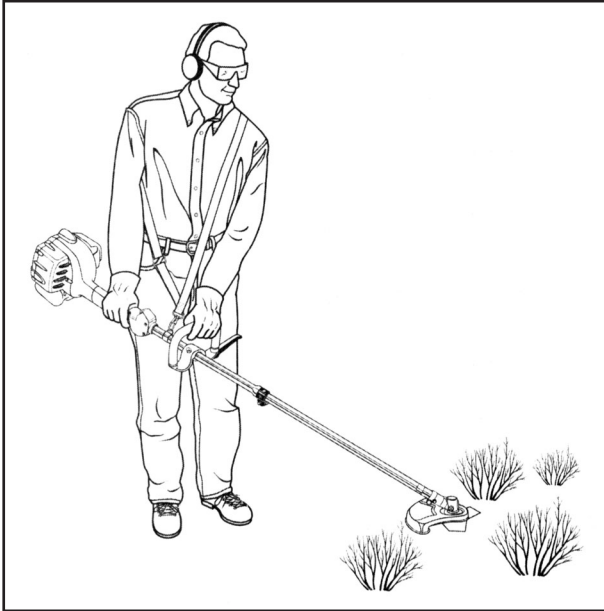

Fig. 14



WARNING:

Ensure the blade guard is removed prior to starting the engine. Failure to remove the blade guard could cause the blade guard to detach from the blade and cause injury.



WARNING:

Do not cut with a dull, cracked or damaged metal blade. Before cutting growth, inspect for obstructions such as rocks, metal stakes or strands of wire from fences. If an obstruction cannot be removed, mark its location so that you can avoid it with the blade. Wires can catch on the blade head and be thrown in the air.

WARNING



DANGER

DO NOT TOUCH THESE TYPES OF OBJECTS WITH THE BLADE

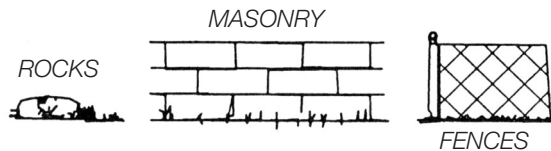
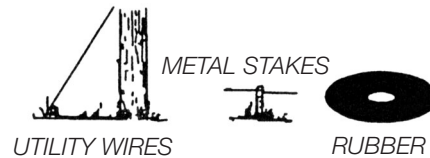

Follow these steps to operate the brushcutter:

1. Remove blade guard from the blade.
2. Start the brushcutter.
3. Hold the brushcutter at waist level with your right hand (arm extended) on the trigger handle and your left hand on the front handle.
4. Place the product on the right side of your body with the engine behind and away from your body.
5. Brushcut weeds and vines in a right-to-left motion with the blade parallel to the ground.

Operation – continued

Installing the Blade Guard

Model Nos. 101PBC33. 101PBC33BH
and 101PLT25SS

See Fig. 15

Follow these steps to install the blade guard on to the blade.

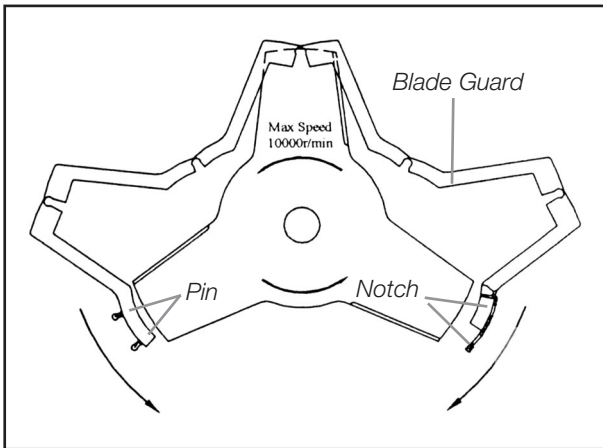

Fig. 15

1. Stop the brushcutter.
2. Remove the spark plug boot.
3. Fit blade guard around the outside of the blade, taking care not to handle the blade directly.
4. Ensure that each blade is covered by the guard.
5. Connect the two ends together by locking the pins into the notches of the blade guard.



CAUTION:

When not in use, or when transporting the product as a brushcutter you should always ensure the blade guard is in place. Failure to do so this may result in damage to the blade or personal injury.

Maintenance

Emissions Maintenance Schedule

Maintenance, replacement or repair of the emission control device and systems may be performed by any authorised Toro or Pope Service Dealer.



WARNING:

Before performing any maintenance on this machine, stop the engine and disconnect the spark plug.

Emission Part	Inspect before each use	Every 10 hours	Every 10 - 15 hours or yearly
Fuel Tank Assembly (includes Fuel Lines, Fuel Cap and Fuel Filter)	X		
Clean Air Filter		X	X
Replace Spark Plug			X



WARNING:

When replacing parts other than engine or emissions parts, use only Pope replacement parts. Use of any other parts may create a hazard or cause product damage.

Maintenance – continued

BEFORE EACH USE:

- Remove dirt and debris from the product exterior.
- Inspect the engine, tank and hoses for possible fuel leaks and repair as necessary.
- Inspect the engine cooling fins for accumulation of debris and clean as necessary.
- Inspect the entire machine for damage, loose and missing components or fasteners and repair as necessary.

CLEANING THE PRODUCT:

- Stop the product before cleaning.
- Clean the exterior of the product with a damp cloth.
- Avoid using solvents when cleaning plastic parts. Most plastics are susceptible to damage from various types of commercial solvents and may be damaged by their use.
- Scrape debris away from air intake vents on both sides of the motor housing.



CAUTION:

Keeping air intake vents free of grass and debris prevents motor overheating and possible failure.

NOTE: Depending on the type of fuel used, the type and amount of oil used, and/or your operating conditions, the exhaust port and muffler may become blocked with carbon deposits. If you notice a power loss with your petrol powered tool, you may need to remove these deposits to restore performance. We highly recommend that only qualified service technicians perform this service.

Replacing the Cutting Line

See Fig. 16



WARNING:

Use of line other than the proper monofilament cutting line could cause personal injury.

Follow these steps to replace the cutting line:

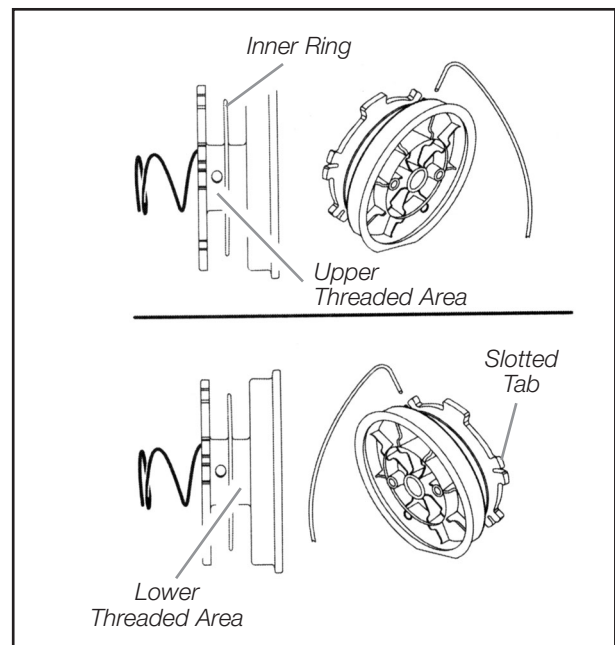

Fig. 16

1. Stop the trimmer.



WARNING:

Make sure the trimmer head stops rotating. Contact with a rotating trimmer head could cause personal injury.

Maintenance – continued

2. Remove the spark plug boot.
3. Remove the retaining cap by turning counter clockwise.
4. Remove the spring.
5. Remove the empty spool.
6. Cut 2 lengths of cutting line, approximately 180cm each length.
7. Insert the end of the new line into the hole in the upper threaded area of the spool.
NOTE: If the line does not fit into the hole, see recommendation for minimum and maximum line thickness.
8. Once inserted through the hole, the line must double back on itself.
9. Wind the line around the spool as indicated by the arrows on the top of the spool until the line reaches the edge of the spool.
Do not wind the line beyond the edge of the inner ring.
10. Secure the line temporarily by pushing it into one of the slotted tabs on the spool.
11. Repeat the process for the lower threaded area of the spool, winding the line and securing it in the slotted tab opposite the first secured line. **NOTE:** Cutting line winds in the same direction.
12. Insert the lines into the eyelets on the trimmer head.
13. Reinstall the spring.
14. Place the spool firmly on the drive shaft.
NOTE: To install the spool, you may need to rotate it slightly. If the line should tangle or break at the eyelet, remove the spool, re-feed the line through the eyelets and reassemble the spool on the trimmer.
15. Release the lines from the tabs by sharply pulling each line.
16. Push down on the spool to reveal the threads inside the drive shaft.
17. Thread the retaining cap on the drive shaft.
18. Secure the retaining cap.
19. Replace the spark plug boot.



WARNING:

An improperly installed retaining cap or spool could fly off the trimmer. Contact with a thrown retaining cap or spool could cause personal injury.

Cleaning the Air Filter

See Fig. 17

Follow these steps to clean the air filter.

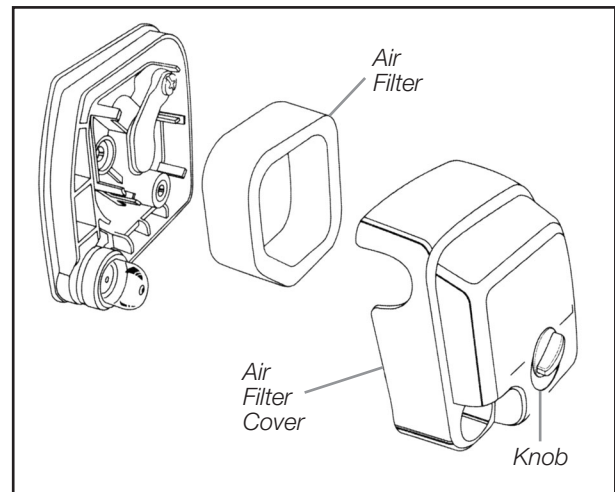

Fig. 17

1. Stop the engine.
2. Remove the spark plug boot.
3. Loosen the air cleaner cover by turning the knob counter clockwise.
4. Remove the air filter cover.
5. Remove the air filter element.
6. Inspect the element. If the element is distorted or damaged replace it with a new one.
7. Wash the element in clean fuel and squeeze or blow dry.
8. Wash the air cleaner in clean fuel and wipe or blow dry.
9. Rinse the air filter and let it dry completely.
10. Work two drops of oil into the air filter.
11. Replace the air filter (fits only one way).
12. Replace the air filter cover.
13. Tighten the air filter cover by turning the knob clockwise.
14. Replace the spark plug boot.

Maintenance – *continued* & Storing the Product

Replacing the Spark Plug

NOTE: Before removing the spark plug, thoroughly clean the spark plug and cylinder head area.

Model Nos. 101PLT25, 101PLT25D and 101PLT25SS use a NGK BPMR7A spark plug.

Model Nos. 101PBC33 and 101PBC33BH use a NGK BPMR6A spark plug. Use an exact replacement and replace annually.

Follow these steps to replace the spark plug.

1. Ensure the engine is cool before servicing the spark plug.
2. Remove the spark plug boot.
3. Loosen the spark plug by turning it counter clockwise with a socket.
4. Remove the spark plug.
5. Hand thread the new spark plug, turning it clockwise. **Do not over tighten.**



CAUTION:

Be careful not to cross-thread the spark plug. Cross threading will seriously damage the product.

Storing the Product

Storing the product differs depending on the amount of time it will be in storage.

To Store the Product Short Term

Follow these steps to store the product short term.

1. Clean all foreign material from the product.
2. Store in a well-ventilated place that is inaccessible to children.

To Store the Product Long Term (more than 30 days)



CAUTION:

Never store this product with any fuel remaining in the tank, fuel lines or carburettor. Your warranty does not include coverage for damage covered by stale or contaminated fuels.

If you do not intend to use the product for more than one month, follow these steps to store the product long term.

1. Drain all of the fuel from the tank into a container approved for petrol.
2. Run the engine until it stops.
3. Clean all foreign materials from the product.
4. Remove the spark plug boot, and then the spark plug.
5. Pour approximately 5ml oil into the cylinder through the spark plug hole.
6. Pull the recoil starter 2 or 3 times to distribute the oil over the cylinder walls.
7. Reinstall the spark plug. Follow the instructions for spark plug replacement.
8. Reconnect the spark plug boot.
9. Store the product in a well-ventilated place that is inaccessible to children.

NOTE: Keep the product away from corrosive agents such as garden chemicals.

IMPORTANT: Abide by all federal and local regulations for the safe storage, handling and disposal of petrol.

Troubleshooting:

Problem	Possible Cause	Solution
Engine will not start	<ol style="list-style-type: none"> 1. Switch set to OFF position. 2. No spark. 3. No fuel. 4. Flooded engine. 5. Starter cord pulls harder now than when new. 	<ol style="list-style-type: none"> 1. Set switch to the ON position. 2. Remove the spark plug. Re-attach the spark plug and lay the spark plug on the metal cylinder. Pull the starter cord and watch for a spark at the spark plug tip. If there is no spark, repeat the test with a new spark plug. 3. Push primer bulb until the bulb is full of fuel. If the bulb does not fill, the primary fuel delivery system is blocked. If the primer bulb fills, the engine may be flooded. (See next item.) 4. Remove the spark plug. Turn the product so that the spark plug hole is aimed at the ground. Make sure the choke lever is open and pull the starter cord 10 to 14 times. This clears excess fuel from the engine. Clean and re-install the spark plug. With the trigger fully depressed, pull the starter cord 3 times. If the engine does not start, set the choke lever to closed and follow normal starting instructions. If the engine still fails to start, repeat the procedure with a new spark plug. 5. Contact an authorised service dealer.
Engine does not reach full speed	<ol style="list-style-type: none"> 1. Check oil fuel mixture. 2. Air filter is dirty. 3. Spark arrestor screen is dirty. 	<ol style="list-style-type: none"> 1. Use fresh fuel and the correct 2 stroke oil mix. 2. Clear the air filter. 3. Clean the spark plug arrestor.
Line will not advance when using automatic line lengthening	<ol style="list-style-type: none"> 1. Line welded to itself. 2. Not enough line on the spool. 3. Line worn too short. 4. Line tangled on spool. 5. Engine speed too slow. 	<ol style="list-style-type: none"> 1. Lubricate with silicone spray. 2. Install more line. 3. Pull line while alternately pressing down on and releasing the retaining cap. 4. Remove line from spool and rewind. 5. Advance line at full throttle.
Retaining cap hard to turn when using automatic line lengthening	Screw threads are dirty or damaged.	Clean the threads and lubricate with grease. If this does not solve the problem, replace the retaining cap.
Grass wraps around the trimmer head assembly and the attachment shaft	<ol style="list-style-type: none"> 1. Cutting tall grass at ground level. 2. Operating the product at part throttle. 	<ol style="list-style-type: none"> 1. Cut tall grass from the top down. 2. Operate the product at full throttle.
Oil drips from muffler	<ol style="list-style-type: none"> 1. Operating the product at part throttle. 2. Check oil/fuel mixture. 3. Air filter is dirty. 	<ol style="list-style-type: none"> 1. Operate the product at full throttle. 2. Use fresh fuel and the correct 2 stroke oil mix. 3. Clean the air filter.

Warranty

Petrol Operated Products Limited Warranty

Pope warrants to the original retail purchaser that this Petrol Powered Product is free from defects in material and workmanship and agrees to repair or replace, at our option, any defective Product free of charge within these time periods from the date of purchase:

- Two years for Petrol Powered Trimmer, Brushcutter and Blower Vacuum Products, if the Product is used for personal, family, or household use;
- 90 days if the Petrol Powered Trimmer, Brushcutter and Blower Vacuum Products are used for any other purpose, such as commercial or rental.

Instructions for Obtaining Warranty Service

Any part of the Pope Product found in the reasonable judgement of Toro Australia Pty Limited to be defective in material or workmanship will be repaired or replaced by an Authorised Service Dealer for this product without charge for parts or labour. To locate your nearest authorised service dealer, refer to the list on the back page of this manual, check the website, or phone 1300 134 880.

The Product, including any defective part must be returned to an Authorised Service Dealer for this product within the warranty period. The expense of delivering the product to the Authorised Service Dealer for warranty work and the expense of returning it back to the owner after repair or replacement will be paid for by the owner.

Proof of purchase will be required by the dealer to substantiate any warranty claim. All warranty work must be performed by a Service Dealer authorised by Toro Australia Pty Limited to service this product.

The warranty does not cover any product that has been subject to misuse, neglect, negligence or accident or that has been operated in any way contrary to the operating instructions as specified in the Operator's Manual. This warranty does not apply to any damage to the Product that is the result of improper maintenance or to any Product that has been altered or modified so as to adversely affect the product's operation, performance or durability or that has been altered or modified so as to change its intended use. The warranty does not extend to repairs made necessary by normal wear, misuse or by the use of parts or accessories which are either incompatible with the product or adversely affect its operation, performance or durability.

Toro Australia Pty Limited reserves the right to change or improve the design of any Petrol Product without assuming any obligations to modify any product previously manufactured.

ALL IMPLIED WARRANTIES ARE LIMITED TO THE DURATION OF THE STATED WARRANTY PERIOD. ACCORDINGLY, ANY SUCH IMPLIED WARRANTIES INCLUDING MERCHANTABILITY, FITNESS FOR A PARTICULAR PURPOSE, OR OTHERWISE, ARE DISCLAIMED IN THEIR ENTIRETY AFTER THE EXPIRATION OF THE APPROPRIATE TWO-YEAR OR NINETY DAY WARRANTY PERIOD. TORO AUSTRALIA PTY LIMITED'S OBLIGATION UNDER THIS WARRANTY IS STRICTLY AND EXCLUSIVELY LIMITED TO THE REPAIR AND REPLACEMENT OF DEFECTIVE PARTS AND TORO AUSTRALIA PTY LIMITED DOES NOT ASSUME OR AUTHORISE ANYONE TO ASSUME FOR THEM ANY OTHER OBLIGATION. TORO AUSTRALIA PTY LIMITED ASSUMES NO RESPONSIBILITY FOR INCIDENTAL, CONSEQUENTIAL OR OTHER DAMAGES INCLUDING, BUT NOT LIMITED TO EXPENSE OF RETURNING THE PETROL POWERED PRODUCT TO AN AUTHORISED SERVICE DEALER AND EXPENSE OF DELIVERING IT BACK TO THE OWNER, MECHANIC'S TRAVEL TIME TELEPHONE OR TELEGRAM CHARGES, RENTAL OF A LIKE PRODUCT DURING THE TIME WARRANTY SERVICE IS BEING PERFORMED, TRAVEL, LOSS OR DAMAGE TO PERSONAL PROPERTY, LOSS OF REVENUE, LOSS OF USE OF THE PRODUCT, LOSS OF TIME OR INCONVENIENCE.

The above warranty does not exclude any condition or warranty implied by the Trade Practices Act 1974 or any other relevant legislation which implies any condition which cannot be excluded.

Authorised Pope Service Dealers

AUST. CAPITAL TERRITORY

Mitchell Lawnmower
Centre
MITCHELL
(02) 6241 4806

NEW SOUTH WALES

Agrifarm Implements
TAREE
(02) 6552 6888

Agrimow
COFFS HARBOUR
(02) 6652 9893

Barry Austin Mowers
FORSTER
(02) 6554 6935

Bega Farm Supplies
BEGA
(02) 6492 4466

Bike and Power
DURAL
(02) 9651 7170

Bill's Mudgee Chainsaw
Centre
MUDGEE
(02) 6372 4122

Bridge Mower &
Chainsaw Centre
EAST GOSFORD
(02) 4325 2107

Central West Mowers
& Chainsaws
ORANGE
(02) 6362 0681

Cooma Power
Equipment
COOMA
(02) 6452 2622

Dawmac Industries
BERRIGAN
(03) 5885 2382

Deni Bike & Boat
DENILIQUIN
(03) 5881 5255

Dubbo Mowers &
Chainsaws
DUBBO
(02) 6882 3122/
(02) 6882 9499

Farm Moto
LISMORE
(02) 6622 3999

Grafton Power Products
GRAFTON
(02) 6642 2880

Harvey's Mower Centre
WAGGA WAGGA
(02) 6925 2234

J & P Motorcycles
GRIFFITH
(02) 6964 2422

Keith Simmons
Engineering
YOUNG
(02) 6382 3999

Ken Mathews Mower
& Auto Centre
ULLADULLA
(02) 4455 1645

LW Burgess Pty Ltd
ARMIDALE
(02) 6772 2227

Lawnpower Pty Ltd
NOWRA
(02) 4421 4466

Macarthur Mowers
CAMDEN
(02) 4655 7793/ (02) 4655 6242

Moruya Mower &
Chainsaw Centre
MORUYA
(02) 4474 3322

Mower World
WAUCHOPE
(02) 6585 2053

Newcastle Chainsaws
ISLINGTON
(02) 4961 1332

Newcastle Chainsaws
RAYMOND TERRACE
(02) 4987 3837

Ranger Geale Enterprises
GOULBURN
(02) 4821 4266

S&T Haddad Mowers
MOREE
(02) 6752 4906

Scone Outdoors
SCONE
(02) 6545 3033

Small Engine Services
GLEN INNIS
(02) 6732 1441

Tamworth Small Engines
TAMWORTH
(02) 6765 9737

The Irrigation Specialists
LEETON
(02) 6953 6700

The Mowers Warehouse
LITHGOW
(02) 6351 4008

Tinks
MACKSVILLE
(02) 6568 2344

Town & Country Water Shop
BATHURST
(02) 6331 9622

WH Ireland & Sons
MITTAGONG
(02) 4872 1999

Welvin Mower & Gas
NTH RICHMOND
(02) 4571 1662

NORTHERN TERRITORY

Winnellie Mower Repairs
WINNELLIE
(08) 8984 4529

QUEENSLAND

Aussie Mower Centre
HERVEY BAY
(07) 4125 3152

Boat or Mowers
GLADSTONE
(07) 4972 0135

Braschs Pty Ltd
CAIRNS
(07) 4051 1411

Casali's
MAREEBA
(07) 4092 3841

David Evans Group
GATTON
(07) 5462 1266

David Evans Group
BILOELA
(07) 4992 1099

Dover & Sons
BEAUDESERT
(07) 5541 1977

Dover & Sons
BOONAH
(07) 5463 1388

Downs Mower Centre
TOOWOOMBA
(07) 4632 4000

Mower World
OXENFORD
(07) 5573 4388

Jackson's Mower Centre
MACKAY
(07) 4957 5450

Kel's Chainsaws &
Small Motors
EMERALD
(07) 4982 4701

Keppel Outdoor Products
YEPPON
(07) 4925 0600

Mudgeeraba Mower
Centre
MUDGEERABA
(07) 5530 4477

Nanango Motors
NANANGO
(07) 4163 1108

Nowa Power Products
BUNDEBERG
(07) 4153 1722

Rimrock Agencies
ROCKHAMPTON
(07) 4927 7033

Schilling Small Engines
MARYBOROUGH
(07) 4123 2833

Southside Small Engines
CAPALABA
(07) 3245 6011

Southwest Pumps,
Solar & Small Engines.
ROMA
(07) 4622 4528

Sunstate AG
DALBY
(07) 4672 3333

The Big Mower
BEERWAH
(07) 5494 6151

The Mower Place
BROWNS PLAINS
(07) 3800 4433

The Mower Supastore
BRENDALE
(07) 3205 1299

The Mower Warehouse
CABOOLTURE
(07) 5495 8822

The Watershed
INNISFAIL
(07) 4061 6177

Vic's Mowers &
Small Engines
MOSSMAN
(07) 4098 1600

Warwick Westside
Chainsaws & Mowers
WARWICK
(07) 4661 2032

Warwick Westside
Chainsaws & Mowers
WARWICK
(07) 4661 2032

SOUTH AUSTRALIA

Mower Plus
SALISBURY SOUTH
(08) 8250 5666

Oaklands Road Mower
Centre
SOMERTON PARK
(08) 8294 9799

Peter Jennings Pumps
MT GAMBIER
(08) 8725 0722

TASMANIA

Central Coast Mower
Market
WEST ULVERSTONE
(03) 6425 3318

Eastern Shore Mowers
& Cycles
LINDISFARINE
(03) 6243 7776

Pellows Saws & Mowers
INVERMAY
(03) 6326 5722

Pellows Saws & Mowers
DEVONPORT
(03) 6424 8364

VICTORIA

Alphine Mowers
MONBULK
(03) 9752 0488

Bendigo Mower Service
BENDIGO
(03) 5443 5242

Benalla Chainsaws
BENALLA
(03) 5762 6177

Black's Machinery
NAGAMBIE
(03) 5794 2534

Bob Crosby & Co.
WODONGA
(02) 6024 1333

Bolton Motorcycles &
Power Equipment
KYNETON
(03) 5422 2255

Central Gippsland
Mowers & Chainsaws
MORWELL
(03) 5134 8899

Dawn Mowers
SURREY HILLS
(03) 9830 5444

Drouin Mowers &
Chainsaws
DROUIN
(03) 5625 1079

Gendore Leongatha
LEONGATHA
(03) 5662 4044

Gendore
TOORADIN
(03) 5998 3216

Gisborne Power
Products
GISBORNE
(03) 5428 8844

Hastings Mowers
HASTINGS
(03) 5979 1382

Henderson Mowers
BALLARAT
(03) 5331 1618

JR's Mowers & Chainsaws
BAIRNSDALE
(03) 5152 3202

Magic Mowers
MILDURA
(03) 5022 7088

Mariot's Motor Cycles
& Equip P/L
LEONGATHA
(03) 5662 2028

Molin Motorcycles &
Marine
KOONDRUCK
(03) 5451 1500

Morrington Mowers
MORNINGTON
(03) 5977 1488

Mortons Machinery
RINGWOOD
(03) 9870 7133

Mower Corner
COLAC
(03) 5231 5022

Mowers Galore
NORTH GEELONG
(03) 5272 1066

Mowers Galore
GROVEDALE
(03) 5244 0620

Philip Russell
Motorcycles
WARRNAMBOOL
(03) 5562 0222

Powerquip Mower &
Chainsaw Centre
DOVETON
(03) 9793 3177

Powerquip Mower &
Chainsaw Centre
HALLAM
(03) 9796 5045/
(03) 9796 3687

Roy Hill Motors
SHEPPARTON
(03) 5821 8877

Stihl Echuca Sales &
Service
ECHUCA
(03) 5480 9566

Stihl Shop Seymour
SEYMOUR
(03) 5799 1215

T&I Horticulture
SWAN HILL
(03) 5032 4555

Vin Rowe Farm Machinery
WARRAGUL
(03) 5623 1362

Yarra Glen Mower Centre
YARRA GLEN
(03) 9730 1988

WESTERN AUSTRALIA

Busselton Mower World
BUSSELTON
(08) 9754 1969

Cloverdale Hardware
CLOVERDALE
(08) 9479 4383

Eastern Hills Saws &
Mowers
MUNDARING
(08) 9295 2466

Geraldton Mower Repairs
GERALDTON
(08) 9964 4036

Star Sales & Service
ALBANY
(08) 9842 2455